

# PLAT OF SURVEY

**DESCRIPTION PROVIDED:**

Property described in Document Number 688628, Grant County Registry and being described as follows:

A parcel of land in Jamestown Township, Grant County, Wisconsin, in Section number eight (8), T1N, R2W commencing at the Southeast Corner of the Northeast Quarter of said Section number eight (8), T1N, R2W of the 4th P.M., the point of beginning of the tract hereby conveyed, thence West 100 feet, thence North 250 feet, thence East 100 feet and thence South 250 feet to the point of beginning.

**SURVEYOR'S CERTIFICATE:**

I, Aaron J. Austin, Professional Wisconsin Land Surveyor, hereby certify:

That the above description was surveyed, mapped and monumented as shown on this plat by me or under my direct supervision and field work was completed on 10-27-2023.

That this survey was prepared under the instructions of Mike Boge. That this survey complies with Chapter A-E 7 of the Wisconsin Administrative Code and to the best of my knowledge and belief, this plat is an accurate representation thereof.

Dated this 1st day of November, 2023.  
Revised this 19th day of December, 2023.

*AJA*  
*Aaron J Austin*  
Aaron J. Austin, S-2922  
Agent, Austin Surveying, LLC

That all plans that do not show a seal imprint in red ink may contain unauthorized alterations. The certification contained on this document shall not apply to any copies.

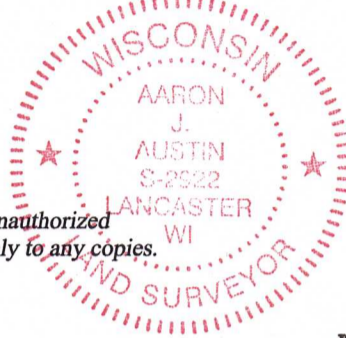

**LEGEND**

- ⊙ Section Corner
- 3/4" rebar found
- ▣ Septic tank
- ⊙ Septic vent
- ⊗ Well
- ⊕ Utility pole
- ⊞ Electric transformer
- ( ) Recorded as
- [ ] Property described in Document Number, Grant County Registry
- Boundary of Survey
- - - Section line
- - - Centerline
- - - Right of Way
- - - Previously surveyed line
- - - Existing Improvement
- ▤ Existing Structure

NORTHEAST ORNER  
SECTION 8, T1N R2W  
Aluminum Capped  
rebar and ties found.



2643.65'

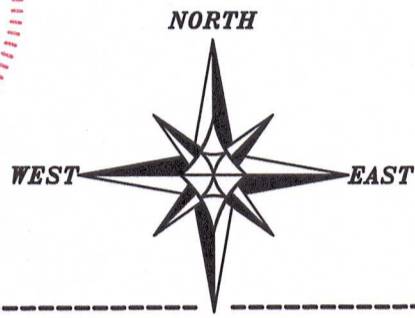

The East-West 1/4 line of Section 8 bears S 89°48'09" W according to the Grant County Coordinate System WISCORS NAD 83 (2011) which was determined by G.P.S. observation.

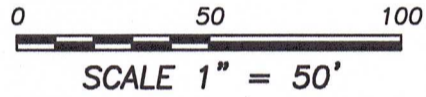

PARCEL "B"  
PREVIOUS SURVEY  
BY LARRY AUSTIN  
REVISED 2-16-1998  
BOOK: 2 PAGE: 27

[688628]  
PARCEL "A"  
PREVIOUS SURVEY  
BY LARRY AUSTIN  
REVISED 2-16-1998  
BOOK: 2 PAGE: 27  
0.57± ACRE  
25,000± SQ.FT.

CENTERLINE DRIVEWAY  
EASEMENT RECORDED IN [605026]

PREVIOUS SURVEY  
BY LARRY AUSTIN  
DATED 2-8-1999  
BOOK: 4, PAGE: 64

PLUM HOLLOW ROAD

PREVIOUS SURVEY  
BY LARRY AUSTIN  
DATED 11-25-1996  
BOOK: X, PAGE: 69

PREVIOUS SURVEY  
BOOK: GCA, PAGE: 877

WEST 1/4 CORNER  
SECTION 8, T1N R2W  
2" Iron Pipe and ties found.

EAST 1/4 CORNER  
SECTION 8, T1N R2W  
Aluminum Monument  
and ties found.

Prepared for: MIKE BOGE



**Austin Surveying, LLC**  
Land Surveying & Septic System Designs  
austinsurveyingllc.com Phone: 608-723-6363  
4211 HWY 81 E, LANCASTER, WI 53813

JOB NO: 23S196  
H:\CRD\23S196  
H:\PLAT\T1NR2W\08\23S196-BOGE

DRAWN BY: AJ AUSTIN  
CREW CHIEF: SHANE AUSTIN  
CREW: O. AUSTIN, T. AUSTIN

# PLAT OF SURVEY

**DESCRIPTION PROVIDED:**

Property described in Document Number 688628, Grant County Registry and being described as follows:

A parcel of land in Jamestown Township, Grant County, Wisconsin, in Section number eight (8), T1N, R2W commencing at the Southeast Corner of the Northeast Quarter of said Section number eight (8), T1N, R2W of the 4th P.M., the point of beginning of the tract hereby conveyed, thence West 100 feet, thence North 250 feet, thence East 100 feet and thence South 250 feet to the point of beginning.

**SURVEYOR'S CERTIFICATE:**

I, Aaron J. Austin, Professional Wisconsin Land Surveyor, hereby certify:

That the above description was surveyed, mapped and monumented as shown on this plat by me or under my direct supervision and field work was completed on 10-27-2023.

That this survey was prepared under the instructions of Mike Boge. That this survey complies with Chapter A-E 7 of the Wisconsin Administrative Code and to the best of my knowledge and belief, this plat is an accurate representation thereof.

Dated this 1st day of November, 2023.

*Aaron J. Austin*  
 Aaron J. Austin, S-2922  
 Agent, Austin Surveying, LLC

That all plans that do not show a seal imprint in red ink may contain unauthorized alterations. The certification contained on this document shall not apply to any copies.

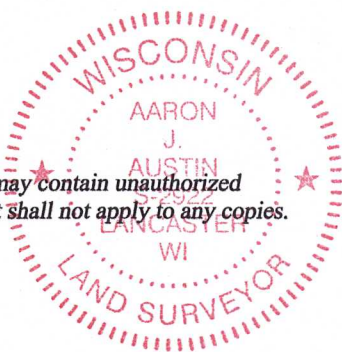

NORTHEAST ORNER  
 SECTION 9, T1N R2W  
 Aluminum Capped  
 rebar and ties found.

**LEGEND**

- ⊙ Section Corner
- 3/4" rebar found
- ▣ Septic tank
- ⊙ Septic vent
- ⊗ Well
- ⊕ Utility pole
- ⊞ Electric transformer
- ( ) Recorded as
- [ ] Property described in Document Number, Grant County Registry
- Boundary of Survey
- Section line
- Centerline
- - - Right of Way
- - - Previously surveyed line
- Existing Improvement
- ||||| Existing Structure

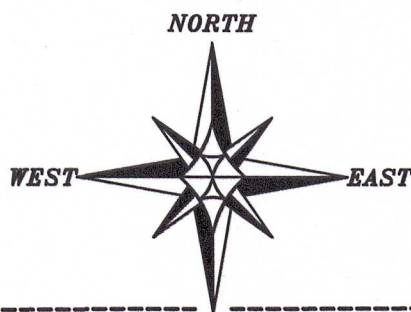

The East-West 1/4 line of Section 8 bears S 89°48'09" W according to the Grant County Coordinate System WISCORS NAD 83 (2011) which was determined by G.P.S. observation.

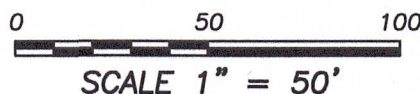

2643.65'

PARCEL "B"  
 PREVIOUS SURVEY  
 BY LARRY AUSTIN  
 REVISED 2-16-1998  
 BOOK: 2 PAGE: 27

[688628]  
 PARCEL "A"  
 PREVIOUS SURVEY  
 BY LARRY AUSTIN  
 REVISED 2-16-1998  
 BOOK: 2 PAGE: 27  
 0.57± ACRE  
 25,000± SQ.FT.

CENTERLINE DRIVEWAY  
 EASEMENT RECORDED IN [605026]

PREVIOUS SURVEY  
 BY LARRY AUSTIN  
 DATED 2-8-1999  
 BOOK: 4, PAGE: 64

**PLUM HOLLOW ROAD**

PREVIOUS SURVEY  
 BY LARRY AUSTIN  
 DATED 11-25-1996  
 BOOK: X, PAGE: 69

PREVIOUS SURVEY  
 BOOK: GCA, PAGE: 877

WEST 1/4 CORNER  
 SECTION 9, T1N R2W  
 2" Iron Pipe and ties found.

EAST 1/4 CORNER  
 SECTION 9, T1N R2W  
 Aluminum Monument  
 and ties found.

Prepared for: MIKE BOGE



**Austin Surveying, LLC**  
 Land Surveying & Septic System Designs  
 austinsurveyingllc.com Phone: 608-723-6363  
 4211 HWY 81 E, LANCASTER, WI 53813

JOB NO: 23S196  
 H:\CRD\23S196  
 H:\PLAT\T1NR2W\08\23S196-BOGE

DRAWN BY: AJ AUSTIN  
 CREW CHIEF: SHANE AUSTIN  
 CREW: O. AUSTIN, T. AUSTIN