

PLAT OF SURVEY

DESCRIPTION:

The South Half (S. 1/2) of Lot Nine (9) in Block Twenty-nine (29) of the Original Plat of the Village (now City) of Lancaster, Grant County, Wisconsin, according to the recorded plat thereof.

SURVEYOR'S CERTIFICATE:

I, Aaron J. Austin, Professional Wisconsin Land Surveyor, hereby certify:
That the above description was surveyed, mapped and monumented as shown on this plat by me or under my direct supervision and field work was completed on 5-22-2023.
That this survey was prepared under the instructions of Mic Dressler.
That this survey complies with Chapter A-E 7 of the Wisconsin Administrative Code and to the best of my knowledge and belief, this plat is an accurate representation thereof.
Dated this 25th day of May, 2023.

Aaron J. Austin
Aaron J. Austin, S-2922
Agent, Austin Engineering, LLC

That all plans that do not show a seal imprint in red ink may contain unauthorized alterations. The certification contained on this document shall not apply to any copies.

EAST 1/4 CORNER SECTION 3, T4N R3W Stone Monument and ties found

The East line of the SE 1/4 of Section 3 bears S 01°20'29" E according to the Grant County Coordinate System WISCONSIN NAD 83 (2011) which was determined by G.P.S. observation.

LOT 1 C.S.M. #1925

S 01°20'29" E

LEGEND

BLOCK 19

- ⊕ Section Corner
- 3/4" x 18" rebar set with cap
- ⊙ 1/2" x 4 3/4" Steel Gin Spike set
- 3/4" rebar found
- ⊗ Mag Nail found
- No monument set
- ⊖ Cleanout

- () Recorded as
- Boundary of Survey
- - - Section line
- - - Centerline
- - - Platted lot line
- - - Previously surveyed line
- ▨ Existing Structure
- ⋯ Existing Improvement
- ▬ Retaining Wall

CHERRY STREET

ADAMS STREET

CITY OF

ORIGINAL PLAT OF LANCASTER

JACKSON STREET

BLOCK 30

WALNUT STREET

PREVIOUS SURVEY BOOK: M, PAGE, 66

BLOCK 34

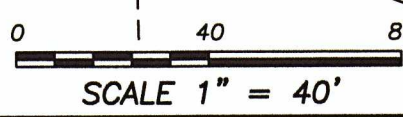

SOUTHEAST CORNER SECTION 3, T4N R3W 1.25" Rebar and ties found

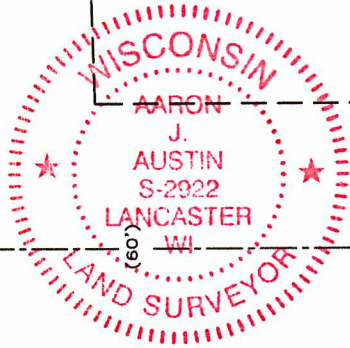

Austin Engineering LLC
austinengineeringllc.com
4211 HWY 81 E, LANCASTER, WI 53813
PHONE: 608-723-6363 FAX: 608-723-6702

Prepared for: MIC DRESSLER

JOB NO: 23S085
H:\CRD\23S085
H:\PLAT\LANCASTER\OP\BLOCK-29\23S085-DRESSLER

DRAWN BY: AJ AUSTIN
CREW CHIEF: SHANE AUSTIN
CREW: O. AUSTIN, T. AUSTIN