

MAY 25 2023

50043

PLAT OF SURVEY

DESCRIPTION PROVIDED:

Property described in Document Number 698603, Grant County Registry and being described as follows:
 The North 130 feet of the real estate described in that certain deed recorded in Volume 247 of Deed, page 336 in which said deed the real estate thereby conveyed is described as follows:
 Lot Twenty (20) of Block Sixty-two (62) of the Assessment Plat of the City of Platteville, Grant County, Wisconsin, also described as follows: A certain piece or parcel of land in the City of Platteville more particularly described as follows: Beginning at a point on the South boundary line of Fremont Street, which is South 87 1/2 West and 133 feet from the Northwest corner of Lot 3 in Block "C" in West Platteville, otherwise known as Stagg's Western Addition to the City of Platteville, Wisconsin; thence South 44 and 5 1/2 feet, more or less, to the Buck land; thence North 72 1/2 West 145 1/4 feet, more or less, to the Northwest Corner of the Buck land; thence North 6 feet, more or less to Fremont Street; thence Easterly along the South boundary of Fremont Street to the place of beginning. Also the following described tract of land:
 Commence 1.50 chains North of the Northwest corner of Lot 4 in S.E.1/4 of N.E.1/4 of Section 16, T3N, R1W of the 4th P.M., in Grant County, Wisconsin;
 thence North 5 chains;
 thence South 72 1/2 East 2 chains and 9 1/2 links;
 thence South 5 chains;
 thence North 72 1/2 West 2 chains 9 1/2 links to the place of beginning.

PROPERTY BEING SURVEYED AS FOLLOWS:

Located in the Northeast Quarter (NE 1/4) of the Northeast Quarter (NE 1/4) and the Southeast Quarter (SE 1/4) of the Northeast Quarter (NE 1/4) of Section Sixteen (16), Township Three (3) North, Range One (1) West of the 4th P.M., City of Platteville, Grant County, Wisconsin, and being described as follows:
 Commencing at a 1/2" Steel Cotton Gin Spike marking the Northeast corner of said Section 16;
 thence South 00° 41' 01" East 1209.74 feet along the East line of said Section;
 thence South 87° 59' 53" West 397.77 feet to a 3/4" rebar marking a corner of that property as described in Document Number 718527, Grant County Registry;
 thence South 87° 59' 53" West 132.91 feet along the North line of said property to a 3/4" rebar marking the point of beginning;
 thence South 01° 05' 51" West 46.08 feet along the West line of said property to a 3/4" rebar;
 thence South 78° 31' 27" East 1.73 feet along a line of said property to a 1" iron pipe;
 thence South 00° 32' 58" East 83.56 feet along a line of said property to a 1" iron pipe marking the Southeast corner of that property as described in Document Number 698603, Grant County Registry;
 thence South 87° 42' 33" West 130.97 feet along the South line of said property to a 3/4" rebar marking the Southwest corner thereof;
 thence North 00° 28' 19" West 130.00 feet along the West line of said property to a 3/4" rebar on the South line of Fremont Street;
 thence North 87° 42' 33" East 130.43 feet along the South line of Fremont Street to the point of beginning.

Being a part of Lot Twenty (20) of Block Sixty-two (62) of the Assessment Plat of the City of Platteville, Grant County, Wisconsin, according to the recorded map or plat thereof.

SURVEYOR'S CERTIFICATE:

I, Aaron J. Austin, Professional Wisconsin Land Surveyor, hereby certify:
 That the above description was surveyed, mapped and monumented as shown on this plat by me or under my direct supervision and field work was completed on 5-19-2023.
 That this survey was prepared under the instructions of Doug Heenan.
 That this survey complies with Chapter A-E 7 of the Wisconsin Administrative Code and to the best of my knowledge and belief, this plat is an accurate representation thereof.
 That all plans that do not show a seal imprint in red ink may contain unauthorized alterations.
 The certification contained on this document shall not apply to any copies.
 Dated this 22nd day of May, 2023.

Aaron J. Austin
 Aaron J. Austin, S-2922
 Agent, Austin Engineering, LLC

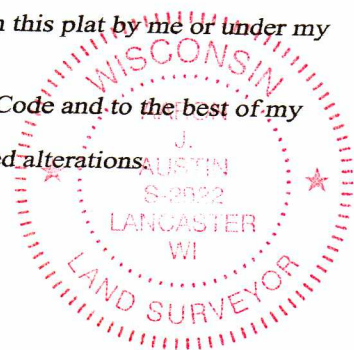

Austin Engineering LLC
 austinengineeringllc.com

4211 HWY 81 E, LANCASTER, WI 53813
 PHONE: 608-723-6363 FAX: 608-723-6702

Prepared for: **DOUG HEENAN**

JOB NO: 23S027
 H:\CRD\23S027
 H:\PLAT\PVILLE\WPVILLE\23S027-HEENAN

DRAWN BY: AJ AUSTIN
 CREW CHIEF: SHANE AUSTIN
 CREW: O. AUSTIN, T. AUSTIN