

PLAT OF SURVEY

TRACT 1 DESCRIPTION:

Located in the Southwest Quarter (SW 1/4) of the Southwest Quarter (SW 1/4) of Section Twenty-nine (29), Township Four (4) North, Range Four (4) West of the 4th P.M., Town of Beetown, Grant County, Wisconsin, and being described as follows:

Commencing at a 3/4" rebar marking the West Quarter (W 1/4) corner of said Section; thence South 02° 08' 31" East 1320.85 feet along the West line of said Section to the Southwest corner of the Northwest Quarter (NW 1/4) of the Southwest Quarter (SW 1/4) thereof; thence South 88° 50' 01" East 660.86 feet to a 3/4" rebar marking the Southeast corner of the Southwest Quarter (SW 1/4) of the Northwest Quarter (NW 1/4) of the Southwest Quarter (SW 1/4), said corner being the point of beginning; thence South 88° 50' 01" East 178.65 feet along the South line of the Northwest Quarter (NW 1/4) of the Southwest Quarter (SW 1/4) to a 3/4" rebar; thence South 42° 26' 22" West 71.76 feet to a 3/4" rebar; thence South 56° 46' 16" West 76.41 feet to a 36" diameter tree; thence North 33° 56' 23" West 118.69 feet along the East line of Lot 1 of Certified Survey Map Number 297 recorded as Document Number 535616, Grant County Registry to the point of beginning.
Tract being subject to any and all easements of record and/or usage.

TRACT 2 DESCRIPTION:

Located in the Northwest Quarter (NW 1/4) of the Southwest Quarter (SW 1/4) of Section Twenty-nine (29), Township Four (4) North, Range Four (4) West of the 4th P.M., Town of Beetown, Grant County, Wisconsin, and being described as follows:

Commencing at a 3/4" rebar marking the West Quarter (W 1/4) corner of said Section; thence South 02° 08' 31" East 1320.85 feet along the West line of said Section to the Southwest corner of the Northwest Quarter (NW 1/4) of the Southwest Quarter (SW 1/4) thereof; thence South 88° 50' 01" East 660.86 feet to a 3/4" rebar marking the Southeast corner of the Southwest Quarter (SW 1/4) of the Northwest Quarter (NW 1/4) of the Southwest Quarter (SW 1/4) thereof; thence continuing South 88° 50' 01" East 178.65 feet to a 3/4" rebar marking the point of beginning; thence continuing South 88° 50' 01" East 482.21 feet to a 3/4" rebar marking the Southeast corner of the Northwest Quarter (NW 1/4) of the Southwest Quarter (SW 1/4) thereof; thence North 02° 07' 31" West 135.72 feet along the East line of the Northwest Quarter (NW 1/4) of said Southwest Quarter (SW 1/4) to a 3/4" rebar; thence South 87° 47' 30" West 360.16 feet to a 3/4" rebar; thence South 51° 05' 20" West 72.84 feet to a 3/4" rebar; thence South 42° 26' 22" West 89.68 feet to the point of beginning.
Tract being subject to any and all easements of record and/or usage.

SURVEYOR'S CERTIFICATE:

I, Aaron J. Austin, Professional Wisconsin Land Surveyor, hereby certify:

That the above descriptions were surveyed, mapped and monumented as shown on this plat by me or under my direct supervision and field work was completed on 4-18-2023.
That this survey was prepared under the instructions of Chuck Jeidy.
That this survey complies with Chapter A-E 7 of the Wisconsin Administrative Code and to the best of my knowledge and belief, this plat is an accurate representation thereof.
That all plans that do not show a seal imprint in red ink may contain unauthorized alterations.
The certification contained on this document shall not apply to any copies.

Dated this 19th day of April, 2023.

Aaron J. Austin
Aaron J. Austin, S-2922

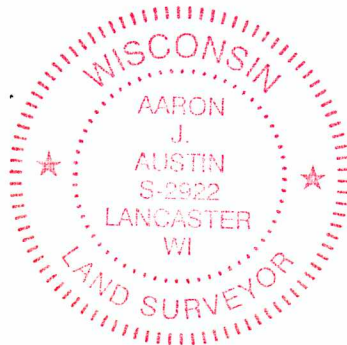

Austin Engineering LLC
austinengineeringllc.com

4211 HWY 81 E, LANCASTER, WI 53813
PHONE: 608-723-6363 FAX: 608-723-6702

Prepared for: **CHUCK JEIDY**

JOB NO: 21S287
H:\CRD\13S207
H:\PLAT\T4NR4W\29\21S287-JEIDY

FIELDBOOK: TDSR
DRAWN BY: AJ AUSTIN
CREW: SW AUSTIN