

Aaron J. Austin

ALL PLANS THAT DO NOT SHOW A SEAL
IMPRINT IN RED INK MAY CONTAIN
UNAUTHORIZED ALTERATIONS. THE
CERTIFICATION CONTAINED ON THIS
DOCUMENT SHALL NOT APPLY TO ANY
COPIES. DATED: 3-29-2023.
REVISED: 4-20-2023. *USA*



LEGEND

- Section Corner
- 3/4" rebar found
- 3/4" x 18" rebar set with cap
- [] Property described in Document Number, Grant County Registry
- Boundary of Survey
- Section line
- Centerline
- Right of Way
- Existing Improvement
- Previously surveyed line
- Existing fence

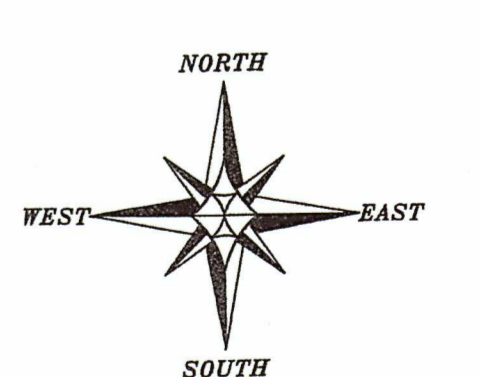

The South line of the SE 1/4 of Section 4 bears S 89°29'40" W according to the Grant County Coordinate System WISCONSIN NAD 83 (2011) which was determined by G.P.S. observation.

0 200 400
SCALE 1" = 200'

PLAT OF SURVEY
PREPARED FOR: SHANE WEST
LOCATED IN SECTIONS 3 AND 4, T5N R4W,
TOWN OF LITTLE GRANT, GRANT COUNTY, WI

Austin Engineering LLC
4211 HWY 81 E
LANCASTER, WI 53813
PHONE: 608-723-6363
FAX: 608-723-6702
austinengineeringllc.com

JOB NO: 235017
H:\CRD\235017
H:\PLAT\T5N R4W\03\235017-WEST

DRAWN BY: AJ AUSTIN
CREW CHIEF: SHANE WEST
CREW: O. AUSTIN, T. AUSTIN
SHEET 1 OF 2

REVISED
MAY 03 2023

PLAT OF SURVEY

DESCRIPTION:

Located in the Southwest Quarter (SW 1/4) of the Northwest Quarter (NW 1/4), the Northwest Quarter (NW 1/4) of the Southwest Quarter (SW 1/4) and the Southwest Quarter (SW 1/4) of the Southwest Quarter (SW 1/4) of Section Three (3) and in the Northwest Quarter (NW 1/4) of the Southeast Quarter (SE 1/4), the Northeast Quarter (NE 1/4) of the Southeast Quarter (SE 1/4) and the Southeast Quarter (SE 1/4) of the Southeast Quarter (SE 1/4) of Section Four (4), Township Five (5) North, Range Four (4) West of the 4th P.M., Town of Little Grant, Grant County, Wisconsin, and being described as follows:

Commencing at a 3/4" rebar marking the Southeast corner of said Section 4, said corner being the point of beginning;
 thence South 89° 29' 40" West 1335.19 feet along the South line of said Section 4 to a 3/4" rebar marking the Southwest corner of the Southeast Quarter (SE 1/4) of the Southeast Quarter (SE 1/4) thereof;
 thence North 00° 20' 03" West 1327.88 feet along the West line of the Southeast Quarter (SE 1/4) of the Southeast Quarter (SE 1/4) to a 3/4" rebar marking the Northwest corner thereof;
 thence South 89° 24' 54" West 1328.75 feet along the South line of the Northwest Quarter (NW 1/4) of the Southeast Quarter (SE 1/4) of said Section 4 to a 3/4" rebar marking the Southwest corner thereof;
 thence North 00° 03' 21" West 1326.07 feet along the West line of the Northwest Quarter (NW 1/4) of said Southeast Quarter (SE 1/4) to a 3/4" rebar marking the Northwest corner thereof;
 thence North 89° 20' 05" East 2644.65 feet along the North line of the Southeast Quarter (SE 1/4) of said Section Four (4) to a 3/4" rebar marking the East Quarter (E 1/4) corner thereof;
 thence North 00° 45' 17" West 1297.80 feet along the West line of the Southwest Quarter (SW 1/4) of the Northwest Quarter (NW 1/4) of said Section 3 to a 3/4" rebar marking the Northwest corner thereof;
 thence South 89° 23' 14" East 1322.94 feet along the North line of the Southwest Quarter (SW 1/4) of said Northwest Quarter (NW 1/4) to a 3/4" rebar marking the Northeast corner thereof;
 thence South 00° 38' 25" East 1298.97 feet along the East line of the Southwest Quarter (SW 1/4) of said Northwest Quarter (NW 1/4) to a 3/4" rebar marking the Southeast corner thereof;
 thence South 00° 34' 09" East 907.88 feet along the East line of the Northwest Quarter (NW 1/4) of the Southwest Quarter (SW 1/4) of said Section 3 to a 3/4" rebar;
 thence South 87° 47' 20" West 533.99 feet to a 3/4" rebar;
 thence South 02° 02' 10" East 160.01 feet;
 thence South 20° 53' 57" West 111.94 feet to a 3/4" rebar;
 thence South 58° 01' 22" West 164.90 feet to a 3/4" rebar;
 thence South 10° 06' 18" East 363.05 feet to a 3/4" rebar;
 thence South 40° 33' 21" West 169.23 feet to a 3/4" rebar;
 thence South 81° 59' 27" West 331.66 feet to a 3/4" rebar;
 thence South 01° 47' 56" East 834.56 feet to a 3/4" rebar on the South line of said Section 3;
 thence North 89° 22' 24" West 244.65 feet along the South line of said Section 3 to the point of beginning.

Tract being subject to any and all easements of record and/or usage.

SURVEYOR'S CERTIFICATE:

I, Aaron J. Austin, Professional Wisconsin Land Surveyor, hereby certify:

That the above description was surveyed, mapped and monumented as shown on this plat by me or under my direct supervision and field work was completed on 3-28-2023.
 That this survey was prepared under the instructions of Shane West.
 That this survey complies with Chapter A-E 7 of the Wisconsin Administrative Code and to the best of my knowledge and belief, this plat is an accurate representation thereof.
 That all plans that do not show a seal imprint in red ink may contain unauthorized alterations.
 The certification contained on this document shall not apply to any copies.

Dated this 29th day of March, 2023.
 Revised this 20th day of April, 2023. (Description and Map) *ASA*

Aaron J. Austin
 Aaron J. Austin, S-2922
 Agent, Austin Engineering, LLC

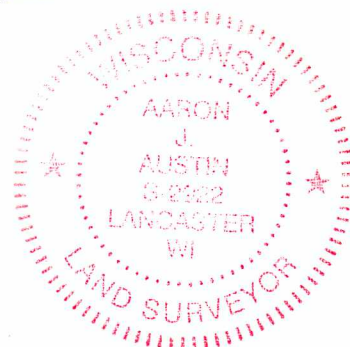

4211 HWY 81 E, LANCASTER, WI 53813
 PHONE: 608-723-6363 FAX: 608-723-6702

Prepared for: SHANE WEST

JOB NO: 23S017
 H:\CRD\23S017
 H:\PLAT\T5NR4W\03\23S017-WEST

DRAWN BY: AJ AUSTIN
 CREW CHIEF: SHANE AUSTIN
 CREW: O. AUSTIN, T. AUSTIN

PLAT OF SURVEY

DESCRIPTION:

Located in the Southwest Quarter (SW 1/4) of the Northwest Quarter (NW 1/4), the Northwest Quarter (NW 1/4) of the Southwest Quarter (SW 1/4) and the Southwest Quarter (SW 1/4) of the Southwest Quarter (SW 1/4) of Section Three (3) and in the Northwest Quarter (NW 1/4) of the Southeast Quarter (SE 1/4), the Northeast Quarter (NE 1/4) of the Southeast Quarter (SE 1/4) and the Southeast Quarter (SE 1/4) of the Southeast Quarter (SE 1/4) of Section Four (4), Township Five (5) North, Range Four (4) West of the 4th P.M., Town of Little Grant, Grant County, Wisconsin, and being described as follows:

Commencing at a 3/4" rebar marking the Southeast corner of said Section 4, said corner being the point of beginning;

thence South 89° 29' 40" West 1335.19 feet along the South line of said Section 4 to a 3/4" rebar marking the Southwest corner of the Southeast Quarter (SE 1/4) of the Southeast Quarter (SE 1/4) thereof;

thence North 00° 20' 03" West 1327.88 feet along the West line of the Southeast Quarter (SE 1/4) of the Southeast Quarter (SE 1/4) to a 3/4" rebar marking the Northwest corner thereof;

thence South 89° 24' 54" West 1328.75 feet along the South line of the Northwest Quarter (NW 1/4) of the Southeast Quarter (SE 1/4) of said Section 4 to a 3/4" rebar marking the Southwest corner thereof;

thence North 00° 03' 21" West 1326.07 feet along the West line of the Northwest Quarter (NW 1/4) of said Southeast Quarter (SE 1/4) to a 3/4" rebar marking the Northwest corner thereof;

thence North 89° 20' 05" East 2644.65 feet along the North line of the Southeast Quarter (SE 1/4) of said Section Four (4) to a 3/4" rebar marking the East Quarter (E 1/4) corner thereof;

thence North 00° 45' 17" West 1297.80 feet along the West line of the Southwest Quarter (SW 1/4) of the Northwest Quarter (NW 1/4) of said Section 3 to a 3/4" rebar marking the Northwest corner thereof;

thence South 89° 23' 13" East 1321.15 feet along the North line of the Southwest Quarter (SW 1/4) of said Northwest Quarter (NW 1/4) to a 3/4" rebar marking the Northeast corner thereof;

thence South 00° 39' 58" East 1298.97 feet along the East line of the Southwest Quarter (SW 1/4) of said Northwest Quarter (NW 1/4) to a 3/4" rebar marking the Southeast corner thereof;

thence South 00° 35' 42" East 907.93 feet along the East line of the Northwest Quarter (NW 1/4) of the Southwest Quarter (SW 1/4) of said Section 3 to a 3/4" rebar;

thence South 87° 47' 20" West 533.20 feet to a 3/4" rebar;

thence South 02° 02' 10" East 160.01 feet to a 3/4" rebar;

thence South 20° 53' 57" West 111.94 feet to a 3/4" rebar;

thence South 58° 01' 22" West 164.90 feet to a 3/4" rebar;

thence South 10° 06' 18" East 363.05 feet to a 3/4" rebar;

thence South 40° 33' 21" West 169.23 feet to a 3/4" rebar;

thence South 81° 59' 27" West 331.66 feet to a 3/4" rebar;

thence South 01° 47' 56" East 834.56 feet to a 3/4" rebar on the South line of said Section 3;

thence North 89° 22' 24" West 244.65 feet along the South line of said Section 3 to the point of beginning.

Tract being subject to any and all easements of record and/or usage.

SURVEYOR'S CERTIFICATE:

I, Aaron J. Austin, Professional Wisconsin Land Surveyor, hereby certify:

That the above description was surveyed, mapped and monumented as shown on this plat by me or under my direct supervision and field work was completed on 3-28-2023.

That this survey was prepared under the instructions of Shane West.

That this survey complies with Chapter A-E 7 of the Wisconsin Administrative Code and to the best of my knowledge and belief, this plat is an accurate representation thereof.

That all plans that do not show a seal imprint in red ink may contain unauthorized alterations.

The certification contained on this document shall not apply to any copies.

Dated this 29th day of March, 2023.

Aaron J. Austin

Aaron J. Austin, S-2922
Agent, Austin Engineering, LLC

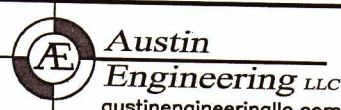

4211 HWY 81 E, LANCASTER, WI 53813
PHONE: 608-723-6363 FAX: 608-723-6702

Prepared for: SHANE WEST

JOB NO: 23S017
H:\CRD\23S017
H:\PLAT\T5NR4W\03\23S017-WEST

DRAWN BY: AJ AUSTIN
CREW CHIEF: SHANE AUSTIN
CREW: O. AUSTIN, T. AUSTIN