

PLAT OF SURVEY

DESCRIPTION:

Located in the Northwest Quarter (NW 1/4) of the Northwest Quarter (NW 1/4) of Section Twenty-three (23), Township Seven (7) North, Range Three (3) West of the 4th P.M., Town of Marion, Grant County, Wisconsin, and being described as follows:

Commencing at a 3/4" rebar marking the Northwest corner of said Section 23;
 thence North 88° 58' 31" East 1161.94 feet along the North line of said Section to a 3/4" rebar marking the point of beginning;
 thence continuing North 88° 58' 31" East 160.00 feet along said North line to a 3/4" rebar marking the Northeast corner of the Northwest Quarter (NW 1/4) of the Northwest Quarter (NW 1/4) thereof;
 thence South 00° 16' 19" West 661.97 feet along the East line of the Northwest Quarter (NW 1/4) of the Northwest Quarter (NW 1/4) to a 3/4" rebar marking the Southeast corner of the Northeast Quarter (NE 1/4) of the Northwest Quarter (NW 1/4) of the Northwest Quarter (NW 1/4) thereof;
 thence South 89° 10' 40" West 498.59 feet along the South line of the Northeast Quarter (NE 1/4) of the Northwest Quarter (NW 1/4) of the Northwest Quarter (NW 1/4) to a 3/4" rebar;
 thence North 27° 09' 08" East 748.78 feet to the point of beginning.
 Tract being subject to any and all easements of record and/or usage.

SURVEYOR'S CERTIFICATE:

I, Aaron J. Austin, Professional Wisconsin Land Surveyor, hereby certify:

That the above description was surveyed, mapped and monumented as shown on this plat by me or under my direct supervision and field work was completed on 1-9-2023.
 That this survey was prepared under the instructions of Ben Kinsinger.
 That this survey complies with Chapter A-E 7 of the Wisconsin Administrative Code and to the best of my knowledge and belief, this plat is an accurate representation thereof.
 That all plans that do not show a seal imprint in red ink may contain unauthorized alterations.
 The certification contained on this document shall not apply to any copies.

Dated this 27th day of March, 2023.

 Aaron J. Austin, S-2922
 Agent, Austin Engineering, LLC

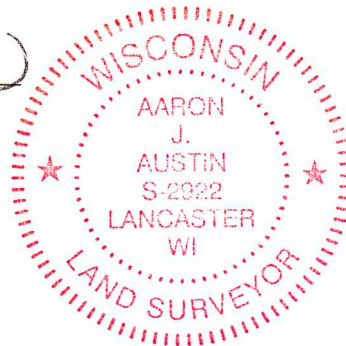

Austin
 Engineering LLC
 austinengineeringllc.com

4211 HWY 81 E, LANCASTER, WI 53813
 PHONE: 608-723-6363 FAX: 608-723-6702

Prepared for: BEN KINSINGER

JOB NO: 22S233
 H:\CRD\22S233
 H:\PLAT\T7NR3W\23\22S233-KINSINGER

DRAWN BY: AJ AUSTIN
 CREW CHIEF: SHANE AUSTIN
 CREW: O. AUSTIN, T. AUSTIN

SHEET 2 OF 2