

PLAT OF SURVEY

TRACT 2 DESCRIPTION:

Located in the Northeast Quarter (NE 1/4) of the Northwest Quarter (NW 1/4) and the Southeast Quarter (SE 1/4) of the Northwest Quarter (NW 1/4) of Section Thirty-four (34), Township Six (6) North, Range One (1) West of the 4th P.M., Town of Wingville, Grant County, Wisconsin, and being described as follows:

Commencing at an Aluminum Monument marking the North Quarter (N 1/4) corner of said Section 34;
 thence South 00° 15' 10" East 997.90 feet along the North-South Quarter (N-S 1/4) line of said Section to a mag nail marking the point of beginning;
 thence continuing South 00° 15' 10" East 456.95 feet along said North-South Quarter (N-S 1/4) line to a mag nail marking a corner of that property as described in Document Number 803767, Grant County Registry;
 thence North 89° 04' 22" West 538.64 feet along a line of said property to a 3/4" rebar;
 thence North 01° 01' 42" West 325.35 feet along a line of said property to a 3/4" rebar;
 thence North 16° 48' 06" West 125.75 feet along a line of said property to a 3/4" rebar;
 thence North 89° 44' 50" East 578.75 feet to the point of beginning.
 Tract being subject to any and all easements of record and/or usage.

TRACT 3 DESCRIPTION:

Located in the Southeast Quarter (SE 1/4) of the Northwest Quarter (NW 1/4) of Section Thirty-four (34), Township Six (6) North, Range One (1) West of the 4th P.M., Town of Wingville, Grant County, Wisconsin, and being described as follows:

Commencing at 3/4" rebar marking the West Quarter (W 1/4) corner of said Section 34;
 thence South 89° 59' 05" East 1756.82 feet along the East-West Quarter (E-W 1/4) line of said Section to a mag nail marking the point of beginning
 thence North 00° 00' 45" East 682.89 feet to a 3/4" rebar marking a corner of that property as described in Document Number 803767, Grant County Registry;
 thence South 82° 09' 21" East 746.32 feet along a line of said property to a 3/4" rebar;
 thence South 08° 28' 07" East 303.15 feet along a line of said property to a 3/4" rebar;
 thence South 32° 24' 49" East 88.62 feet along a line of said property to a 3/4" rebar;
 thence South 10° 03' 49" East 209.83 feet along a line of said property to a mag nail on the East-West Quarter (E-W 1/4) line of said Section;
 thence North 89° 59' 05" West 868.30 feet along said East-West Quarter (E-W 1/4) line to the point of beginning.
 Tract being subject to any and all easements of record and/or usage.

SURVEYOR'S CERTIFICATE:

I, Aaron J. Austin, Professional Wisconsin Land Surveyor, hereby certify:

That the above descriptions were surveyed, mapped and monumented as shown on this plat by me or under my direct supervision and field work was completed on 3-9-2023.
 That this survey was prepared under the instructions of Brent Holman.
 That this survey complies with Chapter A-E 7 of the Wisconsin Administrative Code and to the best of my knowledge and belief, this plat is an accurate representation thereof.
 That all plans that do not show a seal imprint in red ink may contain unauthorized alterations.
 The certification contained on this document shall not apply to any copies.

Dated this 14th day of March, 2023.

 Aaron J. Austin, S-2922

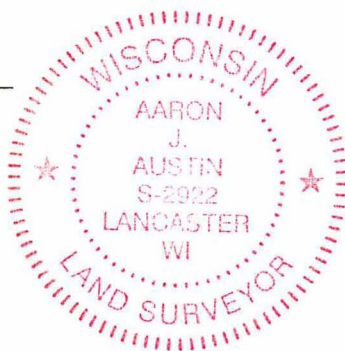

Austin
 Engineering LLC
 austinengineeringllc.com

4211 HWY 81 E, LANCASTER, WI 53813
 PHONE: 608-723-6363 FAX: 608-723-6702

Prepared for: BRENT HOLMAN

JOB NO: 23S041
 H:\GRD\19S041
 H:\PLAT\T6NR1W\34\23S041-HOLMAN

DRAWN BY: AJ AUSTIN
 CREW CHIEF: SHANE AUSTIN
 CREW: O. AUSTIN, T. AUSTIN

SHEET 2 OF 2