

PLAT OF SURVEY

DESCRIPTION PROVIDED:

Property described in Document Number 684659, Grant County Registry and being described as follows:

A part of the Northwest Quarter (NW 1/4) of the Northwest Quarter (NW 1/4) of Section Twenty-nine (29), Township Six (6) North, Range Three (3) West of the 4th P.M., Grant County, Wisconsin, described as follows:

Commencing at a point 394 links East of the stone which marks the Northwest corner of said Section 29;

thence East 10.21 chains;

thence South 35° West (sometimes described as South 53° West) 9.34 chains to the center of the highway;

thence Northwest along the centerline of the highway 6.83 1/3 chains;

thence North to the place of beginning, and also known as Outlot Four (4) of the Village of Mt. Ida, Grant County, Wisconsin.

EXCEPTING therefrom a part of the NW 1/4 of Section 29, T6N, R3W described as follows:

Commencing at a point 3.94 chains (260.04 ft.) East of the stone which marks the Northwest corner of said Section 29;

thence East 200 feet;

thence South to the centerline of U.S. Highway 18;

thence Northwest along the center of said highway to a point directly South of the point of beginning;

thence North to the place of beginning.

SURVEYOR'S CERTIFICATE:

I, Aaron J. Austin, Professional Wisconsin Land Surveyor, hereby certify:

That the above description was surveyed, mapped and monumented as shown on this plat by me or under my direct supervision and field work was completed on 4-19-2022.

That this survey was prepared under the instructions of Sandy Leffler.

That this survey complies with Chapter A-E 7 of the Wisconsin Administrative Code and to the best of my knowledge and belief, this plat is an accurate representation thereof.

That all plans that do not show a seal imprint in red ink may contain unauthorized alterations.

The certification contained on this document shall not apply to any copies.

Dated this 2nd day of May, 2022.

 Aaron J. Austin, S-2922

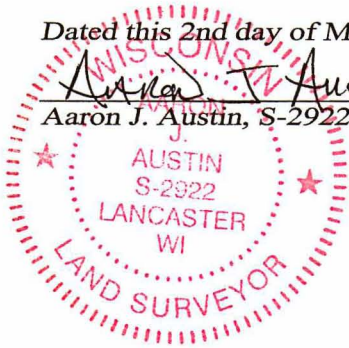

Austin
Engineering LLC
 austinengineeringllc.com

4211 HWY 81 E, LANCASTER, WI 53813
 PHONE: 608-723-6363 FAX: 608-723-6702

Prepared for: SANDY LEFFLER

JOB NO: 21S278
 H:\CRD\21S278
 H:\PLAT\MT IDA\21S278-LEFFLER

FIELDBOOK: TDSR
 DRAWN BY: AJ AUSTIN
 CREW: OWEN AUSTIN

SHEET 2 OF 2