

PLAT OF SURVEY

TRACT 1 DESCRIPTION:

The South Half (S 1/2) of the Southwest Quarter (SW 1/4) of the Southeast Quarter (SE 1/4) of Section Twenty-seven (27), Township Four (4) North, Range One (1) West of the 4th P.M., Town of Lima, Grant County, Wisconsin.

Tract being subject to any and all easements of record and/or usage.

TRACT 2 DESCRIPTION:

Located in the Northwest Quarter (NW 1/4) of the Northeast Quarter (NE 1/4) of Section Thirty-four (34), Township Four (4) North, Range One (1) West of the 4th P.M., Town of Lima, Grant County, Wisconsin, and being described as follows:

Commencing at the North Quarter (N 1/4) corner of said Section 34;
thence North 89° 33' 10" East 371.03 feet along the North line of said Section to the point of beginning;
thence continuing North 89° 33' 10" East 958.30 feet along said North line to the Northeast corner of the Northwest Quarter (NW 1/4) of said Northeast Quarter (NE 1/4) ;
thence South 00° 07' 34" East 12.55 feet along a line of that property as described in Document Number 698209, Grant County Registry;
thence South 89° 13' 04" West 853.96 feet along a line of said property;
thence 96.24 feet on the arc of a curve to the left with a radius of 340.00 feet and a long chord bearing South 81° 06' 30" West 95.92 feet along a line of said property;
thence North 17° 00' 04" West 33.00 feet to the point of beginning.
Tract being subject to any and all easements of record and/or usage.

SURVEYOR'S CERTIFICATE:

I, Aaron J. Austin, Professional Wisconsin Land Surveyor, hereby certify:

That the above descriptions were surveyed, mapped and monumented as shown on this plat by me or under my direct supervision and field work was completed on 2-11-2022.

That this survey was prepared under the instructions of Anne Defore.

That this survey complies with Chapter A-E 7 of the Wisconsin Administrative Code and to the best of my knowledge and belief, this plat is an accurate representation thereof.

That all plans that do not show a seal imprint in red ink may contain unauthorized alterations.

The certification contained on this document shall not apply to any copies.

Dated this 16th day of February, 2022.

Aaron J. Austin, S-2922

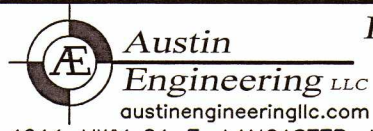
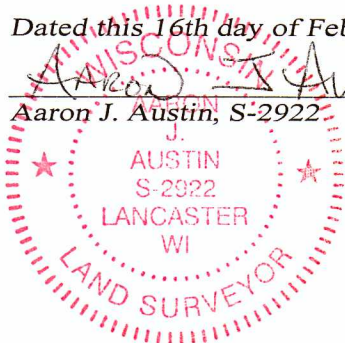

4211 HWY 81 E, LANCASTER, WI 53813
PHONE: 608-723-6363 FAX: 608-723-6702

Prepared for: ANNE DEFORE

JOB NO: 21S234
H:\CRD\21S234
H:\PLAT\T4NR1W\27\21S234-DEFORE

FIELDBOOK: TDSR
DRAWN BY: AJ AUSTIN
CREW: S. AUSTIN, O. AUSTIN