

PLAT OF SURVEY

TRACT 1 DESCRIPTION:

Located in the Northeast Quarter (NE 1/4) of the Northeast Quarter (NE 1/4) and the Southeast Quarter (SE 1/4) of the Northeast Quarter (NE 1/4) of Section Five (5), Township Four (4) North, Range Two (2) West of the 4th P.M., Town of Ellenboro, Grant County, Wisconsin, and being described as follows:

Commencing at an Aluminum Monument marking the Northeast corner of said Section 5; thence North 89° 58' 47" West 1328.76 feet along the North line of said Section to a 3/4" rebar marking the Northwest corner of the Northeast Quarter (NE 1/4) of said Northeast Quarter (NE 1/4); thence South 01° 08' 42" East 908.43 feet along the West line of the Northeast Quarter (NE 1/4) of the Northeast Quarter (NE 1/4) of said Section 5 to a 3/4" rebar marking the point of beginning; thence North 84° 59' 23" East 623.80 feet along an existing fence to a 3/4" rebar; thence South 07° 43' 25" East 835.72 feet along an existing fence to a 3/4" rebar; thence North 07° 32' 44" West 1257.09 feet along a line of that property as described in Document Number 800082, Grant County Registry to a 3/4" rebar; thence South 63° 06' 52" West 184.80 feet along a line of said property to a 3/4" rebar; thence South 01° 58' 44" West 199.38 feet along a line of said property to a 3/4" rebar; thence South 77° 03' 50" West 409.29 feet along a line of said property to a 3/4" rebar; thence South 01° 08' 42" East 98.11 feet along the West line of the Northeast Quarter (NE 1/4) of said Northeast Quarter (NE 1/4) to the point of beginning.
Tract being subject to any and all easements of record and/or usage.

TRACT 2 DESCRIPTION:

Located in the Northeast Quarter (NE 1/4) of the Northeast Quarter (NE 1/4) and the Southeast Quarter (SE 1/4) of the Northeast Quarter (NE 1/4) of Section Five (5), Township Four (4) North, Range Two (2) West of the 4th P.M., Town of Ellenboro, Grant County, Wisconsin, and being described as follows:

Commencing at an Aluminum Monument marking the Northeast corner of said Section 5; thence North 89° 58' 47" West 1328.76 feet along the North line of said Section to a 3/4" rebar marking the Northwest corner of the Northeast Quarter (NE 1/4) of said Northeast Quarter (NE 1/4); thence South 01° 08' 42" East 908.43 feet along the West line of the Northeast Quarter (NE 1/4) of the Northeast Quarter (NE 1/4) of said Section 5 to a 3/4" rebar marking the point of beginning; thence North 84° 59' 23" East 623.80 feet along an existing fence to a 3/4" rebar; thence South 07° 43' 25" East 835.72 feet along an existing fence to a 3/4" rebar; thence South 69° 04' 01" East 174.91 feet along a line of that property as described in Document Number 800082, Grant County Registry to a 3/4" rebar; thence South 13° 38' 10" East 307.32 feet along a line of said property to a point in the centerline of County Highway "A"; thence South 80° 44' 09" West 485.44 feet along said centerline; thence North 01° 08' 42" West 655.75 feet along a line of that property as described in Document Number 804992, Grant County Registry to a 3/4" rebar; thence North 89° 07' 52" West 466.39 feet along a line of said property to a 3/4" rebar; thence North 01° 08' 42" West 550.37 feet along the West line of the Northeast Quarter (NE 1/4) of said Northeast Quarter (NE 1/4) to the point of beginning.
Tract being subject to any and all easements of record and/or usage.

SURVEYOR'S CERTIFICATE:

I, Aaron J. Austin, Professional Wisconsin Land Surveyor, hereby certify:
That the above descriptions were surveyed, mapped and monumented as shown on this plat by me or under my direct supervision and the field work was completed on 10-14-2021.
That this survey was prepared under the instructions of Mike Hampton.
That this survey complies with Chapter A-E 7 of the Wisconsin Administrative Code and to the best of my knowledge and belief, this plat is an accurate representation thereof.
Dated this 4th day of February, 2022.

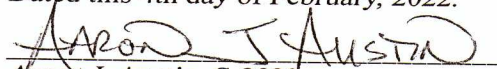
Aaron J. Austin, S-2922

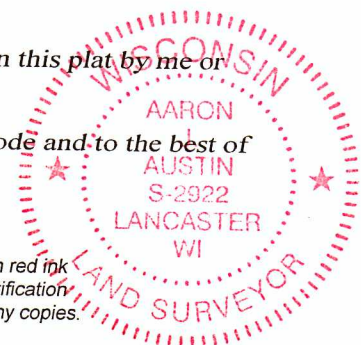

That all plans that do not show a seal imprint in red ink may contain unauthorized alterations. The certification contained on this document shall not apply to any copies.



Prepared for: MIKE HAMPTON

4211 HWY 81 E, LANCASTER, WI 53813
PHONE: 608-723-6363 FAX: 608-723-6702

JOB NO: 22S014
H:\CRD\21s087
H:\PLAT\T4NR2W\05\22S014-HAMPTON

FIELDBOOK: TDSR
DRAWN BY: AJ AUSTIN
CREW: SHANE AUSTIN, OWEN AUSTIN
SHEET 2 OF 2