

PLAT OF SURVEY

LEGEND

- ⊕ Section Corner
- 5/8" x 18" rebar set with cap
- ⊙ Mag nail set
- () Recorded as
- Boundary of Survey
- - - Section line
- - - Centerline
- - - Right of Way
- - - Previously surveyed line
- * * * * Existing fence

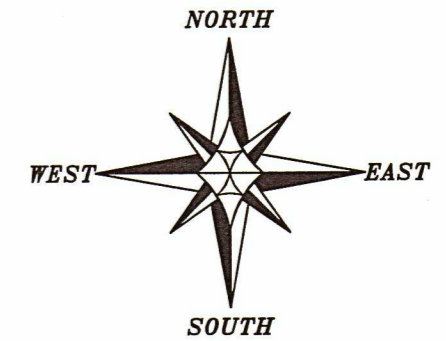

The East-West 1/4 line of Section 2 bears N 89°31'24" W according to the Grant County Coordinate System WISCORS NAD 83 (2011) which was determined by G.P.S. observation.

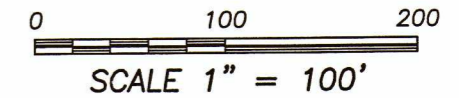

TRACT 2
PREVIOUS SURVEY
BY LARRY AUSTIN
DATED 3-5-2008
BOOK 22, PAGE 65

CENTERLINE
COUNTY HIGHWAY "Q"

C1
A=541.93'
R=1042.14'
CL=535.84'
CB=S 41°37'18" W

C2
A=533.67'
R=997.14'
CL=527.33'
CB=S 41°11'11" W

6.02± ACRES
262,463± SQ.FT.

TRACT 3
PREVIOUS SURVEY
BY LARRY AUSTIN
DATED 3-5-2008
BOOK 22, PAGE 65

WEST 1/4 CORNER
SECTION 2, T6N R2W
1 1/4" x 24" Rebar
set. New tie sheet.

EAST 1/4 CORNER
SECTION 2, T6N R2W
Aluminum Capped rebar
found. New tie sheet.

TRACT 3
PREVIOUS SURVEY
BY LARRY AUSTIN
DATED 3-5-2008
BOOK 22, PAGE 65



Austin
Engineering LLC
austinengineeringllc.com
4211 HWY 81 E, LANCASTER, WI 53813
PHONE: 608-723-6363 FAX: 608-723-6702
H:\PLAT\T6NR2W\02\21S199-WOLF SHEET 1 OF 2

47071

PLAT OF SURVEY

DESCRIPTION:

Located in the Southeast Quarter (SE 1/4) of the Northeast Quarter (NE 1/4) and the Northeast Quarter (NE 1/4) of the Southeast Quarter (SE 1/4) of Section Two (2), Township Six (6) North, Range Two (2) West of the 4th P.M., Town of Fennimore, Grant County, Wisconsin, and being described as follows:

Commencing at the East Quarter (E 1/4) corner of said Section 2;
thence North 89° 31' 24" West 50.66 feet along the East-West Quarter (E-W 1/4) line of said Section;
thence North 27° 07' 56" West 143.83 feet to the point of beginning;
thence North 27° 07' 56" West 397.17 feet to a point in the centerline of County Highway "Q";
thence South 56° 31' 08" West 215.88 feet along said centerline;
thence 541.93 feet on the arc of a curve to the left with a radius of 1042.14 feet and a long chord bearing South 41° 37' 18" West 535.84 feet along said centerline;
thence South 44° 43' 00" East 127.31 feet;
thence South 86° 54' 06" East 226.93 feet;
thence South 75° 53' 44" East 91.36 feet;
thence South 68° 07' 38" East 180.22 feet;
thence North 17° 39' 04" West 249.24 feet;
thence North 61° 17' 44" East 251.56 feet to the point of beginning.

SURVEYOR'S CERTIFICATE:

I, Aaron J. Austin, Professional Wisconsin Land Surveyor, hereby certify:

That the above description was surveyed, mapped and monumented as shown on this plat by me or under my direct supervision and field work was completed on 10-12-2021.

That this survey was prepared under the instructions of Jeff Wolf.

That this survey complies with Chapter A-E 7 of the Wisconsin Administrative Code and to the best of my knowledge and belief, this plat is an accurate representation thereof.

That all plans that do not show a seal imprint in red ink may contain unauthorized alterations.

The certification contained on this document shall not apply to any copies.

Dated this 1st day of November, 2021.

Aaron J. Austin
Aaron J. Austin, S-2922

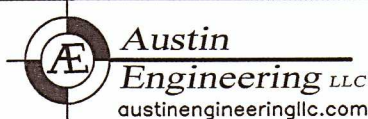
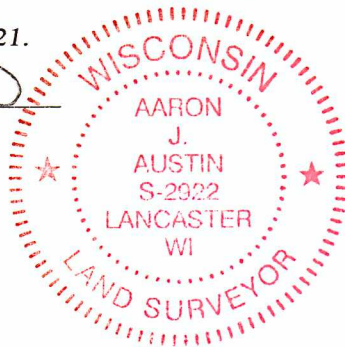

4211 HWY 81 E, LANCASTER, WI 53813
PHONE: 608-723-6363 FAX: 608-723-6702

Prepared for: JEFF WOLF

JOB NO: 21S199
H:\CRD\21S199
H:\PLAT\T6NR2W\02\21S199-WOLF

FIELDBOOK: TDSR
DRAWN BY: AJ AUSTIN
CREW: SHANE AUSTIN