

PLAT OF SURVEY

LOCATED IN THE SW1/4 SW1/4 OF SECTION 2, T1N, R1W
OF THE 4TH P.M., (TOWN OF HAZEL GREEN) GRANT
COUNTY, WISCONSIN

FOUND 1" ROD W/ ALUMINUM CAP
● THE E1/4 CORNER OF
SECTION 3, T1N, R1W

NW1/4 SW1/4
SECTION 2, T1N, R1W

N 89°38'07" E 660.52'

SE1/4, SE1/4
SECTION 3, T1N, R1W
EXCLUDING THE WEST 30 RODS

N 01°21'55" W 2638.38'
N 01°21'55" W 1319.18'

1286.18'

WEST 1/2
SW1/4 SW1/4
SECTION 2, T1N, R1W
NET AREA = 19.469 ACRES (848,047 SF)
ROW AREA = 0.499 ACRES (21,744 SF)
TOTAL AREA = 19.968 ACRES (869,791 SF)

EAST 1/2
SW1/4 SW1/4
SECTION 2, T1N, R1W

1285.00'
S 01°17'49" E 1318.00'

KIRKWOOD ROAD
(66' ROW)
(20' +/- ROAD WIDTH)

FOUND 1" ROD W/ ALUMINUM CAP
● THE SE CORNER OF
SECTION 3, T1N, R1W

FOUND 1" ROD W/ ALUMINUM CAP
● THE N1/4 CORNER OF
SECTION 11, T1N, R1W

ROW
SECTION 3
SECTION 10
33.00'
S 89°32'04" W 658.96'
33.00'
SECTION 2
SECTION 11
1976.77'
ROW

ROW

WARRANTY DEED
#772224

NORTH 3/4
NW1/4 NW1/4
SECTION 11, T1N, R1W
EXCEPTING WD-#772224

NE1/4 NE1/4
SECTION 10, T1N, R1W
EXCEPTING LOT IN
VOLUME 756, PAGE 265

LEGEND

- FOUND 3/4" ROD
- ⊗ FOUND SECTION CORNER MONUMENT
- ⊠ PLACED MAGNAIL
- PLACED 24" x 3/4" IRON REROD
BAR MIN. WT. = 1.50 lbs./lin. ft.
- SURVEYED BOUNDARY LINE
- PROPERTY LINE
- ROW — RIGHT OF WAY (ROW) LINE
- - - - - EXISTING EDGE OF ASPHALT
SECTION LINE
- POB POINT OF BEGINNING
- SF SQUARE FEET

NOTES

1. ALL MEASUREMENTS ARE IN FEET AND DECIMALS THEREOF.
2. PROPRIETOR OF THE W1/2 OF SW1/4 SW1/4 OF SECTION 2, T1N, R1W:
ROBERT K. JOHNS ESTATE - 409 W. BENTON RD., CUBA CITY, WI 53807
3. DATE OF FIELD SURVEY: 9/21/2021
4. TOTAL AREA OF PERIMETER SURVEYED IS 19.968 ACRES.
5. THIS PLAT IS SUBJECT TO ALL EASEMENTS OF RECORD AND NOT OF RECORD.

PREPARED BY: BUESING & ASSOCIATES
ADDRESS: 1212 LOCUST STREET, DUBUQUE, IOWA 52001
PHONE: (563) 556-4389

DWG NO. 21301-01

BEARING IS BASED FROM WISCONSIN COUNTY COORDINATE SYSTEM, GRANT COUNTY

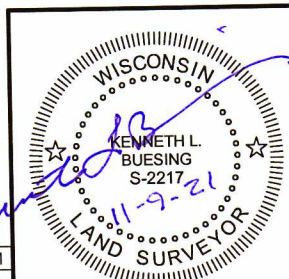
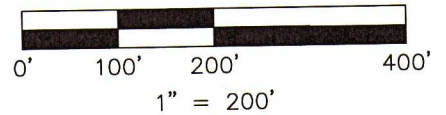

1 of 2 SHEET	PLAT OF SURVEY	PROJECT	NO. 21301	BUESING ASSOCIATES INC. ENGINEERS AND SURVEYORS 1212 LOCUST ST, DUBUQUE, IA (563) 556-4389	DATE	REVISIONS	DRAWN BY:
		SURVEY REQUESTED BY: GREG KIeler B12 KIRKWOOD CUBA CITY, WI 53807			10/15/21		JUL
					SCALE:		CHECKED BY:
					1" = 200'		KLB

47069

PLAT OF SURVEY

LOCATED IN THE SW1/4 SW1/4, SECTION 2, T1N, R1W
OF THE 4TH P.M., (TOWN OF HAZEL GREEN) GRANT COUNTY, WISCONSIN

SURVEYOR'S CERTIFICATE

I, Kenneth L. Buesing, Wisconsin Registered Land Surveyor, S-2217, hereby certify: That in full compliance with Chapter A-E-7 of the Wisconsin Administrative Code and under the direction of Gregory C. Kieler, I have surveyed and mapped the following described land: that such plat correctly represents all exterior boundaries of the land surveyed and is subject to any and all easements of record and or usage to the best of my knowledge and belief; and that this land is located in the SW1/4 SW1/4 of Section 2, T1N, R1W of the 4th P.M., (Town of Hazel Green) Grant County, Wisconsin, containing 19.968 total acres of land of which 0.499 acres are Right of Way, more particularly described as follows:

SURVEY PERIMETER

Commencing at the SE corner of Section 3, T1N, R1W, this also being the Point of Beginning (POB);

Thence N 01°21'55" W along the East Section line of Section 3, a distance of 1319.18 feet to the SW corner of the NW1/4, SW1/4 of Section 2, T1N, R1W;

Thence N 89°38'07" E along the South line of the NW1/4, SW1/4 of said Section 2, distance of 660.52 feet to the NW corner of the E1/2 of SW1/4, SW1/4 of said Section 2;

Thence S 01°17'49" E along the West line of said E1/2 of the SW1/4, SW1/4 of said Section 2, a distance of 1318.00 feet to the North line of Section 11, T1N, R1W (also being the center of the 66 foot Right of Way (ROW) of Kirkwood Road);

Thence S 89°32'04" W along the North line of said Section 11, a distance of 658.96 feet to the Point of Beginning.

Dated this 9th day of NOVEMBER, 2021

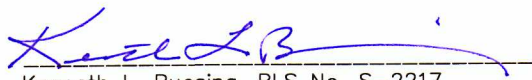

Kenneth L. Buesing, RLS No. S-2217
Registered Land Surveyor
My License Renewal date is January 31, 2022

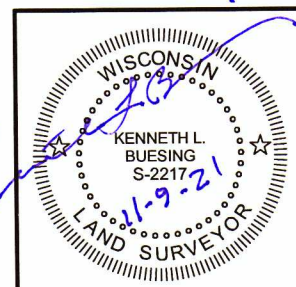

2 OF 2 SHEET	PROJECT	NO. 21301	BUESING ASSOCIATES INC. ENGINEERS AND SURVEYORS 1212 LOCUST ST, DUBUQUE, IA (563) 556-4389	DATE	REVISIONS	DRAWN BY:
	CERTIFIED SURVEY MAP	SURVEY REQUESTED BY: GREG KIELER 812 KIRKWOOD ROAD CUBA CITY, WI 53807		10/20/21		JUL
				SCALE:		CHECKED BY:
				N/A		KLB