



47048

# PLAT OF SURVEY

## DESCRIPTION:

Located in the Southwest Quarter (SW 1/4) of the Northwest Quarter (NW 1/4) and the Northwest Quarter (NW 1/4) of the Southwest Quarter (SW 1/4) of Section Fifteen (15) and in the Southeast Quarter (SE 1/4) of the Northeast Quarter (NE 1/4), the Northeast Quarter (NE 1/4) of the Southeast Quarter (SE 1/4) and the Southeast Quarter (SE 1/4) of the Southeast Quarter (SE 1/4) of Section Sixteen (16), Township Three (3) North, Range Four (4) West of the 4th P.M., Town of Waterloo, Grant County, Wisconsin, and being described as follows:

Commencing at a 1 1/4" rebar marking the Southeast corner of said Section 16, said corner being the point of beginning;  
thence North 89° 54' 33" West 435.52 feet along the South line of said Section 16 to a 5/8" rebar;  
thence North 13° 44' 36" East 310.78 feet to a 5/8" rebar;  
thence North 39° 55' 45" East 187.76 feet to a 5/8" rebar;  
thence North 03° 16' 43" East 329.19 feet to a 5/8" rebar;  
thence North 09° 26' 02" East 515.03 feet to a 5/8" rebar;  
thence North 06° 33' 24" West 205.86 feet to a 5/8" rebar;  
thence North 35° 05' 49" West 1014.76 feet to a 5/8" rebar;  
thence North 81° 17' 39" West 118.13 feet to a 5/8" rebar;  
thence North 62° 21' 27" West 113.08 feet to a 5/8" rebar;  
thence North 68° 13' 59" West 218.98 feet to a 5/8" rebar;  
thence North 02° 55' 48" West 610.33 feet to a 5/8" rebar;  
thence South 63° 30' 35" East 147.03 feet to a 5/8" rebar;  
thence South 43° 08' 50" East 254.00 feet to a 5/8" rebar;  
thence North 41° 57' 53" East 440.40 feet to a 5/8" rebar;  
thence North 23° 45' 02" West 112.17 feet to a 5/8" rebar;  
thence North 12° 02' 39" West 209.50 feet to a 5/8" rebar;  
thence North 25° 28' 11" West 95.97 feet to a 5/8" rebar;  
thence North 38° 50' 42" West 164.09 feet to a magnetic nail in the previously surveyed centerline of Chase Ridge Road;  
thence South 73° 08' 02" East 390.03 feet along said centerline to a magnetic nail;  
thence 195.46 feet on the arc of a curve to the right with a radius of 455.00 feet and a long chord bearing South 60° 49' 38" East 193.96 feet along said centerline to a magnetic nail;  
thence 448.15 feet on the arc of a curve to the left with a radius of 4300.00 feet and a long chord bearing South 51° 30' 22" East 447.95 feet along said centerline to a magnetic nail;  
thence South 00° 10' 08" East 542.91 feet along a line of Tract 2 of that property as described in Document Number 807734, Grant County Registry to a 3/4" rebar;  
thence South 00° 45' 18" East 481.28 feet along a line of said property to a 3/4" rebar;  
thence North 69° 06' 01" West 107.59 feet along a line of said property to a 3/4" rebar;  
thence South 00° 45' 18" East 2205.58 feet along the East line of said Section 16 to the point of beginning.  
Tract being subject to any and all easements of record and/or usage.

## SURVEYOR'S CERTIFICATE:

I, Aaron J. Austin, Professional Wisconsin Land Surveyor, hereby certify:  
That the above description was surveyed, mapped and monumented as shown on this plat by me or under my direct supervision and field work was completed on 9-15-2021.  
That this survey was prepared under the instructions of Neil Seng.  
That this survey complies with Chapter A-E 7 of the Wisconsin Administrative Code and to the best of my knowledge and belief, this plat is an accurate representation thereof.  
That all plans that do not show a seal imprint in red ink may contain unauthorized alterations.  
The certification contained on this document shall not apply to any copies.

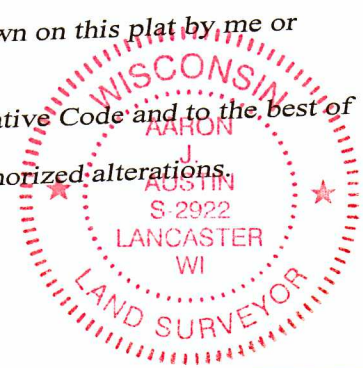

Dated this 22nd day of September, 2021.

*Aaron J. Austin*  
Aaron J. Austin, S-2922

Prepared for: NEIL SENG

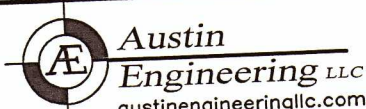

4211 HWY 81 E, LANCASTER, WI 53813  
PHONE: 608-723-6363 FAX: 608-723-6702

JOB NO: 21S204  
H:\CRD\21S118  
H:\PLAT\T3NR4W\16\21S204-SENG

FIELDBOOK: TDSR  
DRAWN BY: AJ AUSTIN  
CREW: S. AUSTIN, O. AUSTIN  
SHEET 2 OF 2