

# MAP AND DESCRIPTION



The East line of the SE 1/4 of Section 15 bears S 00°53'00" E according to the Grant County Coordinate System WISCONSIN NAD 83 (2011) which was determined by G.P.S. observation.

NW 1/4-SE 1/4 SECTION 15

CENTERLINE TOWN HALL ROAD

EAST 1/4 CORNER SECTION 15, T7N R3W  
Aluminum Capped rebar and ties found

15 14  
15 14  
1010.84'  
S 00°53'00" E

Point of Beginning Intersection of Town Hall Road and Tower Road

NE 1/4-SE 1/4 SECTION 15

S 89°07'00" W 1042.23'

C1  
A=103.96'  
R=725.00'  
CL=103.88'  
CB=S 02°42'52" W

S 06°49'21" W 187.15'

TOTAL LENGTH: 3,387.25 FEET

C2  
A=250.70'  
R=540.00'  
CL=248.46'  
CB=S 11°54'23" W

CENTERLINE TOWER ROAD

S 01°23'38" E 109.83'

C3  
A=167.60'  
R=275.00'  
CL=165.02'  
CB=S 07°44'49" W

S 25°12'24" W 63.59'

SW 1/4-SE 1/4 SECTION 15

SE 1/4-SE 1/4 SECTION 15

C4  
A=172.89'  
R=450.00'  
CL=171.83'  
CB=S 01°17'36" W

S 09°42'47" E 435.10'

EXISTING CENTERLINE

C5  
A=101.89'  
R=1000.00'  
CL=101.84'  
CB=S 15°13'06" W

S 12°17'59" W 119.01'

SOUTHEAST CORNER SECTION 15, T7N R3W  
3/4" Rebar and ties found

2678.96'  
15 14  
22 23

C6  
A=40.45'  
R=400.00'  
CL=40.43'  
CB=S 15°14'25" W

S 18°08'14" W 89.40'



C8  
A=239.95'  
R=546.00'  
CL=238.02'  
CB=S 11°51'33" W

C7  
A=323.27'  
R=1530.00'  
CL=322.67'  
CB=S 18°23'45" W

NW 1/4-NE 1/4 SECTION 22

NE 1/4-NE 1/4 SECTION 22

C9  
A=65.67'  
R=600.00'  
CL=65.64'  
CB=S 02°24'19" W

S 00°43'50" E 123.35'

## LEGEND

- ⊙ Section Corner
- No monument set
- Section line
- Centerline
- Right of Way
- Described centerline
- Described Right of Way

C10  
A=343.10'  
R=1005.41'  
CL=341.44'  
CB=S 04°14'07" E

S 14°00'42" E 58.07'

SW 1/4-NE 1/4 SECTION 22

SE 1/4-NE 1/4 SECTION 22

C11  
A=230.92'  
R=350.00'  
CL=226.75'  
CB=S 04°53'20" W

Terminus Point Intersection of Tower Road and Pine Knob Road

CENTERLINE PINE KNOB ROAD

0 300 600  
SCALE 1" = 300'



Austin Engineering LLC  
austinengineeringllc.com

4211 HWY 81 E, LANCASTER, WI 53813  
PHONE: 608-723-6363 FAX: 608-723-6702

Prepared for: MARION TOWNSHIP

JOB NO: 21S055  
H:\CRD\21S055  
H:\PLAT\T7NR3W\15\21S055-MARION TWP

FIELDBOOK: TDSR  
DRAWN BY: AJ AUSTIN  
CREW: OWEN AUSTIN

47037

# MAP AND DESCRIPTION

**REALIGNMENT DESCRIPTION FOR THE EXISTING LOCATION OF TOWER ROAD:**

Located in Section Fifteen (15) and Section Twenty-two (22), Township Seven (7) North, Range Three (3) West of the 4th P.M., Town of Marion, Grant County, Wisconsin, and the centerline being described as follows:

Commencing at the East Quarter (E 1/4) corner of said Section 15;  
 thence South 00° 53' 00" East 1010.84 feet along the East line of said Section 15;  
 thence South 89° 07' 00" West 1042.23 feet to a point in the intersection of Town Hall Road and Tower Road, said point being the point of beginning;  
 thence South 06° 49' 21" West 187.15 feet along the centerline of Tower Road;  
 thence 103.96 feet on the arc of a curve to the left with a radius of 725.00 feet and a long chord bearing South 02° 42' 52" West 103.88 feet along said centerline;  
 thence South 01° 23' 38" East 109.83 feet along said centerline;  
 thence 250.70 feet on the arc of a curve to the right with a radius of 540.00 feet and a long chord bearing South 11° 54' 23" West 248.46 feet along said centerline;  
 thence South 25° 12' 24" West 63.59 feet along said centerline;  
 thence 167.60 feet on the arc of a curve to the left with a radius of 275.00 feet and a long chord bearing South 07° 44' 49" West 165.02 feet along said centerline;  
 thence South 09° 42' 47" East 435.10 feet along said centerline;  
 thence 172.89 feet on the arc of a curve to the right with a radius of 450.00 feet and a long chord bearing South 01° 17' 36" West 171.83 feet along said centerline;  
 thence South 12° 17' 59" West 119.01 feet along said centerline;  
 thence 101.89 feet on the arc of a curve to the right with a radius of 1000.00 feet and a long chord bearing South 15° 13' 06" West 101.84 feet along said centerline;  
 thence South 18° 08' 14" West 89.40 feet along said centerline;  
 thence 40.45 feet on the arc of a curve to the left with a radius of 400.00 feet and a long chord bearing South 15° 14' 25" West 40.43 feet along said centerline;  
 thence South 12° 20' 35" West 161.34 feet along said centerline;  
 thence 323.27 feet on the arc of a curve to the right with a radius of 1530.00 feet and a long chord bearing South 18° 23' 45" West 322.67 feet along said centerline;  
 thence 239.95 feet on the arc of a curve to the left with a radius of 546.00 feet and a long chord bearing South 11° 51' 33" West 238.02 feet along said centerline;  
 thence South 00° 43' 50" East 123.35 feet along said centerline;  
 thence 65.67 feet on the arc of a curve to the right with a radius of 600.00 feet and a long chord bearing South 02° 24' 19" West 65.64 feet along said centerline;  
 thence 343.10 feet on the arc of a curve to the left with a radius of 1005.41 feet and a long chord bearing South 04° 14' 07" East 341.44 feet;  
 thence South 14° 00' 42" East 58.07 feet along said centerline;  
 thence 230.92 feet on the arc of a curve to the right with a radius of 350.00 feet and a long chord bearing South 04° 53' 20" West 226.75 feet along said centerline to a point in the intersection of Tower Road and Pine Knob Road, said point being the terminus point.

**SURVEYOR'S CERTIFICATE:**

I, Aaron J. Austin, Professional Wisconsin Land Surveyor, hereby certify:  
 That the above description was surveyed and mapped as shown on this plat by me or under my direct supervision and field work was completed on 8-23-2021.

That this survey was prepared under the instructions of Judy Boughton, Town of Marion,  
 That this survey complies with Chapter A-E 7 of the Wisconsin Administrative Code and to the best of my knowledge and belief, this plat is an accurate representation thereof.

That all plans that do not show a seal imprint in red ink may contain unauthorized alterations.  
 The certification contained on this document shall not apply to any copies.

Dated this 26th day of August, 2021.

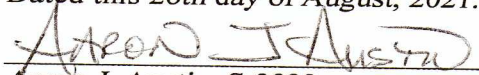
  
 Aaron J. Austin, S-2922

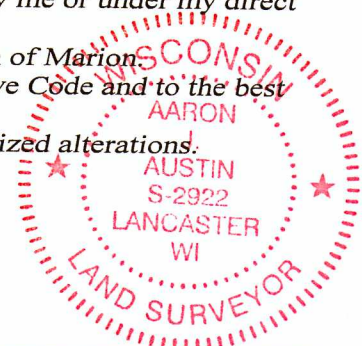

**Austin Engineering LLC**  
 austinengineeringllc.com

4211 HWY 81 E, LANCASTER, WI 53813  
 PHONE: 608-723-6363 FAX: 608-723-6702

Prepared for: **MARION TOWNSHIP**

JOB NO: 21S055  
 H:\CRD\21S055  
 H:\PLAT\T7NR3W\15\21S055-MARION TWP

FIELDBOOK: TDSR  
 DRAWN BY: AJ AUSTIN  
 CREW: OWEN AUSTIN  
 SHEET 2 OF 2