

LEGEND

- ⊙ Section Corner
- 3/4" rebar found
- △ 1" diameter iron pipe found
- ⊙ 5/8" x 18" rebar set with cap
- ⊙ Septic vent
- ⊙ Utility pole
- ⊙ Underground utility pedestal
- () Recorded as
- [] Property described in Document Number, Grant County Registry
- Boundary of Survey
- - - Section line
- - - Centerline
- - - Platted/described line
- - - Previously surveyed line
- - - Retaining Wall
- - - Existing Improvement
- - - Centerline Railroad track
- - - Existing fence

NORTH

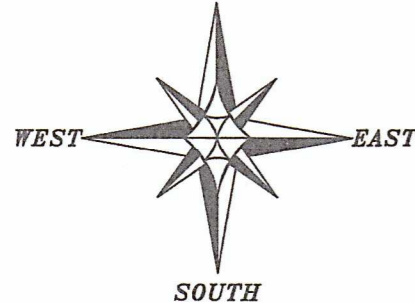

SOUTH

The West line of the NW 1/4 of Section 13 bears S 01°02'53" E according to the Grant County Coordinate System WISCORS NAD 83 (2011) which was determined by G.P.S. observation.

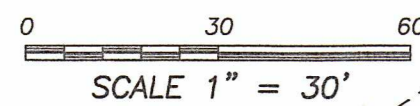

NORTHWEST CORNER SECTION 13, T7N R4W
2" iron pipe found

PREVIOUS SURVEY BY LARRY AUSTIN DATED 6-3-1999 BOOK 5, PAGE 70

TRACT 1 PREVIOUS SURVEY BY AARON AUSTIN DATED 10-31-2013 BOOK 34, PAGE 65

TRACT 1 PREVIOUS SURVEY BY AARON AUSTIN DATED 10-31-2013 BOOK 34, PAGE 65

SURVEYOR'S CERTIFICATE:
I, Aaron J. Austin, Professional Wisconsin Land Surveyor, hereby certify: That the descriptions hereon were surveyed, mapped and monumented as shown on this plat by me or under my direct supervision and the fieldwork was completed on 6-24-2021. That this survey was prepared under the instructions of Penny Heisz. That this survey complies with Chapter A-E 7 of the Wisconsin Administrative Code and to the best of my knowledge and belief, this plat is an accurate representation thereof. That all plans that do not show a seal imprint in red ink may contain unauthorized alterations. The certification contained on this document shall not apply to any copies. Dated this 21st day of July, 2021.

Aaron J. Austin
Aaron J. Austin, S-2922

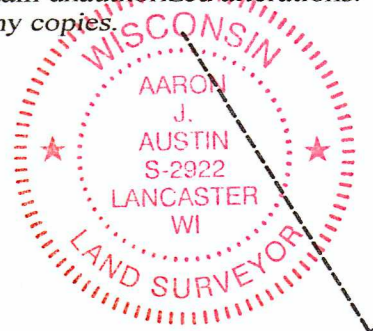

TRACT 1 DESCRIPTION:
Lots Three (3), Four (4), Five (5) and Six (6), of Block Ten (10) of the Original Plat, Village of Woodman and part of the Northwest Quarter (NW 1/4) of the Northwest Quarter (NW 1/4) of Section Thirteen (13), Township Seven (7) North, Range Four (4) West of the 4th P.M., Grant County, Wisconsin and being described as follows:

Commencing at the Northwest corner of said Section 13; thence South 01° 02' 53" East 548.17 feet along the West line of said Section to the point of beginning; thence South 01° 02' 53" East 5.36 feet along the West line of said Section; thence North 56° 38' 30" East 127.84 feet along a line of that property as described in Document Number 717264, Grant County Registry; thence South 31° 50' 12" East 48.79 feet to the Southeasterly corner of said Lot 3; thence South 58° 09' 48" West 200.00 feet along the Southerly line of said Block 10 to the Southwesterly corner of said Lot 6; thence North 31° 50' 12" West 50.00 feet along the Westerly line of said Lot 6; thence North 58° 09' 48" East 74.95 feet along the Northerly line of said Lot 6 to the point of beginning.

TRACT 2 DESCRIPTION:
Lots One (1) and Two (2) of Block Ten (10) of the Original Plat, Village of Woodman and part of the Northwest Quarter (NW 1/4) of the Northwest Quarter (NW 1/4) of Section Thirteen (13), Township Seven (7) North, Range Four (4) West of the 4th P.M., Grant County, Wisconsin and being described as follows:

Commencing at the Northwest corner of said Section 13; thence South 01° 02' 53" East 548.17 feet along the West line of said Section; thence continuing South 01° 02' 53" East 5.36 feet along the West line of said Section; thence North 56° 38' 30" East 127.84 feet along a line of that property as described in Document Number 717264, Grant County Registry to the point of beginning; thence South 31° 50' 12" East 48.79 feet to the Southwesterly corner of said Lot 2; thence North 58° 09' 48" East 100.00 feet along the Southerly line of said Block 10 to the Southeasterly corner of said Lot 1; thence North 31° 50' 12" West 51.44 feet along the East line of said Lot 1 and it's projection thereof; thence South 56° 38' 30" West 100.04 feet along a line as described in said Document Number 717264 to the point of beginning.

TRACT 3 DESCRIPTION:
Lot 5 in Block 11, Original Plat of the Village of Woodman, Grant County, Wisconsin.

PLAT OF SURVEY
PREPARED FOR: PAULA RIDER
LOCATED IN SECTIONS 13 AND 14, T7N R4W,
VILLAGE OF WOODMAN, GRANT COUNTY, WISCONSIN

Austin Engineering LLC
austineengineeringllc.com
4211 HWY 81 E
LANCASTER, WI 53813
PHONE 608-723-6363
FAX 608-723-6702

JOB NO: 215146
H:\CRD\215146
H:\PLAT\WOODMAN\215146-RIDER
FIELDBOOK: TDSR
DRAWN BY: AJ AUSTIN
CREW: SHANE AUSTIN
SHEET 1 OF 1

JUL 27 2021 17:01