



46099

# PLAT OF SURVEY

### PROPOSED EASEMENT DESCRIPTION:

A Thirty foot (30') wide access easement for ingress-egress which is located in the Northwest Quarter (NW 1/4) of the Northwest Quarter (NW 1/4), the Northeast Quarter (NE 1/4) of the Northwest Quarter (NW 1/4), the Southeast Quarter (SE 1/4) of the Northwest Quarter (NW 1/4) and the Southwest Quarter (SW 1/4) of the Northwest Quarter (NW 1/4) of Section Twenty-seven (27), Township Five (5) North, Range Six (6) West of the 4th P.M., Town of Bloomington, Grant County, Wisconsin, said easement being located 15 feet on each side of the the following described centerline:

Commencing at the Northwest corner of said Section 27;  
thence North 89° 44' 49" East 1170.62 feet along the North line of said Section;  
thence South 00° 15' 11" East 1410.92 feet to a point in the centerline of County Highway "A", said point being the point of beginning;  
thence North 76° 55' 12" East 12.98 feet;  
thence 46.72 feet on the arc of a curve to the left with a radius of 40.00 feet and a long chord bearing North 43° 27' 35" East 44.11 feet;  
thence North 09° 59' 58" East 149.59 feet;  
thence 62.13 feet on the arc of a curve to the right with a radius of 30.00 feet and a long chord bearing North 69° 19' 42" East 51.61 feet;  
thence 61.94 feet on the arc of a curve to the right with a radius of 134.80 feet and a long chord bearing South 38° 10' 48" East 61.39 feet;  
thence South 25° 01' 02" East 116.41 feet;  
thence 128.90 feet on the arc of a curve to the left with a radius of 300.00 feet and a long chord bearing South 37° 19' 33" East 127.91 feet;  
thence 43.56 feet on the arc of a curve to the left with a radius of 62.32 feet and a long chord bearing South 69° 39' 27" East 42.68 feet;  
thence South 89° 40' 50" East 60.29 feet;  
thence 43.75 feet on the arc of a curve to the left with a radius of 25.00 feet and a long chord bearing North 40° 11' 24" East 38.37 feet;  
thence North 09° 56' 21" West 67.77 feet;  
thence 39.87 feet on the arc of a curve to the right with a radius of 200.00 feet and a long chord bearing North 04° 13' 41" West 39.81 feet;  
thence North 01° 28' 59" East 87.12 feet;  
thence 18.87 feet on the arc of a curve to the left with a radius of 65.00 feet and a long chord bearing North 06° 50' 08" West 18.81 feet;  
thence North 15° 09' 14" West 67.21 feet;  
thence 16.80 feet on the arc of a curve to the left with a radius of 50.00 feet and a long chord bearing North 24° 46' 41" West 16.72 feet;  
thence North 34° 08' 29" West 48.89 feet;  
thence 26.17 feet on the arc of a curve to the right with a radius of 50.00 feet and a long chord bearing North 19° 08' 42" West 25.88 feet;  
thence North 04° 08' 54" West 114.09 feet to the North line of Lot 1 of Certified Survey Map Number 208 which is recorded as Document Number 497466, Grant County Registry, said point being the terminus point.

### EASEMENT NOTES:

Other documentation will need to be recorded to clarify the intent, use, maintenance, assignments or other pertinent information of this easement.

### SURVEYOR'S CERTIFICATE:

I, Aaron J. Austin, Professional Wisconsin Land Surveyor, hereby certify:

That the above description was surveyed and mapped as shown on this plat by me or under my direct supervision and field work was completed on 4-27-2021.

That this survey was prepared under the instructions of Mike Redman.

That this survey complies with Chapter A-E 7 of the Wisconsin Administrative Code and to the best of my knowledge and belief, this plat is an accurate representation thereof.

That all plans that do not show a seal imprint in red ink may contain unauthorized alterations.

The certification contained on this document shall not apply to any copies.

Dated this 30th day of June, 2021.

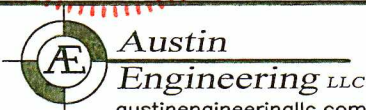
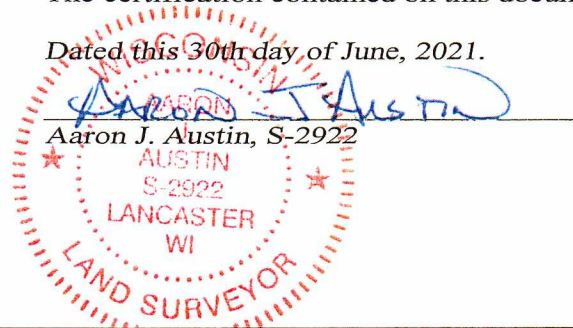

4211 HWY 81 E, LANCASTER, WI 53813  
PHONE: 608-723-6363 FAX: 608-723-6702

Prepared for: WILDWOOD PARTNERSHIP

JOB NO: 20S243  
H:\CRD\20S243  
H:\PLAT\T5NR6W\27\20S243-WILDWOOD

FIELDBOOK: TDSR  
DRAWN BY: AJ AUSTIN  
CREW: SHANE AUSTIN