



# PLAT OF SURVEY

## DESCRIPTION:

Located in the Northeast Quarter (NE 1/4) of the Southwest Quarter (SW 1/4), the Southeast Quarter (SE 1/4) of the Southwest Quarter (SW 1/4), the Northwest Quarter (NW 1/4) of the Southeast Quarter (SE 1/4), and in the Southwest Quarter (SW 1/4) of the Southeast Quarter (SE 1/4) of Section Twenty-two (22), Town Four (4) North, Range Four (4) West of the 4th P.M., Town of Beetown, Grant County, Wisconsin, containing 103.65 Acres, more or less, and being described as follows:

Commencing at an Aluminum Capped rebar marking the South Quarter (S 1/4) corner of said Section Twenty-two (22), said corner being the point of beginning;  
 thence South 89° 59' 28" East 87.06 feet to a 3/4" rebar in the centerline of a township road known as Porter Bridge Road;  
 thence North 228.33' on the arc of a curve to the right with a radius of 413.29 feet and a long chord bearing North 07° 16' 57" West 225.43 feet to a 3/4" rebar in said centerline;  
 thence North 08° 32' 39" East 303.73 feet to a 3/4" rebar in said centerline;  
 thence North 12° 03' 33" East 153.37 feet to a 3/4" rebar in said centerline;  
 thence North 19° 17' 34" East 149.96 feet to a Mag Nail in said centerline;  
 thence North 18° 53' 29" East 245.81 feet to a Mag Nail in said centerline;  
 thence North 84° 20' 14" West 263.35 feet to a 5/8" rebar being a meander corner located North 84° 20' 14" West 83± of the centerline of the Grant River;  
 thence North 22° 38' 35" East 825.41 feet along the Westerly meander line of the Grant River to a 5/8" rebar;  
 thence North 03° 39' 01" West 413.33 feet along said meander line to a 5/8" rebar;  
 thence North 40° 47' 37" East 564.44' along said meander line to a 5/8" rebar being located South 89° 50' 54" West 386± feet from the centerline of the Grant River which is on the East - West Quarter (E-W 1/4) line of said Section Twenty-two (22);  
 thence South 89° 50' 54" West 2097.25 feet along said East-West Quarter (E-W 1/4) line to the Northwest corner of the East Half (E 1/2) of the Southwest Quarter (SW 1/4) of said Section Twenty-two (22);  
 thence South 02° 33' 52" East 2672.56 feet along the West line of the East Half (E 1/2) of the Southwest Quarter (SW 1/4) of said Section Twenty-two (22) to the Southwest corner thereof;  
 thence South 89° 59' 28" East 1314.71 feet along the South line of the Southwest Quarter (SW 1/4) of said Section Twenty-two (22) to the point of beginning, including all lands between the above described meander line and the centerline of the Grant River.  
 Being subject to any and all easements of record and/or usage.

## SURVEYOR'S CERTIFICATE:

I, Aaron J. Austin, Professional Wisconsin Land Surveyor, hereby certify:

That the above description was surveyed, mapped and monumented as shown on this plat by me or under my direct supervision and field work was completed on 3-10-2021.  
 That this survey was prepared under the instructions of Tim Duncan.  
 That this survey complies with Chapter A-E 7 of the Wisconsin Administrative Code and to the best of my knowledge and belief, this plat is an accurate representation thereof.  
 That all plans that do not show a seal imprint in red ink may contain unauthorized alterations.  
 The certification contained on this document shall not apply to any copies.

Dated this 11th day of March, 2021.

  
 Aaron J. Austin, S-2922

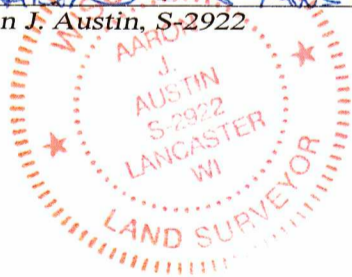

## LEGEND

- |                                 |                                |
|---------------------------------|--------------------------------|
| ⊕ Section Corner—as designated  | — — — — — Meander line         |
| ○ 3/4" rebar found              | ————— Boundary of Survey       |
| ● 5/8" x 18" rebar set with cap | ----- Section line             |
| ⊙ Mag Nail Set                  | ----- Centerline               |
| mc Meander corner               | ----- 33' Right of Way         |
| ( ) Recorded as                 | ----- Previously surveyed line |
|                                 | -x-x-x- Existing fence         |



**Austin**  
**Engineering LLC**  
 austinengineeringllc.com

4211 HWY 81 E, LANCASTER, WI 53813  
 PHONE: 608-723-6363 FAX: 608-723-6702

Prepared for: **TIM DUNCAN**

JOB NO: 21S029  
 H:\CRD\21S029-DUNCAN  
 H:\PLAT\T4NR4W\22\21S029-DUNCAN

FIELDBOOK: TDSR  
 DRAWN BY: SW AUSTIN  
 CREW: SW AUSTIN

SHEET 2 OF 2