

45085

# PLAT OF SURVEY RETRACEMENT

OF  
A PARCEL OF LAND DESCRIBED IN A WARRANTY DEED RECORDED IN VOLUME 404, PAGE 194 IN THE GRANT COUNTY, WISCONSIN, REGISTER OF DEEDS OFFICE:  
This retracement survey is being prepared to correct errors in the original parcel description that caused the parcel to be mapped Southerly of where it actually exists on the ground. The parcel is correctly described as follows:

Being part of the Southwest 1/4 of the Southeast 1/4 of Section 25, Township 1 North, Range 1 West, Hazel Green Township, Grant County, Wisconsin,  
Commencing at the Southeast corner of Section 25, Township 1 North, Range 1 West, Hazel Green Township, Grant County, Wisconsin; thence North 89° 27' 12" West coincident with the South line of the Southeast 1/4 of Section 25, a distance of 1990.02 feet; thence North 0° 32' 48" East, 623.77 feet to the center of right of way of State Trunk Highway 80, also being the point of beginning; thence North 15° 58' 04" East coincident with said center of right of way, 49.15 feet to a point of curve; thence Northerly on a curve to the left an arc distance of 135.30 feet, said curve having a radius of 1910.00 feet, a central angle of 4° 03' 31", and a long chord that bears North 13° 56' 19" East, 135.27 feet; thence South 80° 33' 54" West, 203.80 feet to a 1-1/4 inch diameter steel pipe found; thence South 14° 35' 54" West, 129.82 feet; thence South 84° 04' 06" East, 188.67 feet to the point of beginning.  
The above described parcel contains 0.68 acres.

**SURVEYOR'S CERTIFICATE:**  
I, Wyatt B. Anderson, Professional Land Surveyor, hereby certify:  
That I was instructed to prepare this survey of the above described land by Richard Bodell and Susan Anderson.  
That this survey was made and prepared under my direction and control.  
That this survey is correct to the best of my knowledge and belief.

Signed and sealed this 11<sup>TH</sup> day of NOVEMBER, 2020.  
*Wyatt B. Anderson*  
Wyatt B. Anderson, S-2929

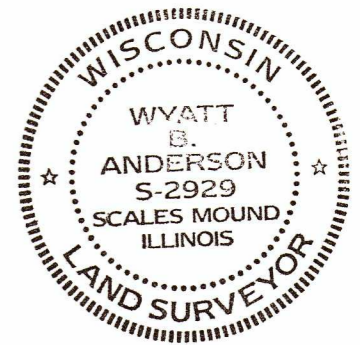

FIELD WORK COMPLETED ON NOVEMBER 7, 2020  
DRAFTING OF PLAT COMPLETED ON NOVEMBER 11, 2020

**WYATT B. ANDERSON**  
LICENSED PROFESSIONAL  
LAND SURVEYOR

510 South Avenue  
Scales Mound, Illinois 61075  
Phone: 815-275-9633  
e-mail: wyattbanderson@gmail.com

---

**SURVEYED FOR** **JOB #20078**  
**THE ESTATE OF MONA I. BODELL**

