

PLAT OF SURVEY

DESCRIPTIONS SURVEYED:

Lot Six (6) of Covell's Addition to the Village (now City) of Platteville, Grant County, Wisconsin, according to the recorded map or plat thereof.

ALSO:

TRACT 1 DESCRIPTION:

Commencing at a Stone monument marking the North Quarter (N 1/4) corner of Section Fifteen (15), Township Three (3) North, Range One (1) West of the 4th P.M., City of Platteville, Grant County, Wisconsin;
thence South 15° 44' 44" West 260.42 feet to the Northwest corner of Lot 6 of Covell's Addition to the City of Platteville;
thence South 73° 44' 50" East 76.00 feet along the North line of said Lot 6 to the Northwest corner of that property as described in Document Number 532500, Grant County Registry, said corner being the point of beginning;
thence continuing South 73° 44' 50" East 11.08 feet;
thence South 08° 08' 13" West 61.68 feet to the West line of said property described in Document Number 532500;
thence North 01° 42' 12" West 64.18 feet along said West line to the point of beginning.
The above described land being a part of Lot Two (2) of Block Twenty-six (26) of the Assessment Plat of the City of Platteville, Grant County, Wisconsin.

SURVEYOR'S CERTIFICATE:

I, Aaron J. Austin, Professional Wisconsin Land Surveyor, hereby certify:

That the above descriptions were surveyed, mapped and monumented as shown on this plat by me or under my direct supervision and field work completed on 10-14-2020.
That this survey was prepared under the instructions of William Dolphin.
That this survey complies with Chapter A-E 7 of the Wisconsin Administrative Code and to the best of my knowledge and belief, this plat is an accurate representation thereof.
That all plans that do not show a seal imprint in red ink may contain unauthorized alterations.
The certification contained on this document shall not apply to any copies.

Dated this 15th day of October, 2020.

Aaron J. Austin
Aaron J. Austin, S-2922

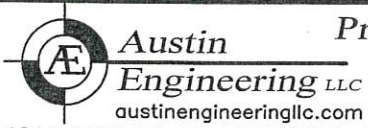
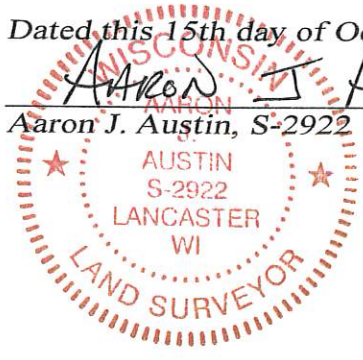

Prepared for: WILLIAM DOLPHIN

4211 HWY 81 E, LANCASTER, WI 53813
PHONE: 608-723-6363 FAX: 608-723-6702

JOB NO: 20S164
H:\CRD\20S164
H:\PLAT\PVILLE\COVELL'S ADDN\20S164-DOLPHIN

FIELDBOOK: TDSR
DRAWN BY: AJ AUSTIN
CREW: S. AUSTIN, O. AUSTIN