

RECEIVED

45063

By Land Information Office at 1:44 pm, Sep 18, 2020

INZW (21)

VOSBERG / HINDERMAN

DESCRIPTION: (OF 15' WIDE PARCEL)

A FIFTEEN FOOT WIDE PARCEL OF LAND DESCRIBED AS FOLLOWS:

PART OF THE SOUTHWEST QUARTER (SW1/4) OF THE SOUTHWEST QUARTER (SW1/4) OF SECTION 21, TOWN 1 NORTH, RANGE 2 WEST, OF THE 4TH P.M., GRANT COUNTY, WISCONSIN, DESCRIBED AS FOLLOWS,

TO-WIT: BEGIN AT THE WEST QUARTER CORNER OF SAID SECTION 21;

- THENCE A RECORDED DIST. AND BEARING SOUTH 79.75 FEET,
- THENCE " " " " " S 68° 00' W 158.40';
- THENCE " " " " " S 11° 15' W 209.88';
- THENCE " " " " " S 08° 00' E 634.26';
- THENCE " " " " " S 14° 07' E 642.18';
- THENCE " " " " " S 02° 31' E 285.50';
- THENCE " " " " " N 87° 29' E 173.20';
- THENCE " " " " " S 14° 32' E 368.76';
- THENCE " " " " " N 55° 11' E 700.54';

THENCE N 71° 22' E 443.35' TO THE POINT OF BEGINNING;

THENCE N 71° 22' E 15.58';

THENCE N 02° 57' W 156.08';

THENCE S 65° 36' W 16.12';

THENCE S 02° 57' E 154.40' TO THE POINT OF BEGINNING

CONTAINING 2330 SQUARE FEET, MORE OR LESS, AND BEING SUBJECT TO ANY AND ALL EASEMENTS OF RECORD.

SURVEYOR'S CERTIFICATE: I, LARRY L. AUSTIN, REGISTERED WISCONSIN LAND SURVEYOR DO HEREBY CERTIFY THAT THE ABOVE DESCRIPTION WAS PREPARED BY ME OR UNDER MY DIRECT SUPERVISION, IN ACCORDANCE WITH THE INSTRUCTIONS OF W. PHIL KARRMANN, AND TO THE BEST OF MY KNOWLEDGE AND BELIEF, THIS DESCRIPTION IS AN ACCURATE REPRESENTATION THEREOF.

*Larry L. Austin*  
 LARRY L. AUSTIN RLS 1903  
 LARRY AUSTIN ENGINEERING  
 RT. 2  
 LANCASTER, WI 53813  
 PHONE (608) 723-6363

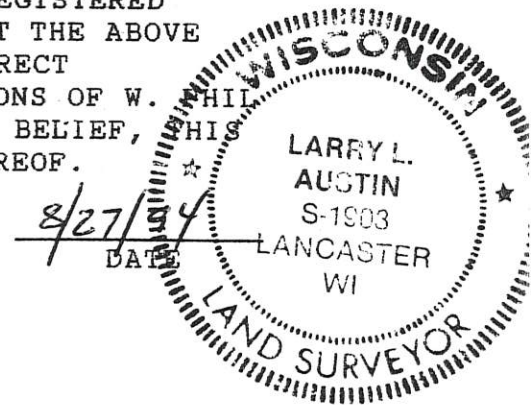

I, W. PHIL KARRMANN, HEREBY REQUEST THAT NO MONUMENTATION BE PLACED IN CONJUNCTION WITH THIS DESCRIPTION.

\_\_\_\_\_  
W. PHIL KARRMANN

\_\_\_\_\_  
DATE