

450A2

PLAT OF SURVEY

TRACT 1 DESCRIPTION:

Located in the Southeast Quarter (SE 1/4) of the Southwest Quarter (SW 1/4) of Section Twenty-six (26) and the Northwest Quarter (NW 1/4) of the Northwest Quarter (NW 1/4), the Northeast Quarter (NE 1/4) of the Northwest Quarter (NW 1/4) and the Southeast Quarter (SE 1/4) of the Northwest Quarter (NW 1/4) of Section Thirty-five (35), Township Five (5) North, Range Five (5) West of the 4th P.M., Town of Bloomington, Grant County, Wisconsin, containing 66.12 acres, more or less, and being described as follows:

Commencing at the North Quarter (N 1/4) corner of said Section 35, said corner being the point of beginning;

thence South 00° 22' 05" East 1345.79 feet along the North-South Quarter (N-S 1/4) line of said Section;

thence North 88° 44' 45" West 440.13 feet;

thence South 00° 22' 05" East 167.96 feet;

thence South 89° 57' 17" West 886.03 feet to the West line of the Southeast Quarter (SE 1/4) of the Northwest Quarter (NW 1/4);

thence North 00° 25' 55" West 180.38 feet along said West line to the Northwest corner thereof;

thence South 89° 57' 17" West 663.10 feet along the South line of the Northwest Quarter (NW 1/4) of the Northwest Quarter (NW 1/4) of said Section 35;

thence North 00° 27' 50" West 1320.60 feet along the West line of the East Half (E 1/2) of the Northwest Quarter (NW 1/4) of said Northwest Quarter (NW 1/4) to the Northwest corner thereof;

thence North 89° 52' 26" East 663.83 feet along the North line of said Section 35 to the Northeast corner of the Northwest Quarter (NW 1/4) of said Northwest Quarter (NW 1/4);

thence North 00° 15' 01" East 112.30 feet along the West line of the Southeast Quarter (SE 1/4) of the Southwest Quarter (SW 1/4) of said Section 26 to a point in the centerline of a township road known as Spruce Road;

thence North 62° 02' 40" East 199.67 feet along said centerline;

thence 161.97 feet on the arc of a curve to the left with a radius of 285.00 feet and a long chord bearing North 45° 45' 50" East 159.80 feet along said centerline;

thence North 29° 28' 59" East 63.53 feet along said centerline;

thence 136.69 feet on the arc of a curve to the left with a radius of 1500.00 feet and a long chord bearing North 26° 52' 21" East 136.65 feet along said centerline;

thence South 11° 53' 00" East 47.92 feet along the centerline of a township road known as North Road;

thence 58.88 feet on the arc of a curve to the right with a radius of 112.19 feet and a long chord bearing South 03° 09' 09" West 58.21 feet along said centerline;

thence 276.82 feet on the arc of a curve to the left with a radius of 1726.99 feet and a long chord bearing South 13° 35' 47" West 276.52 feet along said centerline;

thence 44.21 feet on the arc of a curve to the left with a radius of 85.00 feet and a long chord bearing South 05° 53' 51" East 43.72 feet along said centerline;

thence South 20° 47' 58" East 81.85 feet to a point on the North line of said Section 35;

thence North 89° 52' 26" East 968.05 feet along the North line of said Section 35 to the point of beginning.

Tract being subject to any and all easements of record and/or usage.

TRACT 2 DESCRIPTION:

The Southwest Quarter (SW 1/4) of the Northeast Quarter (NE 1/4) of Section Thirty-five (35), Township Five (5) North, Range Five (5) West of the 4th P.M., Town of Bloomington, Grant County, Wisconsin.

SURVEYOR'S CERTIFICATE:

I, Aaron J. Austin, Professional Wisconsin Land Surveyor, hereby certify:

That the above descriptions were surveyed, mapped and monumented as shown on this plat by me or under my direct supervision and field work was completed on 9-28-2020.

That this survey was prepared under the instructions of Joanne Bark.

That this survey complies with Chapter A-E 7 of the Wisconsin Administrative Code and to the best of my knowledge and belief, this plat is an accurate representation thereof.

That all plans that do not show a seal imprint in red ink may contain unauthorized alterations.

The certification contained on this document shall not apply to any copies.

Dated this 29th day of September, 2020.

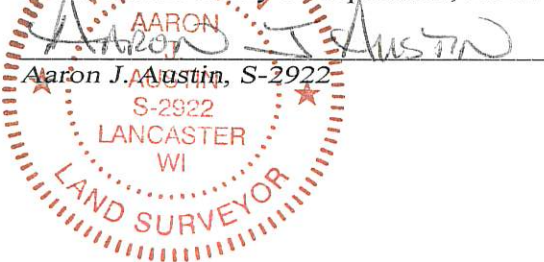

Austin
Engineering LLC
austinengineeringllc.com

4211 HWY 81 E, LANCASTER, WI 53813
PHONE: 608-723-6363 FAX: 608-723-6702

Prepared for: JOANNE BARK

JOB NO: 20S148
H:\CRD\20S148
H:\PLAT\T5NR5W\35\20S148-WEGMULLER

FIELDBOOK: TDSR
DRAWN BY: AJ AUSTIN
CREW: S. AUSTIN, O. AUSTIN