

45021

H:\PLAT\T4NR3W\04\20S129-CULBERTSON

PLAT OF SURVEY

Prepared for: GARRY & KAREN PLUEMER

Southwest Corner
C.S.M. No. 1846

LOT 2
C.S.M. NO. 1846

PREVIOUS SURVEY
BY HOMER RALPH JR
DATED 6-27-1968
BOOK E, PAGE 144

EAST 1/4 CORNER
SECTION 4, T4N R3W
1" Rebar and ties found

LEGEND

- ⊙ Section Corner
- 3/4" x 18" rebar set with cap
- 3/4" rebar found
- ⊖ 5/8" rebar found
- △ 1" diameter iron pipe found
- ⊕ Existing utility pole
- () Recorded as
- [] Property described in Document Number, Grant County Registry
- Boundary of Survey
- - - Centerline
- - - Previously described line
- - - Previously surveyed line
- ▨ Existing structure
- - - Existing improvement
- - - Occupied line
- x - x Existing fence

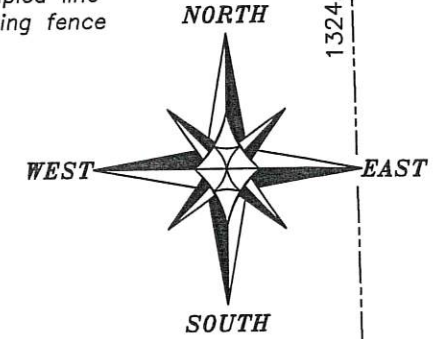

The East line of the SE 1/4 of Section 4 bears S 01°10'05" E according to the Grant County Coordinate System WISCORS NAD 83 (2011) which was determined by G.P.S. observation.

SOUTHEAST CORNER
NE 1/4, SE 1/4

(WEST) (180')
N 89°42'02" W 172.77'

PREVIOUS SURVEY
BY JIMMY ROSE
DATED 11-12-2012
BOOK 32, PAGE 45

East line Survey
Book 32, Page 45
(Previously surveyed
and accepted line)

[658992]
1.11± ACRE
48,412± SQ.FT.

WILSON STREET

CHERRY STREET

(N 89°52'14" E) (126.50')
N 89°04'50" E 126.50'

PREVIOUS SURVEY
BY HOMER RALPH JR.
DATED 12-3-1968
BOOK E, PAGE 140

PREVIOUS SURVEY
BY LARRY AUSTIN
DATED MAY 21, 2009
BOOK 25, PAGE 9

PART OF [615361]

WISCONSIN
AARON J. AUSTIN
AUSTIN ENGINEERING LLC
PLAT SURVEY

ALL PLANS THAT DO NOT SHOW A SEAL IMPRINT IN RED INK MAY CONTAIN UNAUTHORIZED ALTERATIONS. THE CERTIFICATION CONTAINED ON THIS DOCUMENT SHALL NOT APPLY TO ANY COPIES. DATED: 7-29-2020.

0 50 100

SCALE 1" = 50'

Austin Engineering LLC
austinengineeringllc.com

4211 HWY 81 E, LANCASTER, WI 53813
PHONE: 608-723-6363 FAX: 608-723-6702

SHEET 1 OF 2

PLAT OF SURVEY

DESCRIPTION PROVIDED: Property described in Document Number 658992, Grant County Registry and being described as follows:

A part of the East Half (E.1/2) of the Northeast Quarter (N.E.1/4) of the Southeast Quarter (S.E.1/4) of Section Four (4) in Township Four (4) North, Range Three (3) West of the 4th P.M., Grant County, Wisconsin, described as follows:

Commencing at a point which lies from the Southeast corner of said tract 360 feet West and 50 feet North, which point is at the Northeast corner of a certain tract of land conveyed by R.B. Showalter and wife, to Phineas Walker in a certain deed recorded in Volume 123 of Deeds, page 573;

thence running North 158 feet 4 inches;

thence West 300 feet to the West line of said 20 acre tract

thence South 158 feet 4 inches;

thence East 300 feet to the place of beginning.

SURVEYOR'S CERTIFICATE:

I, Aaron J. Austin, Professional Wisconsin Land Surveyor, hereby certify:

That the above descriptions were surveyed, mapped and monumented as shown on this plat by me or under my direct supervision and field work was completed on 7-28-20.

That this survey was prepared under the instructions of Scott Culbertson.

That this survey complies with Chapter A-E 7 of the Wisconsin Administrative Code and to the best of my knowledge and belief, this plat is an accurate representation thereof.

That all plans that do not show a seal imprint in red ink may contain unauthorized alterations.

The certification contained on this document shall not apply to any copies.

Dated this 29th day of July, 2020.

 Aaron J. Austin, S-2922

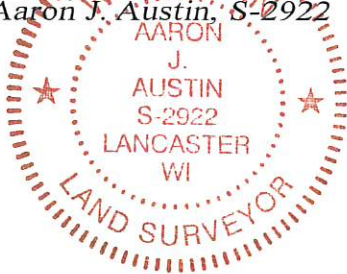

Austin Prepared for: GARRY & KAREN PLUEMER
 Engineering LLC

austinengineeringllc.com

4211 HWY 81 E, LANCASTER, WI 53813

PHONE: 608-723-6363 FAX: 608-723-6702

JOB NO: 20S129

H:\CRD\20S129

H:\PLAT\T4NR3W\04\20S129-PLUEMER

FIELDBOOK: TDSR

DRAWN BY: AJ AUSTIN

CREW: OWEN AUSTIN

SHEET 2 OF 2