

FEB 10 2020 44064

GRANT COUNTY PLAT OF SURVEY

BEING A SURVEY OF THE NORTH LINE OF THE SOUTHWEST QUARTER OF THE NORTHWEST QUARTER AND PART OF THE NORTH LINE OF THE SOUTHEAST QUARTER OF THE NORTHWEST QUARTER ALL IN SECTION 15, TOWN 8 NORTH, RANGE 2 WEST, TOWNSHIP OF WATTERSTOWN, GRANT COUNTY, WISCONSIN

SURVEY PREPARED FOR:
MR. MIKE BARTELS
BARTELS FAMILY FARM, LLC
 3455 STUDENBERG ROAD
 BOSCOBEL, WI 53805

SURVEY PREPARED BY:
 SEAN M WALSH, PLS 2016
WALSH **SURVEYING - MAPPING**
GEOMATICS, LLC PO BOX 486, RICHLAND CENTER, WI 53581
 608-383-1501 (O) 608-347-9307 (M) www.walshgeomatics.com

I SEAN M. WALSH, WISCONSIN PROFESSIONAL LAND SURVEYOR DO HEREBY CERTIFY THAT:
 I HAVE MADE THIS SURVEY UNDER THE DIRECTION OF MIKE BARTELS, AGENT FOR BARTELS FAMILY FARM, LLC, OWNER;
 THIS SURVEY IS IN FULL COMPLIANCE WITH THE PROVISIONS OF CHAPTER A-E 7 OF THE WISCONSIN ADMINISTRATIVE CODE;
 THE INFORMATION SHOWN HEREON IS CORRECT TO THE BEST OF MY INFORMATION, KNOWLEDGE AND BELIEF.
 FIELD WORK COMPLETED ON 12/16/19

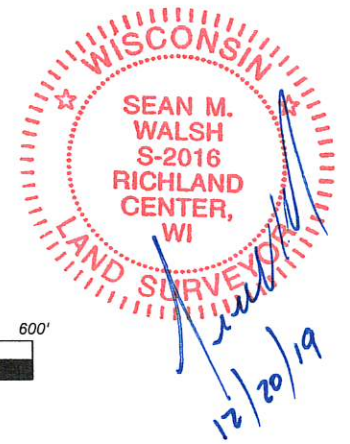

BASIS OF BEARINGS AND ORIENTATION:
 GRANT COUNTY COORDINATES
 NAD 83 (2011) WEST LINE OF THE
 NORTHWEST QUARTER SECTION 15,
 T8N, R2W DETERMINED TO BEAR
 N00°27'42"W

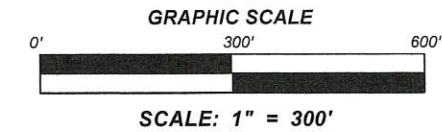

LEGEND:

- ⊗ --- INDICATES 1.2" OD IRON PIPE FOUND
- ⊠ --- INDICATES MAG SPIKE PLACED ON CENTERLINE OF STUDENBERG ROAD BY SPLIT OF PAVEMENT
- --- INDICATES 3/4" X 18" IRON REBAR, WEIGHT 1.5 LBS/FT PLACED BY THIS SURVEY
- (000.00) --- DIMENSIONS IN PARENTHESIS ARE AS PREVIOUSLY RECORDED / DESCRIBED
- x --- EXISTING FENCE

DESCRIPTION OF LINE SURVEYED:

BEING THE NORTH LINE OF THE SOUTHWEST QUARTER OF THE NORTHWEST QUARTER AND THE NORTH LINE OF THE SOUTHEAST QUARTER OF THE NORTHWEST QUARTER OF SECTION 15, TOWN 8 NORTH, RANGE 2 WEST, TOWNSHIP OF WATTERSTOWN, GRANT COUNTY, WISCONSIN LYING WEST OF STUDENBERG ROAD, MORE PARTICULARLY DESCRIBED AS FOLLOWS:

COMMENCING AT THE NORTHWEST CORNER OF SAID SECTION 15;
 THENCE SOUTH 00°27'42" WEST, ALONG THE WEST LINE OF SAID NORTHWEST QUARTER, 1306.975 FEET TO THE NORTHWEST CORNER OF THE SOUTHWEST QUARTER OF THE NORTHWEST QUARTER OF SECTION 15 AND THE POINT OF BEGINNING OF THE LINE HEREINAFTER DESCRIBED;

THENCE SOUTH 88°46'35" EAST, ALONG THE NORTH LINE OF SAID SOUTHWEST QUARTER OF THE NORTHWEST QUARTER AND THE NORTH LINE OF SAID SOUTHEAST QUARTER OF THE NORTHWEST QUARTER, 2157.60 FEET TO A POINT ON THE CENTERLINE OF STUDENBERG ROAD AND THE POINT OF TERMINATION OF THE LINE SUREYED AND MARKED HERE.

NOTE:

THE PURPOSE AND INTENT OF THIS SURVEY IS TO LOCATE AND MARK THE NORTH LINE OF THE SOUTH-HALF OF THE THE NORTHWEST QUARTER OF SECTION 15 LYING WEST OF STUDENBERG ROAD.

SECTION 15
T8N, R2W
WATTERSTOWN

