





# PLAT OF SURVEY

## TRACT 1 DESCRIPTION: (FINAL DESCRIPTION AFTER EXCHANGES)

Located in the Southwest Quarter (SW 1/4) of the Southwest Quarter (SW 1/4) of Section One (1), the Southeast Quarter (SE 1/4) of the Southeast Quarter (SE 1/4) of Section Two (2), the Northeast Quarter (NE 1/4) of the Northeast Quarter (NE 1/4) of Section Eleven (11) and in the Northwest Quarter (NW 1/4) of the Northwest Quarter (NW 1/4) of Section Twelve (12), Township Six (6) North, Range Three (3) West of the 4th P.M., Town of Mount Ida, Grant County, Wisconsin, containing 5.00 Acres, more or less, and being described as follows:

Commencing at the Northwest corner of said Section 12;  
thence South 00° 01' 21" East 102.05 feet along the West line of said Section 12 to the point of Beginning;  
thence North 86° 24' 32" East 262.29 feet;  
thence North 06° 05' 46" West 106.91 feet to a point in the centerline of a township road known as Plum Valley Road;  
thence 214.21 feet on the arc of a curve to the right with a radius of 750.00 feet and a long chord bearing North 76° 50' 45" West 213.48 feet along said centerline;  
thence North 68° 39' 50" West 99.79 feet along said centerline;  
thence 135.97 feet on the arc of a curve to the left with a radius of 2500.00 feet and a long chord bearing North 70° 13' 19" West 135.96 feet along said centerline;  
thence North 71° 46' 48" West 70.78 feet along said centerline;  
thence South 29° 13' 20" West 491.97 feet;  
thence South 73° 18' 07" East 507.26 feet to the East line of said Section 11;  
thence North 00° 01' 21" West 299.35 feet along the East line of said Section 11 to the point of beginning.  
Tract being subject to any and all easements of record and/or usage.

## TRACT 2 DESCRIPTION: (Arndt to Leffler)

Located in the Northwest Quarter (NW 1/4) of the Northwest Quarter (NW 1/4) of Section Twelve (12), Township Six (6) North, Range Three (3) West of the 4th P.M., Town of Mount Ida, Grant County, Wisconsin, containing 0.11 acre, more or less, and being described as follows:

Commencing at the Northwest corner of said Section 12;  
thence North 89° 43' 57" East 252.55 feet along the North line of said Section 12 to the point of beginning;  
thence South 06° 05' 46" East 73.21 feet;  
thence North 83° 59' 37" East 68.28 feet along a line of that property as described in Document Number 744786, Grant County Registry;  
thence North 00° 01' 21" West 66.00 feet along a line of said property to the North line of said Section 12;  
thence South 89° 43' 57" West 75.65 feet along the North line of said Section 12 to the point of beginning.  
Tract being subject to any and all easements of record and/or usage.

## TRACT 3 DESCRIPTION: (Leffler to Arndt)

Located in the Southwest Quarter (SW 1/4) of the Southwest Quarter (SW 1/4) of Section One (1), Township Six (6) North, Range Three (3) West of the 4th P.M., Town of Mount Ida, Grant County, Wisconsin, containing 0.26 acre, more or less, and being described as follows:

Commencing at the Southwest corner of said Section 1, said corner being the point of beginning;  
thence North 89° 43' 57" East 252.55 feet along the South line of said Section 1;  
thence North 06° 05' 46" West 19.62 feet to a point in the centerline of a township road known as Plum Valley Road;  
thence 214.21 feet on the arc of a curve to the right with a radius of 750.00 feet and a long chord bearing North 76° 50' 45" West 213.48 feet along said centerline;  
thence North 68° 39' 50" West 45.77 feet along said centerline to the West line of said Section 1;  
thence South 00° 01' 54" East 85.92 feet along the West line of said Section 1 to the point of beginning.  
Tract being subject to any and all easements of record and/or usage.

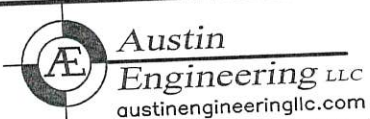
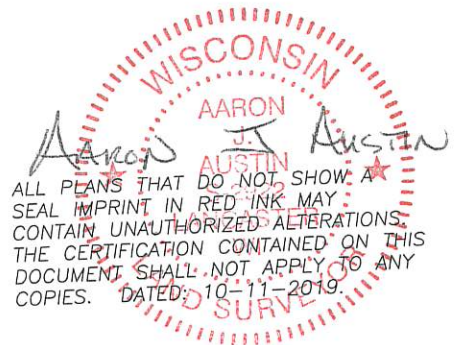

4211 HWY 81 E, LANCASTER, WI 53813  
PHONE: 608-723-6363 FAX: 608-723-6702

Prepared for: BOB ARNDT

JOB NO: 19S177  
H:\CRD\19S177  
H:\PLAT\T6NR3W\11\19S177-ARNDT

FIELDBOOK: TDSR  
DRAWN BY: AJ AUSTIN  
CREW: SHANE AUSTIN, O. AUSTIN  
SHEET 3 OF 4

44025

# PLAT OF SURVEY

**TRACT 4 DESCRIPTION:** (Leffler to Arndt)

Located in the Northwest Quarter (NW 1/4) of the Northwest Quarter (NW 1/4) of Section Twelve (12), Township Six (6) North, Range Three (3) West of the 4th P.M., Town of Mount Ida, Grant County, Wisconsin, containing 0.05 acre, more or less, and being described as follows:

Commencing at the Northwest corner of said Section 12;  
thence South 00° 01' 21" East 99.00 feet along the West line of said Section 12 to the point of beginning;  
thence North 83° 59' 37" East 261.72 feet along a line of that property as described in Document Number 744786, Grant County Registry;  
thence South 06° 05' 46" East 14.08 feet;  
thence South 86° 24' 32" West 262.29 feet to the West line of said Section 12;  
thence North 00° 01' 21" West 3.05 feet along the West line of said Section 12 to the point of beginning.

Tract being subject to any and all easements of record and/or usage.

**MONUMENTATION WAIVER:**

As client, I hereby certify that I caused the land described on this plat to be surveyed, divided and mapped as represented on this plat. I also certify that I hereby request to waive Chapter A-E 7.07 (Monuments) of the Wisconsin Administrative Code and request that the monuments for this survey be placed as shown hereon.

Dated this 14 day of October, 2019.

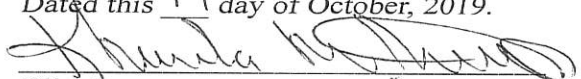
  
Client

**SURVEYOR'S CERTIFICATE:**

I, Aaron J. Austin, Professional Wisconsin Land Surveyor, hereby certify:

That the above description was surveyed, mapped and monumented as shown on this plat by me or under my direct supervision and the field work was completed on 10-10-2019.  
That this survey was prepared under the instructions of Bob Arndt.  
That this survey complies with Chapter A-E 7 of the Wisconsin Administrative Code and to the best of my knowledge and belief, this plat is an accurate representation thereof.  
That all plans that do not show a seal imprint in red ink may contain unauthorized alterations.  
The certification contained on this document shall not apply to any copies.

Dated this 11th day of October, 2019.

  
Aaron J. Austin, S-2922



4211 HWY 81 E, LANCASTER, WI 53813  
PHONE: 608-723-6363 FAX: 608-723-6702

Prepared for: BOB ARNDT

JOB NO: 19S177  
H:\CRD\19S177  
H:\PLAT\T6NR3W\11\19S177-ARNDT

FIELDBOOK: TDSR  
DRAWN BY: AJ AUSTIN  
CREW: SHANE AUSTIN, O. AUSTIN