

# PLAT OF SURVEY

Prepared for: GLEN HAVEN FIRE DEPARTMENT

### DESCRIPTION:

Located in the Southwest Quarter (SW 1/4) of the Northwest Quarter (NW 1/4) of Section Eighteen (18), Township Four (4) North, Range Five (5) West of the 4th P.M., Town of Glen Haven, Grant County, Wisconsin, containing 5.00 acres, more or less, and being described as follows:  
Commencing at the West Quarter (W 1/4) corner of said Section 18, said corner being the point of beginning;  
thence North 01° 45' 51" West 163.26 feet along the West line of said Section 18;  
thence North 01° 31' 56" West 199.70 feet along the West line of said Section 18;  
thence North 89° 30' 00" East 600.00 feet;  
thence South 01° 38' 12" East 362.96 feet to the South line of Lot 1 of Certified Survey Map Number 1297 recorded as Document Number 694465, Grant County Registry;  
thence South 89° 30' 00" West 600.00 feet along the South line of said Lot 1 to the point of beginning. Tract being subject to any and all easements of record and/or usage.

### SURVEYOR'S CERTIFICATE:

I, Aaron J. Austin, Professional Wisconsin Land Surveyor, hereby certify:

That the above description was surveyed, mapped and monumented as shown on this plat by me or under my direct supervision and field work was completed on 1-15-2019.  
That this survey was prepared under the instructions of Steve Adrian of the Town of Glen Haven.  
That this survey complies with Chapter A-E 7 of the Wisconsin Administrative Code and to the best of my knowledge and belief, this plat is an accurate representation thereof.  
That all plans that do not show a seal imprint in red ink may contain unauthorized alterations.  
The certification contained on this document shall not apply to any copies.

Dated this 15th day of January, 2019.

*Aaron J. Austin*  
Aaron J. Austin, S-2922

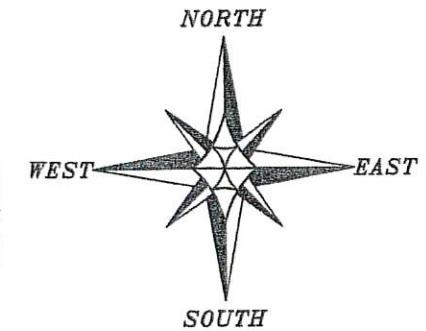
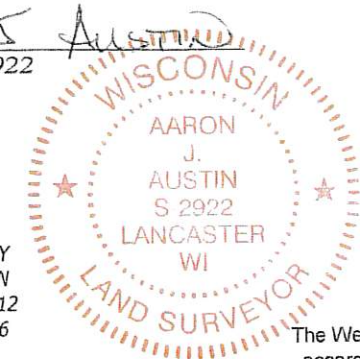

The West line of the NW 1/4 of Section 18 bears N 01°31'56" W according to the Grant County Coordinate System WISCORS NAD 83 (2011) which was determined by G.P.S. observation.

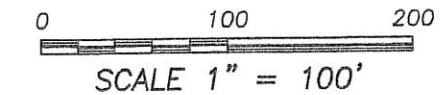

### LEGEND

- ⊙ Section Corner—as designated
- 3/4" rebar found
- 3/4" x 18" rebar set with cap
- + No monument set
- ( ) Recorded as
- Boundary of Survey
- - - Section line
- - - Centerline
- - - Right of Way
- - - Previously surveyed line
- - - Existing improvement—as labeled

PREVIOUS SURVEY  
BY AARON AUSTIN  
REVISED 11-12-2012  
BOOK 32, PAGE 36

PREVIOUS SURVEY  
BY AARON AUSTIN  
REVISED 11-12-2012  
BOOK 32, PAGE 36

PREVIOUS SURVEY  
BY LARRY AUSTIN  
REVISED 6-15-2005  
BOOK 17, PAGE 11

PREVIOUS SURVEY BY  
HOMER RALPH JR.  
DATED 10-10-1973  
BOOK F, PAGE 258

**Austin Engineering LLC**  
austinengineeringllc.com  
4211 HWY 81 E, LANCASTER, WI 53813  
PHONE: 608-723-6363 FAX: 608-723-6702

