

# PLAT OF SURVEY

Prepared for: DARREN KATZUNG

H:\PLAT\T4NR4W\31\18S239-RAGATZ  
CREW: S. AUSTIN, O. AUSTIN DRAWN BY: AJ AUSTIN

CENTER SECTION 31  
3/4" Rebar found

EAST 1/4 CORNER SECTION 31, T4N R4W  
3/4" Rebar and witness corners found

31 31 2632.54'

Point of Beginning

N 89°31'29" W 767.16'

NORTHWEST CORNER NE 1/4, SE 1/4  
3/4" REBAR FOUND  
S 28°09'53" E 8.10'

S 89°31'29" E 549.11'

S 56°22'07" E 360.69'

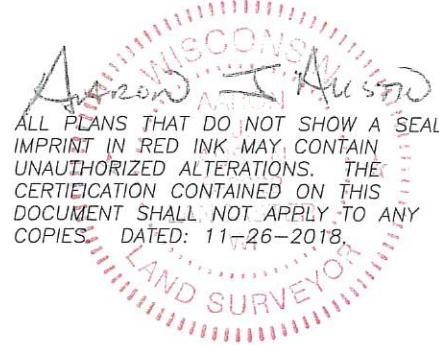

ALL PLANS THAT DO NOT SHOW A SEAL IMPRINT IN RED INK MAY CONTAIN UNAUTHORIZED ALTERATIONS. THE CERTIFICATION CONTAINED ON THIS DOCUMENT SHALL NOT APPLY TO ANY COPIES. DATED: 11-26-2018.

TRACT 4  
PREVIOUS SURVEY  
BY LARRY AUSTIN  
DATED 3-2-2009  
BOOK 24, PAGE 78

36.97± ACRES  
1,610,226± SQ. FT.

NE 1/4 - SE 1/4

NW 1/4 - SE 1/4

N 24°10'46" W 1730.67'

S 80°13'21" W 15.97'

S 37°39'30" E 321.59'

PART OF TRACT 7  
PREVIOUS SURVEY  
BY LARRY AUSTIN  
REVISED 3-16-2011  
BOOK 27, PAGE 16  
[735269]

103.28'  
S 44°29'50" E

PART OF TRACT 7  
PREVIOUS SURVEY  
BY LARRY AUSTIN  
REVISED 3-16-2011  
BOOK 27, PAGE 16  
[735269]

SW 1/4 - SW 1/4



4211 HWY 81 E, LANCASTER, WI 53813  
PHONE: 608-723-6363 FAX: 608-723-6702

## LEGEND

- ⊕ Section Corner—as designated
- 3/4" rebar found
- 3/4" x 18" rebar set with cap
- [ ] Property described in Document Number, Grant County Registry
- Boundary of Survey
- - - Existing Improvement—as labeled
- Section line
- - - Previously surveyed line
- \* \* \* \* Existing fence

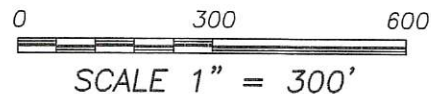

SE 1/4 - SE 1/4

S 69°02'47" W 1420.84'

The North line of the SE 1/4 of Section 31 is assumed to bear N 89° 31' 29" W.

DEC 13 2018

42022

42082

# PLAT OF SURVEY

## DESCRIPTION OF SURVEY:

Located in the Northeast Quarter (NE 1/4) of the Southeast Quarter (SE 1/4) and the Southeast Quarter (SE 1/4) of the Southeast Quarter (SE 1/4) of Section Thirty-one (31) and in the Northwest Quarter (NW 1/4) of the Southwest Quarter (SW 1/4) of Section Thirty-two (32), Township Four (4) North, Range Four (4) West of the 4th P.M., Town of Beetown, Grant County, Wisconsin, containing 36.97 acres, more or less, and being described as follows:

Commencing at a 3/4" rebar marking the East Quarter (E 1/4) corner of said Section 31; thence North 89° 31' 29" West 767.16 feet along the North line of the Southeast Quarter (SE 1/4) of said Section 31 to a 3/4" rebar marking the point of beginning; thence South 56° 22' 07" East 360.69 feet along a line of that property as described in Document Number 735269, Grant County Registry to a 3/4" rebar; thence South 60° 09' 18" East 1075.91 feet along a line of said property to a 3/4" rebar; thence South 80° 13' 21" West 15.97 feet along a line of said property to a 3/4" rebar; thence South 37° 39' 30" East 321.59 feet along a line of said property to a 3/4" rebar; thence South 44° 29' 50" East 103.28 feet along a line of said property to a 3/4" rebar; thence South 69° 02' 47" West 1420.84 feet to a 3/4" rebar; thence North 24° 10' 46" West 1730.67 feet to a 3/4" rebar marking the Northwest corner of the Northeast Quarter (NE 1/4) of the Southeast Quarter (SE 1/4); thence South 89° 31' 29" East 549.11 feet along the North line of the Southeast Quarter (SE 1/4) of said Section 31 to the point of beginning.  
Tract being subject to any and all easements of record and/or usage.

## SURVEYOR'S CERTIFICATE:

I, Aaron J. Austin, Professional Wisconsin Land Surveyor, hereby certify:

That the above description was surveyed, mapped and monumented as shown on this plat by me or under my direct supervision and field work was completed on 11-21-2018.  
That this survey was prepared under the instructions of B.J. Ragatz and Darren Katzung.  
That this survey complies with Chapter A-E 7 of the Wisconsin Administrative Code and to the best of my knowledge and belief, this plat is an accurate representation thereof.  
That all plans that do not show a seal imprint in red ink may contain unauthorized alterations.  
The certification contained on this document shall not apply to any copies.

Dated this 26th day of November, 2018.

  
Aaron J. Austin, S-2922

