

42059

PLAT OF SURVEY

DESCRIPTION PROVIDED:

Lot Three (3) EXCEPT the North 29 feet thereof, and all of Lot Four (4) and Lot Five (5), all in Block Four (4) of Dieter and Eastman's Addition to the Village of Montfort, Grant County, Wisconsin, according to the recorded map or plat thereof. Also including the West Half (W 1/2) of the vacated alley that abuts the above lots along the Eastern boundary.

NORTHEAST CORNER SECTION 25, T6N R1W Aluminum Monument and witness corners found

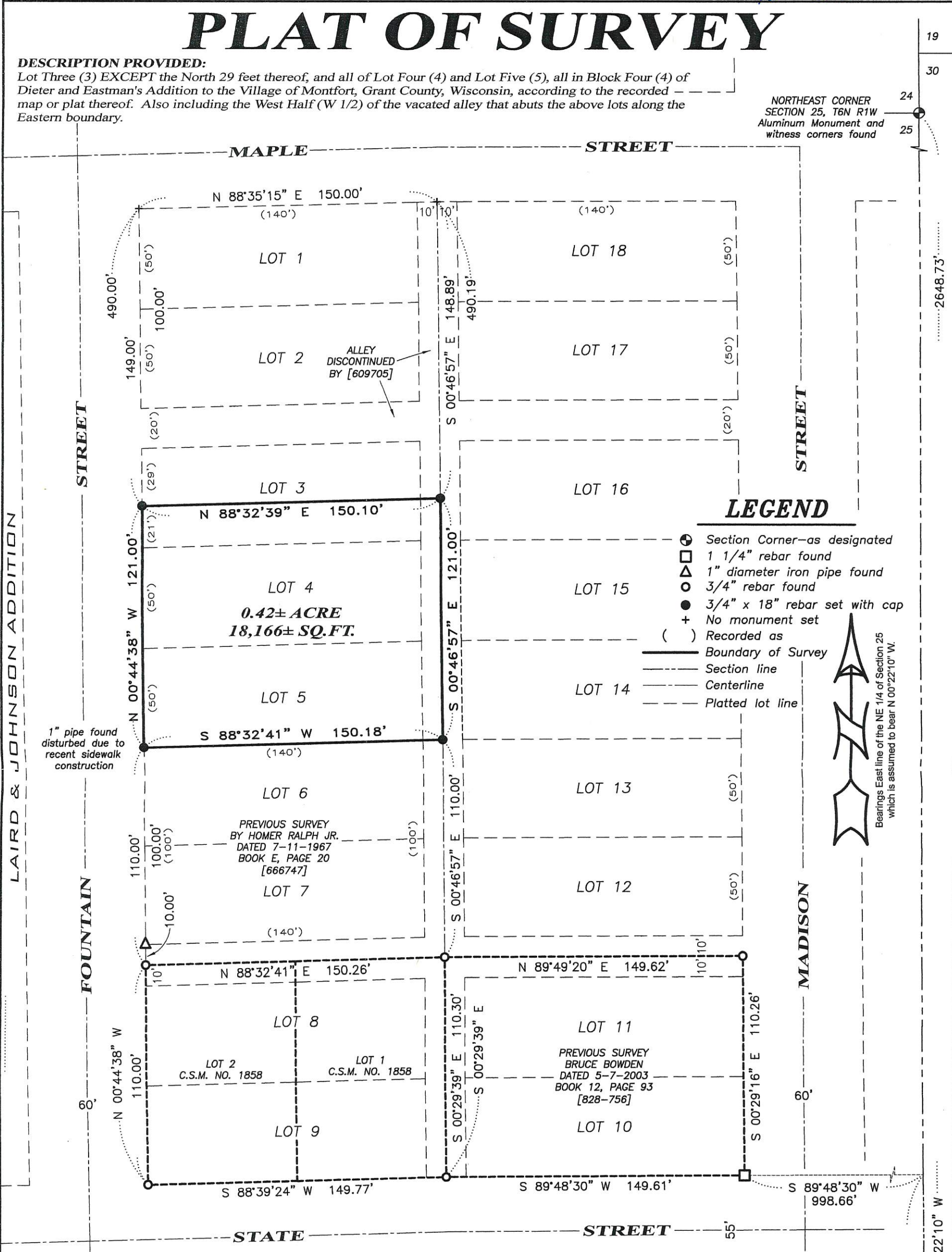

LEGEND

- ⊙ Section Corner—as designated
- 1 1/4" rebar found
- △ 1" diameter iron pipe found
- 3/4" rebar found
- 3/4" x 18" rebar set with cap
- + No monument set
- () Recorded as
- Boundary of Survey
- - - Section line
- Centerline
- - - Platted lot line

Bearings East line of the NE 1/4 of Section 25 which is assumed to bear N 00°22'10" W.

SURVEYOR'S CERTIFICATE:

I, Aaron J. Austin, Professional Wisconsin Land Surveyor, hereby certify:
 That the description hereon was surveyed, mapped and monumented as shown on this plat by me or under my direct supervision and the field work was completed on 9-19-2018.
 That this survey was prepared under the instructions of Jennifer Warne.
 That this survey complies with Chapter A-E 7 of the Wisconsin Administrative Code and to the best of my knowledge and belief, this plat is an accurate representation thereof.
 That all plans that do not show a seal imprint in red ink may contain unauthorized alterations.
 The certification contained on this document shall not apply to any copies.
 Dated this 20th day of September, 2018.

Aaron J. Austin
 Aaron J. Austin, S.2922

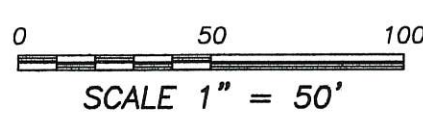

EAST 1/4 CORNER SECTION 25, T6N R1W P.K. Nail and witness corners found



4211 HWY 81 E, LANCASTER, WI 53813
 PHONE: 608-723-6363 FAX: 608-723-6702

Prepared for: JENNIFER WARNE

JOB NO: 18S110
 H:\CRD\18S110
 H:\PLAT\MONTFORT\DIETER&EASTMAN\18S110-WARNE

FIELDBOOK: TDSR
 DRAWN BY: AJ AUSTIN
 CREW: SHANE AUSTIN, OWEN AUSTIN