

WEST 1/4 CORNER  
SECTION 16, T1N R2W  
Aluminum Monument found  
(All ties found and verified)

NORTH 1/4 CORNER  
SECTION 16, T1N R2W  
Aluminum Monument found  
(All ties found and verified)

EAST 1/4 CORNER  
SECTION 16, T1N R2W  
Aluminum Monument found  
(All ties found and verified)

**LEGEND**

- ⊙ Section Corner - as designated
- 3/4" x 18" rebar set with cap
- 3/4" rebar found
- △ 1" diameter iron pipe found
- ⊗ Existing well
- + No monument set
- ( ) Recorded as
- [ - ] Property described in Volume and Page, Grant County Registry
- Boundary of Survey
- - - Section line
- - - Centerline
- - - Previously surveyed line
- - - Proposed Easement line
- - - Right of Way
- x - x Existing fence

NW 1/4 - SW 1/4

**TRACT 1**  
15.01± ACRES  
653,655± SQ.FT.

TRACT 1  
PREVIOUS SURVEY  
BY AARON J. AUSTIN  
DATED 8-30-2017  
BOOK 40, PAGE 60

TRACTS 2 AND 3  
PREVIOUS SURVEY  
BY AARON J. AUSTIN  
DATED 8-30-2017  
BOOK 40, PAGE 60

PREVIOUS SURVEY  
BY AARON J. AUSTIN  
DATED 5-18-2017  
BOOK 40, PAGE 22

PREVIOUS SURVEY  
BY AARON J. AUSTIN  
DATED 3-13-2014  
BOOK 35, PAGE 13  
[1309-756]

PREVIOUS SURVEY  
BY JOHN TRANMER  
DATED 12-17-2001  
GCA 149

PREVIOUS SURVEY  
BY CARL SCHOENHARD  
DATED 10-2-1978  
GCA 148

TRACT 1  
PREVIOUS SURVEY  
BY AARON J. AUSTIN  
DATED 2-26-2014  
BOOK 35, PAGE 7  
[1405-468]

PREVIOUS SURVEY  
BY JOHN WHITE  
DATED 12-28-1998  
BOOK 6, PAGE 68

TRACT 3  
PREVIOUS SURVEY  
BY AARON J. AUSTIN  
DATED 2-26-2014  
BOOK 35, PAGE 7

CURVE	ARC LENGTH	RADIUS	CHORD BEARING	CHORD LENGTH
C1	94.11'	150.00'	S 84°51'40" E	92.57'
C2	77.90'	150.00'	S 87°57'24" E	77.02'
C3	162.63'	500.00'	S 63°45'41" E	161.92'
C4	156.24'	108.36'	N 84°15'10" E	143.05'
C5	114.81'	183.00'	S 84°51'40" E	112.94'

LINE	BEARING	DISTANCE
L1	S 66°53'17" E	14.63'
L2	N 77°09'58" E	122.39'
L3	N 66°53'17" W	109.13'
L4	N 77°09'58" E	58.45'
L5	S 73°04'46" E	203.57'
L6	S 54°26'36" E	254.57'
L7	N 42°56'56" E	105.36'
L8	N 89°13'30" E	109.87'
L9	S 66°53'17" E	23.62'
L10	N 77°09'58" E	115.21'

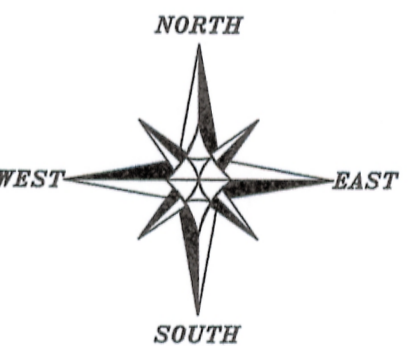
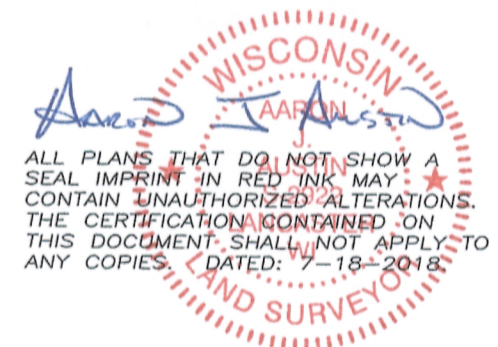

The South line of SW 1/4 Section 16 bears N 88°47'08" E according to the Grant County Coordinate System NAD 83 (2011) WISCORS which was determined by G.P.S. observation.

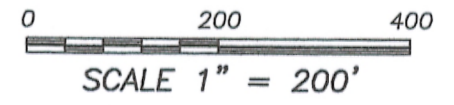

**PLAT OF SURVEY**

PREPARED FOR: RUSS HELBING  
LOCATED IN SECTION 16, T1N R2W, TOWN OF  
JAMESTOWN, GRANT COUNTY, WISCONSIN

**Austin Engineering LLC**  
austinengineeringllc.com

4211 HWY 81 E  
LANCASTER, WI 53813  
PHONE 608-723-6363  
FAX 608-723-6702

JOB NO: 18S108  
H:CRD\18S108  
H:PLAT\T1N2W\16\18s108-HELBING

FIELDBOOK: TDSR  
DRAWN BY: AJ AUSTIN  
CREW: S. AUSTIN, O. AUSTIN  
SHEET 1 OF 3

JUL 19 2018

42007

# PLAT OF SURVEY

**PROPOSED ACCESS AND UTILITY EASEMENT:**

A Sixty-six foot (66') wide access easement for ingress-egress and utilities which is located in the Northeast Quarter (NE 1/4) of the Southwest Quarter (SW 1/4) and the Northwest Quarter (NW 1/4) of the Southeast Quarter (SE 1/4) of Section Sixteen (16), Township One (1) North, Range Two (2) West of the 4th P.M., Town of Jamestown, Grant County, Wisconsin, said easement being located 33 feet on each side of the following described centerline:

Commencing at the Southwest corner of said Section 16;  
thence North 88° 47' 08" East 1298.91 feet along the South line of said Section 16 to a 3/4" rebar marking the Southwest corner of the Southeast Quarter (SE 1/4) of the Southwest Quarter (SW 1/4) thereof;  
thence North 00° 33' 05" West 1312.28 feet along the West line of the Southeast Quarter (SE 1/4) of the Southwest Quarter (SW 1/4) to a 3/4" rebar marking the Northwest corner thereof;  
thence South 88° 46' 11" West 420.38 feet along the South line of the Northwest Quarter (NW 1/4) of the Southwest Quarter (SW 1/4) to a 3/4" rebar;  
thence North 00° 33' 04" West 245.52 feet along a line of Tract 1 of a previous survey by Aaron Austin dated 8-30-2017 to a 3/4" rebar;  
thence North 88° 46' 11" East 420.38 feet to a 3/4" rebar;  
thence North 51° 12' 23" East 692.82 feet to a 3/4" rebar;  
thence North 38° 20' 54" East 251.20 feet;  
thence North 66° 53' 17" West 109.13 feet to the point of beginning which is the center of a 66 foot radius of the easement;  
thence South 66° 53' 17" East 109.13 feet;  
thence continuing South 66° 53' 17" East 14.63 feet;  
thence 94.11 feet on the arc of a curve to the left with a radius of 150.00 feet and a long chord bearing South 84° 51' 40" East 92.57 feet;  
thence North 77° 09' 58" East 122.39 feet;  
thence continuing North 77° 09' 58" East 58.45 feet;  
thence 77.90 feet on the arc of a curve to the right with a radius of 150.00 feet and a long chord bearing South 87° 57' 24" East 77.02 feet;  
thence South 73° 04' 46" East 203.57 feet;  
thence 162.63 feet on the arc of a curve to the right with a radius of 500.00 feet and a long chord bearing South 63° 45' 41" East 161.92 feet;  
thence South 54° 26' 36" East 254.57 feet;  
thence 156.24 feet on the arc of a curve to the left with a radius of 108.36 feet and a long chord bearing North 84° 15' 10" East 143.05 feet;  
thence North 42° 56' 56" East 105.36 feet;  
thence North 89° 13' 30" East 109.87 feet to the Westerly right of way of U.S.H. #151 and the terminus point.

**EASEMENT NOTES:**

Other documentation will need to be recorded to clarify the intent, use, maintenance, assignments or other pertinent information of this easement.

**SURVEYOR'S CERTIFICATE:**

I, Aaron J. Austin, Professional Wisconsin Land Surveyor, hereby certify:

That the descriptions hereon were surveyed, mapped and monumented as shown on this plat by me or under my direct supervision and field work was completed on 7-17-2018.  
That conformance with local ordinances are not guaranteed with this survey.  
That this survey was prepared under the instructions of Russ Helbing.  
That to the best of my knowledge and belief, this plat is an accurate representation thereof.  
That all plans that do not show a seal imprint in red ink may contain unauthorized alterations.  
The certification contained on this document shall not apply to any copies.

Dated this 18th day of July, 2018.

  
\_\_\_\_\_  
Aaron J. Austin, S-2922

**SURVEYOR'S NOTES:**

This survey was prepared with the intent of following the lines shown and described hereon. Surveyor has made no investigation for easements of record, encumbrances, restrictive covenants, ownership title evidence except as specifically shown on this plat. No distance should be assumed by scaling. No improvements have been located unless shown and noted. No representation as to ownership, use or possession should be hereon implied. Refer to abstract, title or local ordinances for any additional restriction, easements or building setback lines. No abstract, nor title commitment, nor results of title searches were furnished to the surveyor.

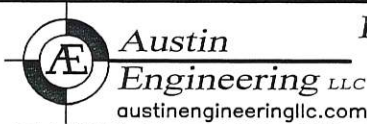

Prepared for: **RUSS HELBING**

4211 HWY 81 E, LANCASTER, WI 53813  
PHONE: 608-723-6363 FAX: 608-723-6702

JOB NO: 18S108  
H:CRD\18S108  
H:PLAT\T1NR2W\16\18s108-HELBING

FIELDBOOK: TDSR  
DRAWN BY: AJ AUSTIN  
CREW: S. AUSTIN, O. AUSTIN

42687

# PLAT OF SURVEY

## TRACT 1 DESCRIPTION:

Located in the Northeast Quarter (NE 1/4) of the Southwest Quarter (SW 1/4), the Northwest Quarter (NW 1/4) of the Southwest Quarter (SW 1/4) and the Southeast Quarter (SE 1/4) of the Southwest Quarter (SW 1/4) of Section Sixteen (16), Township One (1) North, Range Two (2) West of the 4th P.M., Town of Jamestown, Grant County, Wisconsin, containing 15.01 acres, more or less, and being described as follows:

Commencing at the Southwest corner of said Section 16;  
 thence North 88° 47' 08" East 1298.91 feet along the South line of said Section 16 to a 3/4" rebar marking the Southwest corner of the Southeast Quarter (SE 1/4) of the Southwest Quarter (SW 1/4) thereof, said corner being the point of beginning;  
 thence North 00° 33' 05" West 1312.28 feet along the West line of the Southeast Quarter (SE 1/4) of the Southwest Quarter (SW 1/4) to a 3/4" rebar marking the Northwest corner thereof;  
 thence South 88° 46' 11" West 420.38 feet along the South line of the Northwest Quarter (NW 1/4) of the Southwest Quarter (SW 1/4) to a 3/4" rebar;  
 thence North 00° 33' 04" West 245.52 feet along a line of Tract 1 of a previous survey by Aaron Austin dated 8-30-2017 to a 3/4" rebar;  
 thence North 88° 46' 11" East 420.38 feet to a 3/4" rebar;  
 thence North 51° 12' 23" East 692.82 feet to a 3/4" rebar;  
 thence North 38° 20' 54" East 251.20 feet;  
 thence South 66° 53' 17" East 14.63 feet;  
 thence 94.11 feet on the arc of a curve to the left with a radius of 150.00 feet and a long chord bearing South 84° 51' 40" East 92.57 feet;  
 thence North 77° 09' 58" East 122.39 feet;  
 thence South 00° 33' 05" East 347.19 feet to a 3/4" rebar;  
 thence South 59° 19' 08" West 480.52 feet to a 1" iron pipe;  
 thence South 81° 21' 24" West 169.04 feet along a line of Tract 1 of a previous survey by Aaron Austin dated 2-26-2014 to a 1" iron pipe;  
 thence South 08° 35' 26" West 1164.06 feet along a line of Tract 1 and Tract 3 of said survey by Aaron Austin dated 2-26-2014 to a 1" iron pipe;  
 thence North 81° 06' 28" West 149.51 feet along a line of said Tract 3 to a 3/4" rebar;  
 thence South 02° 12' 49" East 456.11 feet along a line of said Tract 3 to a 1" iron pipe;  
 thence South 88° 47' 08" West 24.83 feet along the South line of said Section 16 to the point of beginning.

Tract being subject to any and all easements of record and/or usage.

*Aaron Austin*  
 WISCONSIN  
 AARON  
 LAND SURVEYOR  
 ALL PLANS THAT DO NOT SHOW A SEAL IMPRINT IN RED INK MAY CONTAIN UNAUTHORIZED ALTERATIONS. THE CERTIFICATION CONTAINED ON THIS DOCUMENT SHALL NOT APPLY TO ANY COPIES. DATED: 7-18-2018

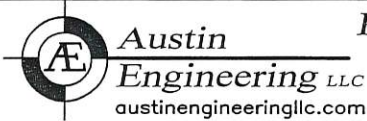

Prepared for: RUSS HELBING

4211 HWY 81 E, LANCASTER, WI 53813  
 PHONE: 608-723-6363 FAX: 608-723-6702

JOB NO: 18S108  
 H:CRD\18S108  
 H:PLAT\T1NR2W\16\18s108-HELBING

FIELDBOOK: TDSR  
 DRAWN BY: AJ AUSTIN  
 CREW: S. AUSTIN, O. AUSTIN