



40103

# PLAT OF SURVEY

**DESCRIPTION:**

Located in the Northwest Quarter (NW 1/4) of the Northeast Quarter (NE 1/4) of Section Twenty-nine (29), Township Four (4) North, Range Two (2) West of the 4th P.M., Town of Ellenboro, Grant County, Wisconsin, containing 1.35 acre, more or less, and being described as follows:

Commencing at the North Quarter (N 1/4) corner of said Section 29;  
thence South 89° 07' 00" East 560.69 feet along the North of Section 29 to a 3/4" rebar marking the point of beginning;  
thence South 89° 07' 00" East 206.01 feet along the North line of said Section 29 to a 3/4" rebar;  
thence South 00° 56' 29" East 232.07 feet along a line of that property as described in Volume 1197, Page 193 recorded as Document Number 715026, Grant County Registry to a 3/4" rebar;  
thence South 89° 05' 39" West 292.78 feet along a line of said property described in Volume 1197, Page 193 to a 3/4" rebar;  
thence North 19° 04' 40" East 253.78 feet to the point of beginning.

**ACCESS EASEMENT:**

A Sixty-six foot (66') wide access easement for ingress-egress which is located in the Southwest Quarter (SW 1/4) of the Southeast Quarter (SE 1/4) and the Northwest Quarter (NW 1/4) of the Southeast Quarter (SE 1/4) of Section Twenty (20), Township Four (4) North, Range Two (2) West of the 4th P.M., Town of Ellenboro, Grant County, Wisconsin, said easement being located Thirty-three feet (33') on each side of the following described centerline:

Commencing at the South Quarter (S 1/4) corner of said Section 20;  
thence South 89° 07' 00" East 560.69 feet along the North of Section 29 to a 3/4" rebar;  
thence continuing South 89° 07' 00" East 73.08 feet along the North line of said Section 29 to the point of beginning;  
thence 68.98 feet on the arc of a curve to the left with a radius of 125.00 feet and a long chord bearing North 24° 00' 56" West 68.11 feet;  
thence North 39° 49' 28" West 248.51 feet;  
thence North 09° 37' 10" East 30.97 feet;  
thence 44.92 feet on the arc of a curve to the right with a radius of 180.00 feet and a long chord bearing North 10° 24' 21" East 44.81 feet;  
thence North 17° 33' 19" East 262.82 feet;  
thence 207.10 feet on the arc of a curve to the left with a radius of 500.00 feet and a long chord bearing North 05° 27' 09" East 205.62 feet;  
thence North 06° 24' 48" West 194.79 feet;  
thence North 03° 53' 27" West 306.33 feet;  
thence North 05° 36' 00" East 99.77 feet to a point in the centerline of a township road known as Bast Lane, said point being the terminus point.

**EASEMENT NOTES:**

Other documentation will need to be recorded to clarify the intent, use, maintenance, assignments or other pertinent information of this easement.

**SURVEYOR'S CERTIFICATE:**

I, Aaron J. Austin, Professional Wisconsin Land Surveyor, hereby certify:

That the above descriptions were surveyed, mapped and monumented as shown on this plat by me or under my direct supervision and the field work was completed on 10-23-2017.  
That this survey was prepared under the instructions of Joe Vondrum.  
That this survey complies with Chapter A-E 7 of the Wisconsin Administrative Code and to the best of my knowledge and belief, this plat is an accurate representation thereof.  
That all plans that do not show a seal imprint in red ink may contain unauthorized alterations.  
The certification contained on this document shall not apply to any copies.

Dated this 20th day of November, 2017.

  
Aaron J. Austin, S-2922

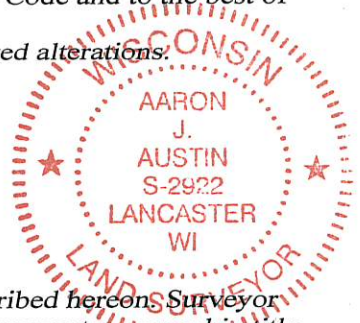

**SURVEYOR'S NOTES:**

This survey was prepared with the intent of following the lines shown and described hereon. Surveyor has made no investigation for easements of record, encumbrances, restrictive covenants, ownership title evidence except as specifically shown on this plat. No distance should be assumed by scaling. No improvements have been located unless shown and noted. No representation as to ownership, use or possession should be hereon implied. Refer to abstract, title or local ordinances for any additional restriction, easements or building setback lines. No abstract, nor title commitment, nor results of title searches were furnished to the surveyor.

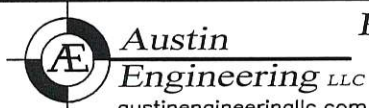

Prepared for: JOE VONDRUM

4211 HWY 81 E, LANCASTER, WI 53813  
PHONE: 608-723-6363 FAX: 608-723-6702

JOB NO: 17s123  
H:\CRD\17s123  
H:\PLAT\T4NR2W\29\29\17s123-VONDRUM

FIELDBOOK: TDSR  
DRAWN BY: AJ AUSTIN  
CREW: SHANE AUSTIN  
SHEET 2 OF 2