

# PLAT OF SURVEY

Prepared for: JERRETT EDGE

B40 PL8

H:\PLAT\T3NR3W\18\17s119-EDGE  
CREW: S. AUSTIN, O. AUSTIN DRAWN BY: AJ AUSTIN

EAST 1/4 CORNER SECTION 13, T3N R4W  
1" Rebar found (all ties found)

N 00°19'16" W 38.94'

NORTHWEST CORNER SECTION 18, T3N R3W  
1" Rebar found (all ties found)

LINE	BEARING	DISTANCE
L1	N 72°58'47" W	220.02'
L2	S 85°52'28" W	112.56'
L3	S 59°14'46" W	72.07'
L4	S 44°33'01" W	76.38'
L5	N 56°32'41" W	22.08'
L6	N 21°22'06" E	119.26'
L7	N 10°39'08" W	41.26'

LOT 2  
C.S.M. NO. 932

PART OF TRACT 2 PREVIOUS SURVEY BY AARON AUSTIN DATED 1-1-2015 BOOK 36, PAGE 51 [769631]

LOT 1  
C.S.M. NO. 932

CENTERLINE BOICE CREEK ROAD

TRACT 3 PREVIOUS SURVEY BY AARON AUSTIN DATED 1-1-2015 BOOK 36, PAGE 51 [770051]

PART OF TRACT 2 PREVIOUS SURVEY BY AARON AUSTIN DATED 1-1-2015 BOOK 36, PAGE 51 [769631]

TRACT 1 PREVIOUS SURVEY BY AARON AUSTIN DATED 1-1-2015 BOOK 36, PAGE 51 [769630]

PART OF TRACT 2 PREVIOUS SURVEY BY AARON AUSTIN DATED 1-1-2015 BOOK 36, PAGE 51 [769631]

TRACT 6  
20.05± ACRES  
873,378± SQ.FT.

NORTHEAST CORNER SW 1/4, NW 1/4 BURIED 18"±

TRACT 4 PREVIOUS SURVEY BY AARON AUSTIN DATED 1-1-2015 BOOK 36, PAGE 51 [769632]

ALL PLANS THAT DO NOT SHOW A SEAL IMPRINT IN RED INK MAY CONTAIN UNAUTHORIZED ALTERATIONS. THE CERTIFICATION CONTAINED ON THIS DOCUMENT SHALL NOT APPLY TO ANY COPIES. DATED: 8-15-2017



- ### LEGEND
- ⊙ Section Corner—as designated
  - 3/4" rebar found
  - 3/4" x 18" rebar set with cap
  - + No monument set
  - [ ] Property described in Document Number, Grant County Registry

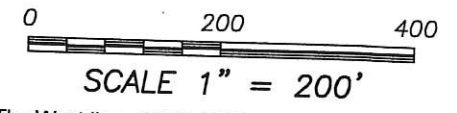

The West line of NW 1/4 Section 18 bears S 00°19'16" E according to the Grant County Coordinate System WISCORS NAD 83 (2011) which was determined by G.P.S. observation.

**Austin Engineering LLC**  
austinengineeringllc.com  
4211 HWY 81 E, LANCASTER, WI 53813  
PHONE: 608-723-6363 FAX: 608-723-6702

# PLAT OF SURVEY

**TRACT 6 DESCRIPTION:**

Located in the Northwest Quarter (NW 1/4) of the Northwest Quarter (NW 1/4), the Southwest Quarter (SW 1/4) of the Northwest Quarter (NW 1/4) and the Northeast Quarter (NE 1/4) of the Northwest Quarter (NW 1/4) of Section Eighteen (18), Township Three (3) North, Range Three (3) West of the 4th P.M., Town of Potosi, Grant County, Wisconsin, containing 20.05 acres, more or less, and being described as follows:

Commencing at the Northwest corner of said Section 18;  
 thence South 00° 19' 16" East 1346.49 feet along the West line of said Section 18 to the point of beginning;  
 thence South 00° 19' 16" East 272.98 feet along said West line;  
 thence South 89° 35' 43" East 1393.42 feet along a line of that property as described in Document Number 769631, Grant County Registry;  
 thence North 00° 24' 18" East 289.49 feet along a line of said property;  
 thence North 45° 30' 29" East 562.43 feet along a line of said property;  
 thence North 72° 58' 47" West 220.02 feet;  
 thence South 85° 52' 28" West 112.56 feet;  
 thence South 59° 14' 46" West 72.07 feet;  
 thence South 44° 33' 01" West 76.38 feet;  
 thence North 56° 32' 41" West 22.08 feet;  
 thence North 21° 22' 06" East 119.26 feet;  
 thence North 10° 39' 08" West 41.26 feet to a corner of said property described in Document Number 769631;  
 thence North 47° 27' 59" West 332.50 feet along a line of said property;  
 thence South 63° 38' 07" West 305.17 feet along a line of said property;  
 thence South 34° 13' 31" West 91.71 feet along a line of said property;  
 thence South 03° 51' 46" West 326.10 feet along a line of said property;  
 thence South 10° 24' 59" West 103.37 feet along a line of said property;  
 thence South 121.44 feet along a line of said property;  
 thence North 89° 35' 43" West 766.74 feet along a line of said property to the point of beginning.  
 Tract being subject to any and all easements of record and/or usage.

**SURVEYOR'S CERTIFICATE:**

I, Aaron J. Austin, Professional Wisconsin Land Surveyor, hereby certify:

That the above description was surveyed, mapped and monumented as shown on this plat by me or under my direct supervision and field work was completed on 7-31-2017.

That this survey was prepared under the instructions of Jerrett Edge.

That this survey complies with Chapter A-E 7 of the Wisconsin Administrative Code and to the best of my knowledge and belief, this plat is an accurate representation thereof.

That all plans that do not show a seal imprint in red ink may contain unauthorized alterations.

The certification contained on this document shall not apply to any copies.

Dated this 15th day of August, 2017.

*Aaron J. Austin*  
 Aaron J. Austin, S-2922

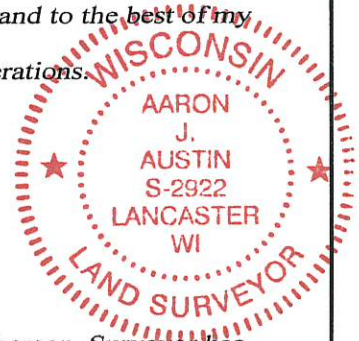

**SURVEYOR'S NOTES:**

This survey was prepared with the intent of following the lines shown and described hereon. Surveyor has made no investigation for easements of record, encumbrances, restrictive covenants, ownership title evidence except as specifically shown on this plat. No distance should be assumed by scaling. No improvements have been located unless shown and noted. No representation as to ownership, use or possession should be hereon implied. Refer to abstract, title or local ordinances for any additional restriction, easements or building setback lines. No abstract, nor title commitment, nor results of title searches were furnished to the surveyor.



**Austin Engineering LLC**  
 austinengineeringllc.com

4211 HWY 81 E, LANCASTER, WI 53813  
 PHONE: 608-723-6363 FAX: 608-723-6702

Prepared for: **JERRETT EDGE**

JOB NO: 17s119  
 H:\CRD\17s119  
 H:\PLAT\T3NR3W\18\17s119-EDGE

FIELDBOOK: TDSR  
 DRAWN BY: AJ AUSTIN  
 CREW: SHANE AUSTIN, OWEN AUSTIN