

# PLAT OF SURVEY

RECEIVED  
By Grant County Land Records at 9:35 am, Jun 20, 2017

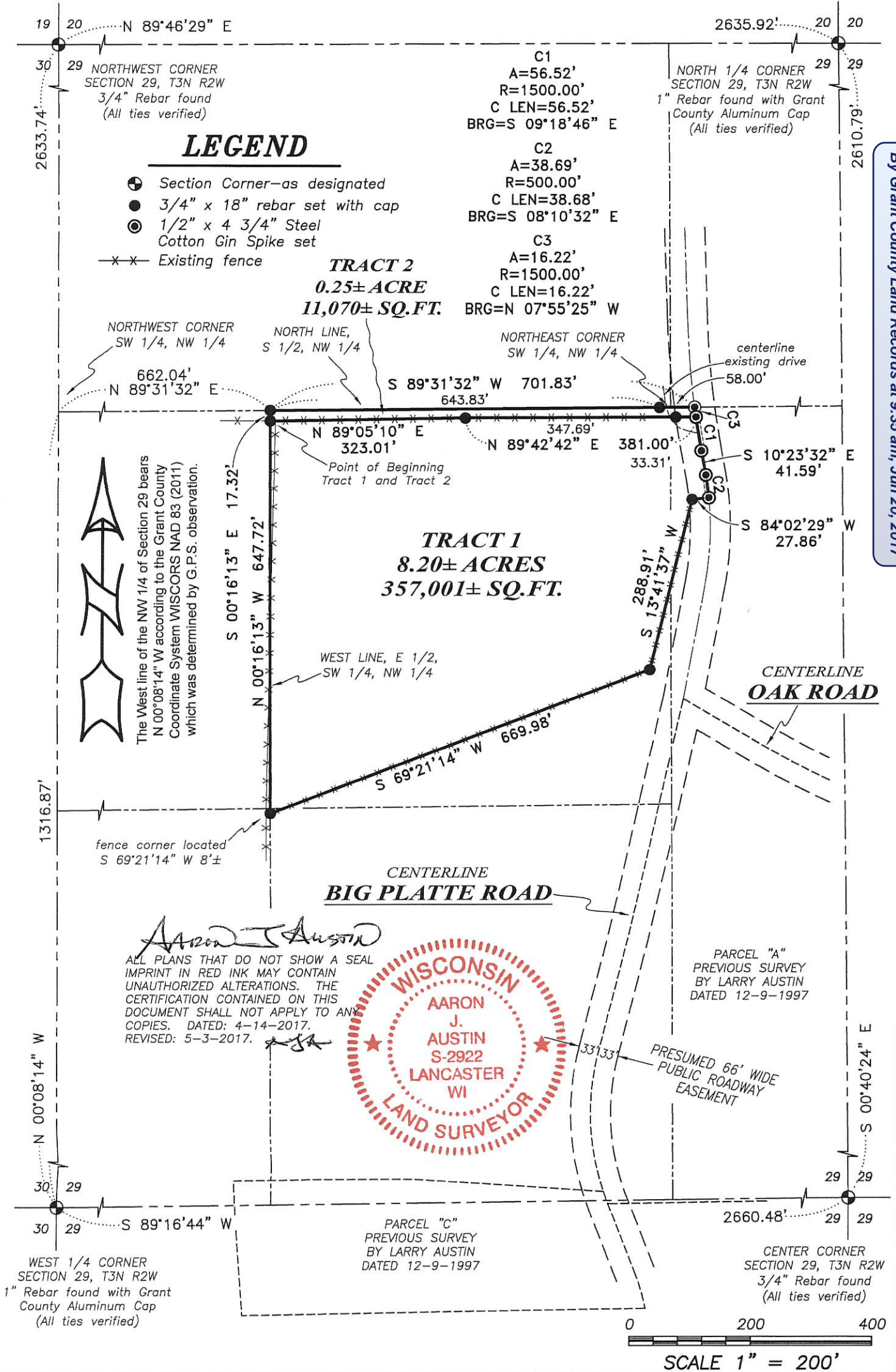

The West line of the NW 1/4 of Section 29 bears N 00°08'14" W according to the Grant County Coordinate System WISCONSIN NAD 83 (2011) which was determined by G.P.S. observation.

Aaron J. Austin  
ALL PLANS THAT DO NOT SHOW A SEAL IMPRINT IN RED INK MAY CONTAIN UNAUTHORIZED ALTERATIONS. THE CERTIFICATION CONTAINED ON THIS DOCUMENT SHALL NOT APPLY TO ANY COPIES. DATED: 4-14-2017. REVISED: 5-3-2017.



**Austin Engineering LLC**  
austinengineeringllc.com

Prepared for: **LESTER JANTZEN**

JOB NO: 17s016  
H:\GRD\17s016  
H:\PLAT\T3NR2W\29\17s016-JANZTEN

FIELDBOOK: TDSR  
DRAWN BY: AJ AUSTIN  
CREW: SHANE AUSTIN

4211 HWY 81 E, LANCASTER, WI 53813  
PHONE: 608-723-6363 FAX: 608-723-6702

# PLAT OF SURVEY

### TRACT 1 DESCRIPTION:

Located in the Southwest Quarter (SW 1/4) of the Northwest Quarter (NW 1/4) and the Southeast Quarter (SE 1/4) of the Northwest Quarter (NW 1/4) of Section Twenty-nine (29), Township Three (3) North, Range Two (2) West of the 4th P.M., Town of Harrison, Grant County, Wisconsin, containing 8.20 acres, more or less, and being described as follows:

Commencing at the West Quarter (W 1/4) corner of said Section 29;  
thence North 00° 08' 14" West 1316.87 feet along the West line of said Section to the Northwest corner of the Southwest Quarter (SW 1/4) of the Northwest Quarter (NW 1/4) of said Section;  
thence North 89° 31' 32" East 662.04 feet to the Northwest corner of the Northeast Quarter (NE 1/4) of the Southwest Quarter (SW 1/4) of the Northwest Quarter (NW 1/4);  
thence South 00° 16' 13" East 17.32 feet along the West line of the East Half (E 1/2) of the Southwest Quarter (SW 1/4) of the Northwest Quarter (NW 1/4) of said Section to the point of beginning;  
thence North 89° 05' 10" East 323.01 feet;  
thence North 89° 42' 42" East 381.00 feet to a point in the centerline of a township road known as Big Platte Road;  
thence 56.52 feet on the arc of a curve to the left with a radius of 1500.00 feet and a long chord bearing South 09° 18' 46" East 56.52 feet along said centerline;  
thence South 10° 23' 32" East 41.59 feet along said centerline;  
thence 38.69 feet on the arc of a curve to the right with a radius of 500.00 feet and a long chord bearing South 08° 10' 32" East 38.68 feet along said centerline;  
thence South 84° 02' 29" West 27.86 feet;  
thence South 13° 41' 37" West 288.91 feet;  
thence South 69° 21' 14" West 669.98 feet to the West line of the East Half (E 1/2) of the Southwest Quarter (SW 1/4) of said Northwest Quarter (NW 1/4);  
thence North 00° 16' 13" West 647.72 feet along said West line to the point of beginning.  
Tract being subject to any and all easements of record and/or usage.

### TRACT 2 DESCRIPTION:

Located in the Southwest Quarter (SW 1/4) of the Northwest Quarter (NW 1/4) and the Southeast Quarter (SE 1/4) of the Northwest Quarter (NW 1/4) of Section Twenty-nine (29), Township Three (3) North, Range Two (2) West of the 4th P.M., Town of Harrison, Grant County, Wisconsin, containing 0.25 acre, more or less, and being described as follows:

Commencing at the West Quarter (W 1/4) corner of said Section 29;  
thence North 00° 08' 14" West 1316.87 feet along the West line of said Section to the Northwest corner of the Southwest Quarter (SW 1/4) of the Northwest Quarter (NW 1/4) of said Section;  
thence North 89° 31' 32" East 662.04 feet to the Northwest corner of the Northeast Quarter (NE 1/4) of the Southwest Quarter (SW 1/4) of the Northwest Quarter (NW 1/4);  
thence South 00° 16' 13" East 17.32 feet along the West line of the East Half (E 1/2) of the Southwest Quarter (SW 1/4) of the Northwest Quarter (NW 1/4) of said Section to the point of beginning;  
thence North 89° 05' 10" East 323.01 feet;  
thence North 89° 42' 42" East 381.00 feet to a point in the centerline of a township road known as Big Platte Road;  
thence 16.22 feet on the arc of a curve to the right with a radius of 1500.00 feet and a long chord bearing North 07° 55' 25" West 16.22 feet along said centerline to the North line of the South Half (S 1/2) of the Northwest Quarter (NW 1/4) of said Section;  
thence South 89° 31' 32" West 701.83 feet along said North line;  
thence South 00° 16' 13" East 17.32 feet along the West line of the East Half (E 1/2) of the Southwest Quarter (SW 1/4) of said Northwest Quarter (NW 1/4) to the point of beginning.  
Tract being subject to any and all easements of record and/or usage.

### SURVEYOR'S CERTIFICATE:

I, Aaron J. Austin, Professional Wisconsin Land Surveyor, hereby certify:

That the above descriptions were surveyed, mapped and monumented as shown on this plat by me or under my direct supervision and field work was completed on 5-1-2017.  
That this survey was prepared under the instructions of Lester Jantzen.  
That this survey complies with Chapter A-E 7 of the Wisconsin Administrative Code and to the best of my knowledge and belief, this plat is an accurate representation thereof.  
That all plans that do not show a seal imprint in red ink may contain unauthorized alterations.  
The certification contained on this document shall not apply to any copies.

Dated this 14th day of April, 2017.  
Revised this 3rd day of May, 2017. (Created Tract 1 and Tract 2)

  
Aaron J. Austin, S-2922



### SURVEYOR'S NOTES:

Fences shown on this survey were measured at random locations. The fence may meander between fence corners and are shown for reference only. Possession and occupational rights MAY have been acquired to the fence and it is not known if the fence is a fence of convenience or if it is intended to mark the boundary. This survey was prepared with the intent of following the lines shown and described hereon. Surveyor has made no investigation for easements of record, encumbrances, restrictive covenants, ownership title evidence except as specifically shown on this plat. No distance should be assumed by scaling. No improvements have been located unless shown and noted. No representation as to ownership, use or possession should be hereon implied. Refer to abstract, title or local ordinances for any additional restriction, easements or building setback lines. No abstract, nor title commitment, nor results of title searches were furnished to the surveyor.

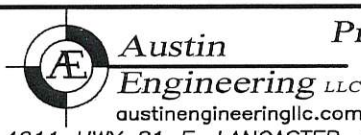

Prepared for: LESTER JANTZEN

4211 HWY 81 E, LANCASTER, WI 53813  
PHONE: 608-723-6363 FAX: 608-723-6702

JOB NO: 17s016  
H:\CRD\17s016  
H:\PLAT\T3NR2W\29\17s016-JANZTEN

FIELDBOOK: TDSR  
DRAWN BY: AJ AUSTIN  
CREW: SHANE AUSTIN

# PLAT OF SURVEY

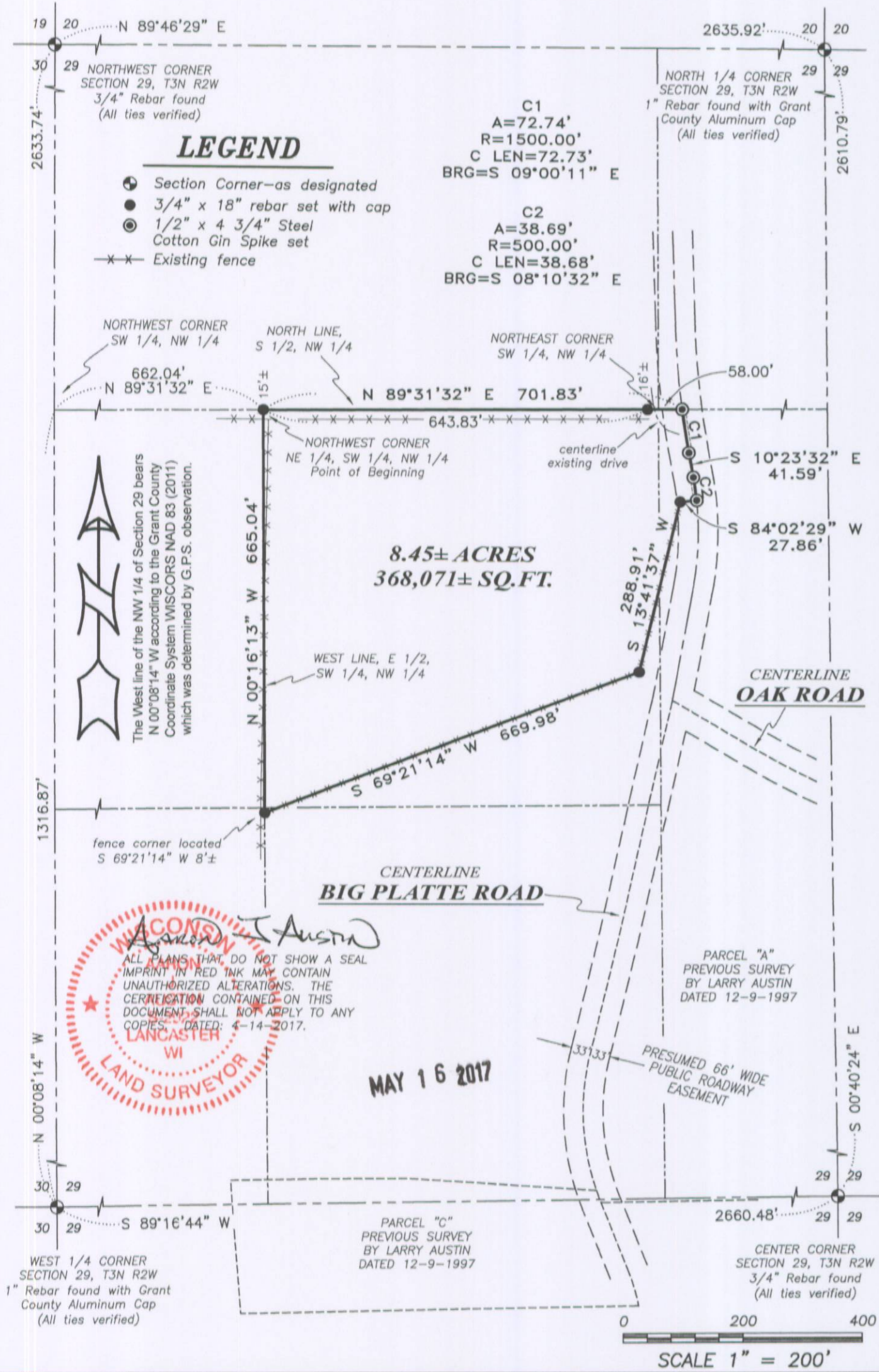

ALL PLANS THAT DO NOT SHOW A SEAL IMPRINT IN RED INK MAY CONTAIN UNAUTHORIZED ALTERATIONS. THE CERTIFICATION CONTAINED ON THIS DOCUMENT SHALL NOT APPLY TO ANY COPIES. DATED: 4-14-2017.

MAY 16 2017

WISCONSIN  
AARON J. AUSTIN  
S-2922  
LANCASTER  
WI  
LAND SURVEYOR

MAY 16 2017

**Austin Engineering LLC**  
austineengineeringllc.com  
4211 HWY 81 E, LANCASTER, WI 53813  
PHONE: 608-723-6363 FAX: 608-723-6702

Prepared for: **LESTER JANTZEN**

JOB NO: 17s016  
H:\CRD\17s016  
H:\PLAT\T3NR2W\29\17s016-JANZTEN

FIELDBOOK: TDSR  
DRAWN BY: AJ AUSTIN  
CREW: SHANE AUSTIN

SHEET 1 OF 2

# PLAT OF SURVEY

### DESCRIPTION OF SURVEY:

Located in the Southwest Quarter (SW 1/4) of the Northwest Quarter (NW 1/4) and the Southeast Quarter (SE 1/4) of the Northwest Quarter (NW 1/4) of Section Twenty-nine (29), Township Three (3) North, Range Two (2) West of the 4th P.M., Town of Harrison, Grant County, Wisconsin, containing 8.45 acres, more or less, and being described as follows:

Commencing at the West Quarter (W 1/4) corner of said Section 29;  
thence North 00° 08' 14" West 1316.87 feet along the West line of said Section to the Northwest corner of the Southwest Quarter (SW 1/4) of the Northwest Quarter (NW 1/4) of said Section;  
thence North 89° 31' 32" East 662.04 feet to the Northwest corner of the Northeast Quarter (NE 1/4) of the Southwest Quarter (SW 1/4) of the Northwest Quarter (NW 1/4), said corner being the point of beginning;  
thence North 89° 31' 32" East 701.83 feet along the North line of South Half (S 1/2) of said Northwest Quarter (NW 1/4) to a point in the centerline of a township road known as Big Platte Road;  
thence 72.74 feet on the arc of a curve to the left with a radius of 1500.00 feet and a long chord bearing South 09° 00' 11" East 72.73 feet along said centerline;  
thence South 10° 23' 32" East 41.59 feet along said centerline;  
thence 38.69 feet on the arc of a curve to the right with a radius of 500.00 feet and a long chord bearing South 08° 10' 32" East 38.68 feet along said centerline;  
thence South 84° 02' 29" West 27.86 feet;  
thence South 13° 41' 37" West 288.91 feet;  
thence South 69° 21' 14" West 669.98 feet to the West line of the East Half (E 1/2) of the Southwest Quarter (SW 1/4) of said Northwest Quarter (NW 1/4);  
thence North 00° 16' 13" West 665.04 feet along said West line to the point of beginning.  
Tract being subject to any and all easements of record and/or usage.

### SURVEYOR'S CERTIFICATE:

I, Aaron J. Austin, Professional Wisconsin Land Surveyor, hereby certify:

That the above description was surveyed, mapped and monumented as shown on this plat by me or under my direct supervision and field work was completed on 4-14-2017.  
That this survey was prepared under the instructions of Lester Jantzen.  
That this survey complies with Chapter A-E 7 of the Wisconsin Administrative Code and to the best of my knowledge and belief, this plat is an accurate representation thereof.  
That all plans that do not show a seal imprint in red ink may contain unauthorized alterations.  
The certification contained on this document shall not apply to any copies.

Dated this 14th day of April, 2017.

*Aaron J. Austin*  
Aaron J. Austin, S-2922

### SURVEYOR'S NOTES:

Fences shown on this survey were measured at random locations. The fence may meander between fence corners and are shown for reference only. Possession and occupational rights MAY have been acquired to the fence and it is not known if the fence is a fence of convenience or if it is intended to mark the boundary. This survey was prepared with the intent of following the lines shown and described hereon. Surveyor has made no investigation for easements of record, encumbrances, restrictive covenants, ownership title evidence except as specifically shown on this plat. No distance should be assumed by scaling. No improvements have been located unless shown and noted. No representation as to ownership, use or possession should be hereon implied. Refer to abstract, title or local ordinances for any additional restriction, easements or building setback lines. No abstract, nor title commitment, nor results of title searches were furnished to the surveyor.

**Austin Engineering LLC**  
austineengineeringllc.com  
4211 HWY 81 E, LANCASTER, WI 53813  
PHONE: 608-723-6363 FAX: 608-723-6702

Prepared for: **LESTER JANTZEN**

JOB NO: 17s016  
H:\CRD\17s016  
H:\PLAT\T3NR2W\29\17s016-JANZTEN

FIELDBOOK: TDSR  
DRAWN BY: AJ AUSTIN  
CREW: SHANE AUSTIN

SHEET 2 OF 2