

PLAT OF SURVEY

TRACT 1: (OVERALL DESCRIPTION)

Located in the Southeast Quarter (SE 1/4) of the Northwest Quarter (NW 1/4), the Southwest Quarter (SW 1/4) of the Northeast Quarter (NE 1/4), the Southeast Quarter (SE 1/4) of the Northeast Quarter (NE 1/4), the Northeast Quarter (NE 1/4) of the Southeast Quarter (SE 1/4), the Northwest Quarter (NW 1/4) of the Southeast Quarter (SE 1/4) of the Northeast Quarter (NE 1/4) of the Southwest Quarter (SW 1/4) the Southeast Quarter (SE 1/4) of the Southwest Quarter (SW 1/4) and the Southwest Quarter (SW 1/4) of the Southeast Quarter (SE 1/4) of Section One (1), Township Five (5) North, Range Four (4) West of the 4th P.M., Town of Little Grant, Grant County, Wisconsin, containing 220.40 acres, more or less, and being described as follows:

Commencing at the South Quarter (S 1/4) corner of said Section 1, said corner being the point of beginning;
thence North 00° 29' 07" West 665.20 feet along the East line of the Southwest Quarter (SW 1/4) of said Section 1 to the Southwest corner of the North Half (N 1/2) of the Southwest Quarter (SW 1/4) of the Southeast Quarter (SE 1/4) thereof;
thence South 89° 43' 21" East 1332.33 feet along the South line of the North Half (N 1/2) of the Southwest Quarter (SW 1/4) of the Southeast Quarter (SE 1/4) to the Southeast corner thereof;
thence North 00° 24' 00" West 666.18 feet along the East line of the Southwest Quarter (SW 1/4) of the Southeast Quarter (SE 1/4) to the Northeast corner thereof;
thence South 89° 45' 54" East 1333.31 feet along the South line of the Northeast Quarter (NE 1/4) of the Southeast Quarter (SE 1/4) to the Southeast corner thereof;
thence North 00° 18' 53" West 1334.31 feet along the East line of said Section 1 to the East Quarter (E 1/4) corner thereof;
thence North 00° 46' 40" West 203.77 feet along the East line of said Section 1;
thence North 87° 00' 46" West 167.51 feet;
thence South 53° 56' 27" West 246.98 feet;
thence South 10° 53' 34" West 61.91 feet;
thence North 75° 06' 48" West 425.46 feet;
thence South 16° 16' 15" West 30.21 feet;
thence South 33° 04' 50" East 170.83 feet;
thence South 41° 28' 22" West 57.59 feet;
thence North 55° 03' 55" West 111.50 feet;
thence South 29° 41' 03" West 45.09 feet;
thence South 35° 36' 44" East 65.17 feet;
thence South 07° 22' 48" West 24.98 feet;
thence South 62° 11' 22" West 294.22 feet;
thence North 46° 39' 11" West 127.90 feet;
thence North 43° 41' 08" East 109.66 feet;
thence North 73° 25' 38" East 132.30 feet;
thence North 19° 58' 26" West 148.53 feet;
thence North 10° 28' 34" East 267.12 feet;
thence South 86° 59' 35" West 324.41 feet;
thence North 76° 12' 59" West 104.67 feet;
thence North 48° 24' 50" West 122.51 feet;
thence South 81° 31' 25" West 233.65 feet;
thence South 42° 18' 37" West 218.73 feet;
thence South 25° 04' 57" West 23.25 feet;
thence North 76° 58' 00" West 812.43 feet;
thence North 02° 22' 00" East 93.21 feet;
thence North 73° 14' 56" West 273.29 feet;
thence North 26° 08' 06" West 334.33 feet;
thence North 57° 08' 26" West 228.56 feet;
thence North 17° 26' 53" East 379.84 feet to the North line of the Southeast Quarter (SE 1/4) of the Northwest Quarter (NW 1/4) thereof;
thence North 89° 41' 42" West 68.71 feet along said North line to a point in the centerline of a township road known as Shady Dell Road;
thence 420.69 feet on the arc of a curve to the left with a radius of 350.00 feet and a long chord bearing South 55° 52' 15" West 395.82 feet along said centerline;
thence South 21° 26' 13" West 116.41 feet along said centerline;
thence 267.83 feet on the arc of a curve to the right with a radius of 550.00 feet and a long chord bearing South 35° 23' 15" West 265.19 feet along said centerline;
thence South 49° 20' 18" West 234.45 feet along said centerline;
thence 174.44 feet on the arc of a curve to the left with a radius of 200.00 feet and a long chord bearing South 24° 21' 04" West 168.96 feet along said centerline to the West line of the Southeast Quarter (SE 1/4) of the Northwest Quarter (NW 1/4);
thence South 00° 38' 09" East 467.29 feet along said West line to the Southwest corner thereof;
thence South 00° 28' 09" East 2651.72 feet along the West line of the East Half (E 1/2) of the Southwest Quarter (SW 1/4) of said Section 1 to the Southwest corner thereof;
thence South 89° 27' 28" East 1323.11 feet along the South line of said Section 1 to the point of beginning.
Tract being subject to any and all easements of record and/or usage.

FEB 28 2017



Aaron J. Austin
ALL PLANS THAT DO NOT SHOW A SEAL IMPRINT IN RED INK MAY CONTAIN UNAUTHORIZED ALTERATIONS. THE CERTIFICATION CONTAINED ON THIS DOCUMENT SHALL NOT APPLY TO ANY COPIES. DATED: 1-24-2017.

PLAT OF SURVEY

PROPOSED ACCESS EASEMENT:

An easement being located in the Southeast Quarter (SE 1/4) of the Northwest Quarter (NW 1/4), the Southwest Quarter (SW 1/4) of the Northeast Quarter (NE 1/4), the Southeast Quarter (SE 1/4) of the Northeast Quarter (NE 1/4) and the Northeast Quarter (NE 1/4) of the Southeast Quarter (SE 1/4) of Section One (1), Township Five (5) North, Range Four (4) West of the 4th P.M., Town of Little Grant, Grant County, Wisconsin, the centerline of said easement being described as follows:

Commencing at the West Quarter (W 1/4) corner of said Section 1;
thence South 89° 51' 00" East 1322.24 feet to the Southwest corner of the Southeast Quarter (SE 1/4) of the Northwest Quarter (NW 1/4) of said Section 1;
thence North 00° 38' 09" West 467.29 feet along the West line of the Southeast Quarter (SE 1/4) of the Northwest Quarter (NW 1/4) thereof to a point in the centerline of a township road known as Shady Dell Road;
thence 174.44 feet on the arc of a curve to the right with a radius of 200.00 feet and a long chord bearing North 24° 21' 04" East 168.96 feet along said centerline;
thence North 49° 20' 18" East 157.71 feet along said centerline to the point of beginning of a Thirty-three foot (33') wide access easement for ingress-egress, said easement being located 16.5 feet on each side of the following described centerline:
thence South 46° 37' 16" East 21.79 feet;
thence 64.14 feet on the arc of a curve to the left with a radius of 150.00 feet and a long chord bearing South 58° 52' 18" East 63.66 feet;
thence South 71° 07' 20" East 797.34 feet;
thence 870.55 feet on the arc of a curve to the left with a radius of 5000.00 feet and a long chord bearing South 76° 06' 36" East 869.45 feet;
thence South 81° 05' 52" East 157.94 feet;
thence South 76° 58' 00" East 99.39 feet;
thence South 76° 51' 40" East 614.81 feet;
thence South 48° 14' 49" East 132.81 feet;
thence South 57° 30' 19" East 140.50 feet;
thence North 73° 25' 38" East 105.05 feet to the terminus point of the 33 foot wide easement and the point of beginning of the centerline of a Ten foot (10') wide access easement for ingress-egress which is located 5 feet on each side of the following described centerline:
thence North 19° 58' 26" West 165.06 feet to the terminus point.

EASEMENT NOTES:

Other documentation will need to be recorded to clarify the intent, use, maintenance, assignments or other pertinent information of this easement.

TRACT 2: (YEAROUS TO WHITE DESCRIPTION)

Located in the Southeast Quarter (SE 1/4) of the Southeast Quarter (SE 1/4) of Section One (1), Township Five (5) North, Range Four (4) West of the 4th P.M., Town of Little Grant, Grant County, Wisconsin, containing 0.33 acre, more or less, and being described as follows:

Commencing at the South Quarter (S 1/4) corner of said Section 1;
thence North 00° 29' 07" West 665.20 feet along the East line of the Southwest Quarter (SW 1/4) of said Section 1 to the Southwest corner of the North Half (N 1/2) of the Southwest Quarter (SW 1/4) of the Southeast Quarter (SE 1/4) thereof;
thence South 89° 43' 21" East 1332.33 feet along the South line of the North Half (N 1/2) of the Southwest Quarter (SW 1/4) of the Southeast Quarter (SE 1/4) to the Southeast corner thereof;
thence North 00° 24' 00" West 666.18 feet along the East line of the Southwest Quarter (SW 1/4) of the Southeast Quarter (SE 1/4) to the Northeast corner thereof and the point of beginning;
thence South 89° 45' 54" East 1333.31 feet along the South line of the Northeast Quarter (NE 1/4) of the Southeast Quarter (SE 1/4) to the Southeast corner thereof;
thence South 00° 18' 53" East 16.78 feet along the East line of said Section 1;
thence North 89° 15' 32" West 1333.47 feet to the West line of the Southeast Quarter (SE 1/4) of the Southeast Quarter (SE 1/4);
thence North 00° 24' 00" West 5.00 feet along said West line to the point of beginning.
Tract being subject to any and all easements of record and/or usage.

FEB 8 2017

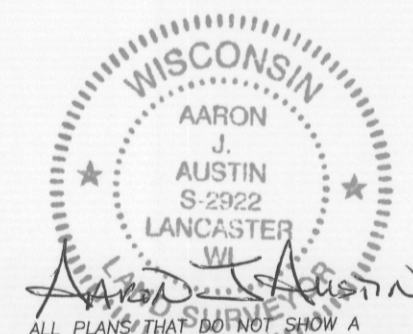

Aaron J. Austin
ALL PLANS THAT DO NOT SHOW A SEAL IMPRINT IN RED INK MAY CONTAIN UNAUTHORIZED ALTERATIONS. THE CERTIFICATION CONTAINED ON THIS DOCUMENT SHALL NOT APPLY TO ANY COPIES. DATED: 1-24-2017.

PLAT OF SURVEY

TRACT 3: (WHITE TO YEAROUS)

Located in the Southwest Quarter (SW 1/4) of the Southeast Quarter (SE 1/4) of Section One (1), Township Five (5) North, Range Four (4) West of the 4th P.M., Town of Little Grant, Grant County, Wisconsin, containing 1.38 acres, more or less, and being described as follows:

Commencing at the South Quarter (S 1/4) corner of said Section 1;
thence North 00° 29' 07" West 665.20 feet along the East line of the Southwest Quarter (SW 1/4) of said Section 1 to the Southwest corner of the North Half (N 1/2) of the Southwest Quarter (SW 1/4) of the Southeast Quarter (SE 1/4) thereof, said corner being the point of beginning;
thence South 89° 43' 21" East 1332.33 feet along the South line of the North Half (N 1/2) of the Southwest Quarter (SW 1/4) of the Southeast Quarter (SE 1/4) to the Southeast corner thereof;
thence North 00° 24' 00" West 106.20 feet along the East line of the Southwest Quarter (SW 1/4) of the Southeast Quarter (SE 1/4);
thence South 27° 50' 54" West 34.43 feet;
thence South 87° 33' 35" West 1316.80 feet to the West line of the Southwest Quarter (SW 1/4) of the Southeast Quarter (SE 1/4);
thence South 00° 29' 07" East 13.23 feet along the West line of the Southwest Quarter (SW 1/4) of the Southeast Quarter (SE 1/4) to the point of beginning.
Tract being subject to any and all easements of record and/or usage.

SURVEYOR'S CERTIFICATE:

I, Aaron J. Austin, Professional Wisconsin Land Surveyor, hereby certify:

That the descriptions hereon were surveyed, mapped and monumented as shown on this plat by me or under my direct supervision and the field work was completed on January 24, 2017.
That this survey was prepared under the instructions of Carolyn White-Knapp.
That this survey complies with Chapter A-E 7 of the Wisconsin Administrative Code and to the best of my knowledge and belief, this plat is an accurate representation thereof.
That all plans that do not show a seal imprint in red ink may contain unauthorized alterations.
The certification contained on this document shall not apply to any copies.

Dated this 24th day of January, 2017.

Aaron J. Austin
Aaron J. Austin, S-2922

SURVEYOR'S NOTES:

Tract 2 and Tract 3 were completed for the exchange of land between adjoining land owners. Fences shown on this survey were measured at random locations. The fence may meander between fence corners and are shown for reference only. Possession and occupational rights MAY have been acquired to the fence and it is not known if the fence is a fence of convenience or if it is intended to mark the boundary. This survey was prepared with the intent of following the lines shown and described hereon. Surveyor has made no investigation for easements of record, encumbrances, restrictive covenants, ownership title evidence except as specifically shown on this plat. No distance should be assumed by scaling. No improvements have been located unless shown and noted. No representation as to ownership, use or possession should be hereon implied. Refer to abstract, title or local ordinances for any additional restriction, easements or building setback lines. No abstract, nor title commitment, nor results of title searches were furnished to the surveyor.

FEB 8 2017



