

28 27 2647.29'
33 34
NORTHWEST CORNER
SECTION 34, T3N R3W
1" Rebar found

S 89°47'25" W
27 27
34 34
NORTH 1/4 CORNER
SECTION 34, T3N R3W
3/4" Rebar found

PLAT OF SURVEY
PREPARED FOR: ERIC STEINER

PARCEL A
PREVIOUS SURVEY
BY LAURENCE SCHMIT
DATED 1-20-1978
BOOK G, PAGE 127
[1297-85]

PARCEL B
PREVIOUS SURVEY
BY LAURENCE SCHMIT
DATED 1-20-1978
BOOK G, PAGE 127
[1117-148]

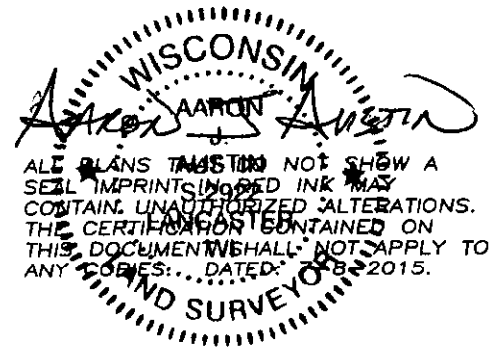

ALL PLANS MUST NOT SHOW A SEAL IMPRINT IN RED INK MAY CONTAIN UNAUTHORIZED ALTERATIONS. THE CERTIFICATION CONTAINED ON THIS DOCUMENT SHALL NOT APPLY TO ANY COPIES... DATED: 7-8-2015.

- LEGEND**
- ⊙ Section Corner—as designated
 - 3/4" x 18" rebar set with cap
 - △ 1" diameter iron pipe found
 - + No monument set
 - () Recorded as
 - [-] Property described in Volume and Page, Grant County Registry

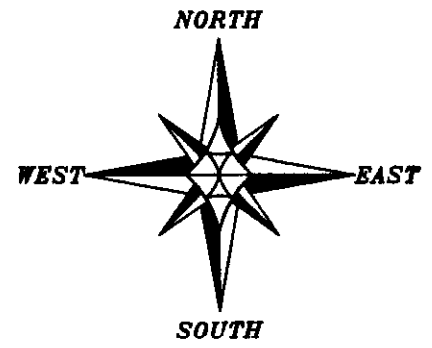

The North line of the NW 1/4 of Section 34 bears S 89°47'25" W according to the Grant County Coordinate System (2011 adjustment) which was determined by G.P.S. observation.

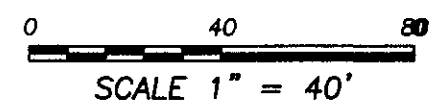

DRAWN BY: AJ AUSTIN
CREW: SW AUSTIN, BL AUSTIN

TRACT 1
0.11± ACRE
4,795± SQ.FT.

TRACT 2
0.09± ACRE
3,950± SQ.FT.

Austin Engineering LLC
austinengineeringllc.com
4211 HWY 81 E, LANCASTER, WI 53883
PHONE: 608-723-6363 FAX: 608-723-6702
H:PLAT\T3NR3W\34\15s087-STEINER SHEET 1 OF 2

PLAT OF SURVEY

TRACT 1 DESCRIPTION: (BIERMAN TO STEINER)

Located in the Northeast Quarter (NE 1/4) of the Northwest Quarter (NW 1/4) of Section Thirty-four (34), Township Three (3) North, Range Three (3) West of the 4th P.M., Village of Potosi, Grant County, Wisconsin, containing 0.11 acre, more or less, and being described as follows:

Commencing at the North Quarter (N 1/4) corner of said Section 34;
thence South 89° 47' 25" West 670.90 feet along the North line of said Section;
thence South 00° 12' 35" East 686.93 feet to a corner of that property as described in Volume 1117, Page 148 recorded as Document No. 692997, Grant County Registry, said corner being the point of beginning;
thence South 45° 01' 48" East 184.16 feet along a line of said property described in Volume 1117, Page 148;
thence South 40° 51' 02" West 25.34 feet;
thence North 45° 29' 08" West 184.53 feet;
thence North 41° 50' 52" East 26.78 feet along a line of that property as described in Volume 1297, Page 85 recorded as Document No. 740112, Grant County Registry to the point of beginning.
Tract being subject to any and all easements of record and/or usage.

TRACT 2 DESCRIPTION: (STEINER TO BIERMAN)

Located in the Northeast Quarter (NE 1/4) of the Northwest Quarter (NW 1/4) of Section Thirty-four (34), Township Three (3) North, Range Three (3) West of the 4th P.M., Village of Potosi, Grant County, Wisconsin, containing 0.09 acre, more or less, and being described as follows:

Commencing at the North Quarter (N 1/4) corner of said Section 34;
thence South 89° 47' 25" West 670.90 feet along the North line of said Section;
thence South 00° 12' 35" East 686.93 feet to a corner of that property as described in Volume 1117, Page 148 recorded as Document No. 692997, Grant County Registry;
thence South 45° 01' 48" East 184.16 feet along a line of said property described in Volume 1117, Page 148 to the point of beginning;
thence North 40° 51' 02" East 221.70 feet;
thence South 46° 38' 56" East 35.67 feet along a line of said property described in Volume 1117, Page 148;
thence South 50° 02' 41" West 223.00 feet along a line of said property described in Volume 1117, Page 148 to the point of beginning.
Tract being subject to any and all easements of record and/or usage.

SURVEYOR'S CERTIFICATE:

I, Aaron J. Austin, Professional Wisconsin Land Surveyor, hereby certify:

That the above descriptions were surveyed, mapped and monumented as shown on this plat by me or under my direct supervision.

That conformance with local ordinances are not guaranteed with this survey.

That this survey was prepared under the instructions of Eric Steiner.

That to the best of my knowledge and belief, this plat is an accurate representation thereof.

That all plans that do not show a seal imprint in red ink may contain unauthorized alterations.

The certification contained on this document shall not apply to any copies.

Dated this 8th day of July, 2015.

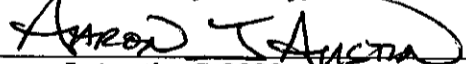
Aaron J. Austin, S-2922

SURVEYOR'S NOTES:

This survey was prepared with the intent of following the lines shown and described hereon. Surveyor has made no investigation for easements of record, encumbrances, restrictive covenants, ownership title evidence except as specifically shown on this plat. No distance should be assumed by scaling. No improvements have been located unless shown and noted. No representation as to ownership, use or possession should be hereon implied. Refer to abstract, title or local ordinances for any additional restriction, easements or building setback lines. No abstract, nor title commitment, nor results of title searches were furnished to the surveyor.



Austin
Engineering LLC
austineengineeringllc.com

4211 HWY 81 E, LANCASTER, WI 53813
PHONE: 608-723-6363 FAX: 608-723-6702

Prepared for: ERIC STEINER

JOB NO: 15s087
H:CRD\15s087
H:PLAT\T3NR3W\34\15s087-STEINER

FIELDBOOK: TDSR
DRAWN BY: AJ AUSTIN
CREW: SW AUSTIN

SHEET 2 OF 2