

1935 / 1939 FOXMOOR CONDOMINIUM

Being Lot 100 of the 3rd. Addition to Foxmoor Heights as located in part of the SE 1/4 of the SW 1/4 of Section 19, T6N, R2W, City of Fennimore, Grant County, Wisconsin

OFFICE DATA:	
JOB I.D.	105-032
SURVEY CREW	DK CB
FIELD BOOK NO.	2010-1 P.
DWG. STORED	LES\CG\2010\
DRAWN BY	LES
DRAWING NO.	105-032.DWG
DATA FILE NO.	105-032.TXT

SYMBOL LEGEND

- FOUND 1/4" Φ REBAR
- FOUND 3/4" Φ REBAR
- ▲ SET 3/4" X 18" X 1.5# L/F REBAR
- FOUND 3" Φ IRON PIPE
- () RECORDED AS
- E ELECTRIC
- G GAS
- T TELEPHONE
- S SEWER
- W WATER

Note: All underground utilities are located from Digger's Hot Line request. Other underground features may exist that were not marked by such request.

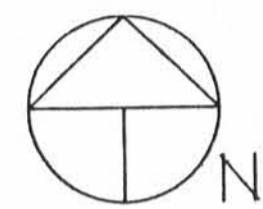

Scale 1" = 50'

PLAT BEARINGS ARE ORIENTED TOWARD THE GRANT COUNTY COORDINATE SYSTEM AS DEFINED BY THE WISCONSIN DEPARTMENT OF TRANSPORTATION, THE SOUTH LINE OF THE SW 1/4 OF SECTION 19, T6N, R2W OF WHICH COMPUTES TO BEAR N 84°58'17" E

SHEET 1 OF 1



SCHMIT ENGINEERING & SURVEYING
215 E. GRACE STREET
DODGEVILLE, WI. 53533
608-935-2721

SURVEYOR'S CERTIFICATE

I, Laurence E. Schmit, do hereby certify that I have surveyed and mapped according to the Official Records the Condominium described and platted hereon. I further certify that this Condominium plat is a true scaled and dimensioned representation of the Boundaries, buildings, improvements, and existing encroachments, if any, and that the plat is a correct representation of the condominium described and that the identification and location of each unit and the common elements can be determined from the plat per Section 703.13 of the Wisconsin Statutes.

Laurence E. Schmit 9-4-2012
Laurence E. Schmit, RL5-1312 Date

DESCRIPTION

Lot 100 of the 3rd. Addition to Foxmoor Heights as recorded in Plat Cabinet "A" on Page 351 as Document 664429, and located in part of the SE 1/4 of the SW 1/4 of Section 19, T6N, R2W, City of Fennimore, Grant County, WI, to wit: Beginning at the NW corner of said lot 100, said point located S 84°58'17" W, 1110.37' and N 00°00'17" E, 236.78' from the S 1/4 corner of said Section 19; thence S 84°57'55" E, 184.34' to the NE corner of lot 100; thence S 00°03'45" W, 115.00' to the SE corner of said lot 100; thence N 84°57'55" W, 184.23' to the SW corner of said lot 100; thence N 00°00'17" E, 115.00' to the POINT OF BEGINNING. Containing 21,193 square feet, or 0.487 acres, more or less.

KEY NOTES

1. GROUNDS: LIMITED COMMON ELEMENT APPURTENANT TO UNIT 1.
2. GROUNDS: LIMITED COMMON ELEMENT APPURTENANT TO UNIT 2.
3. CONCRETE PAVEMENT: LIMITED COMMON ELEMENT APPURTENANT TO UNIT 1.
4. CONCRETE PAVEMENT: LIMITED COMMON ELEMENT APPURTENANT TO UNIT 2.
5. WOOD DECK: LIMITED COMMON ELEMENT APPURTENANT TO UNIT 1.
6. WOOD DECK: LIMITED COMMON ELEMENT APPURTENANT TO UNIT 2.
7. SANITARY BUILDING SEWER: COMMON ELEMENT.

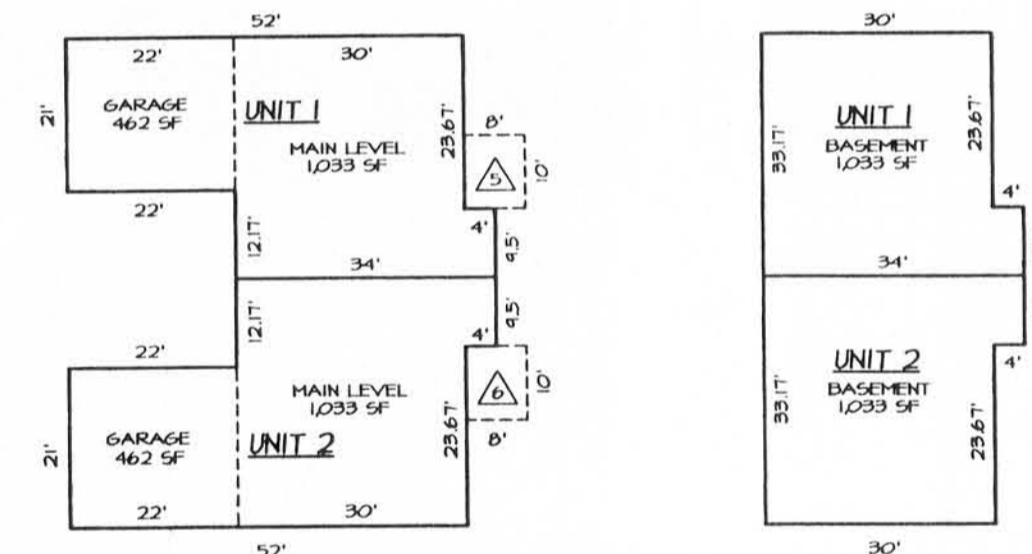

BUILDING FLOOR PLAN
SCALE: 1" = 25 FT

REGISTER OF DEEDS CERTIFICATE

Received for recording this _____ day of _____, 20____, AT _____ o'clock ____ M. and recorded in Volume _____ of Grant County Condominium Plats, on Page(s) _____
Marilyn Pierce, Grant County Register of Deeds

3RD. ADDITION TO FOXMOOR HEIGHTS
FILED IN PLAT CABINET "A" ON PAGE 351 AS DOC. 664429

