

PLAT OF SURVEY

NORTH 1/4 CORNER
SECTION 29, T3N R2W

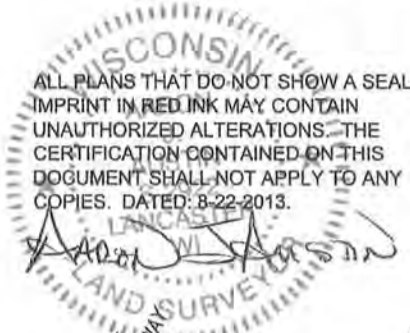

ALL PLANS THAT DO NOT SHOW A SEAL IMPRINT IN RED INK MAY CONTAIN UNAUTHORIZED ALTERATIONS. THE CERTIFICATION CONTAINED ON THIS DOCUMENT SHALL NOT APPLY TO ANY COPIES. DATED: 8-22-2013.

LEGEND

- No. 6 x 18" rebar set with cap
- ⊙ 1/2" x 4 3/4" Steel Gin Spike set
- No. 6 rebar found
- + No monument set
- () Recorded as
- [-] Property described in Volume and Page, Grant County Registry

C3
L=19.99'
R=1406.23'
C LEN=19.99'
BRG=N 68°50'08" W
(BRG=N 68°10'43" W)

C2
L=186.03'
R=828.37'
C LEN=185.64'
BRG=N 62°48'33" W
(BRG=N 62°09'07" W)

C1
L=18.36'
R=512.76'
C LEN=18.36'
BRG=N 57°24'05" W
(BRG=N 56°44'39" W)

(N 68°35'08" W)
114.10'
N 69°14'34" W

(N 55°43'06" W)
130.87'
N 56°22'31" W

148.00'
N 00°40'24" W
186.56'
(N 00°00'58" W)

[1286-943]
3.06± ACRES
133,395± SQ.FT.

PREVIOUS SURVEY
BY LARRY AUSTIN
DATED 10-17-2001

0.83± ACRE
OF FIELD

PARCEL "A"
PREVIOUS SURVEY
BY LARRY AUSTIN
DATED 12-9-1997

PARCEL "B"
PREVIOUS SURVEY
BY LARRY AUSTIN
DATED 12-9-1997

S 85°19'01" E 487.51'
(S 84°39'36" E)

N 00°40'24" W 252.98'
(N 00°00'58" W)

(S 89°43'43" W)
578.00'
S 89°04'17" W

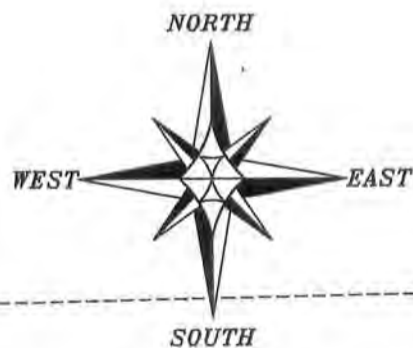

The East line of the NW 1/4 of Section 29 bears S 00°40'24" E according to the Grant County Coordinate System (2011 adjustment) which was determined by G.P.S. observation.

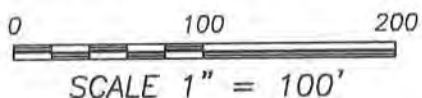

Austin Engineering LLC
austinengineeringllc.com

4211 HWY 81 E, LANCASTER, WI 53813
PHONE: 608-723-6363 FAX: 608-723-6702

Prepared for: **LUELLA KLANN**

JOB NO: 13s113
G:\13s113
H:\PLAT\T3NR2W\29\13s113-KLANN

FIELDBOOK: TDSR
DRAWN BY: AJ AUSTIN
CREW: SW AUSTIN

SHEET 1 OF 2

PLAT OF SURVEY

DESCRIPTION PROVIDED:

Part of the Southeast Quarter (S.E. 1/4) of the Northwest Quarter (N.W. 1/4) of Section Twenty-nine (29), Township Three (3) North, Range Two (2) West of the 4th P.M., Grant County, Wisconsin, said parcel being described as follows:

Commencing at the North Quarter corner of said Section 29;

thence South 00° 00' 58" East 2610.79 feet along the East line of the N.W. 1/4 to the center of said Section;

thence South 89° 43' 43" West 578.00 feet to a corner of a survey by Larry Austin dated December 9, 1997;

thence North 00° 00' 58" West 252.98 feet to the point of beginning;

thence North 00° 00' 58" West 186.56 feet along said survey to a point in the centerline of Oak Road;

thence Northwesterly 18.36 feet on the arc of a curve concave Northeasterly having a radius of 512.76 feet and a long chord bearing North 56° 44' 39" West 18.36 feet to a point in said centerline;

thence North 55° 43' 06" West 130.87 feet to a point in said centerline;

thence Northwesterly 186.03 feet on the arc of a curve concave Southwesterly having a radius of 828.37 feet and a long chord bearing North 62° 09' 07" West 185.64 feet to a point in said centerline;

thence North 68° 35' 08" West 114.10 feet to a point in said centerline;

thence Northwesterly 19.99 feet on the arc of a curve concave Northeasterly having a radius of 1406.23 feet and a long chord bearing North 68° 10' 43" West 19.99 feet to a point in said centerline;

thence South 11° 25' 43" West 368.08 feet;

thence South 84° 39' 36" East 487.51 feet to the point of beginning.

SURVEYOR'S CERTIFICATE:

I, Aaron J. Austin, Registered Wisconsin Land Surveyor, hereby certify:

That the above description was surveyed, mapped and monumented as shown on this plat by me or under my direct supervision.

That conformance with local ordinances are not guaranteed with this survey.

That this survey was prepared under the instructions of Luella Klann.

That to the best of my knowledge and belief, this plat is an accurate representation thereof.

That all plans that do not show a seal imprint in red ink may contain unauthorized alterations.

The certification contained on this document shall not apply to any copies.

Dated this 22nd day of August, 2013.

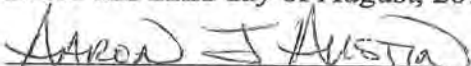
Aaron J. Austin, S-2922

SURVEYOR'S NOTES:

This survey was prepared with the intent of following the lines shown and described hereon. Surveyor has made no investigation for easements of record, encumbrances, restrictive covenants, ownership title evidence except as specifically shown on this plat. No distance should be assumed by scaling. No improvements have been located unless shown and noted. No representation as to ownership, use or possession should be hereon implied. Refer to abstract, title or local ordinances for any additional restriction, easements or building setback lines. No abstract, nor title commitment, nor results of title searches were furnished to the surveyor.



Austin
Engineering LLC
austineengineeringllc.com

4211 HWY 81 E, LANCASTER, WI 53813
PHONE: 608-723-6363 FAX: 608-723-6702

Prepared for: **LUELLA KLANN**

JOB NO: 13s113
G:\13s113
H:\PLAT\T3NR2W\29\13s113-KLANN

FIELDBOOK: TDSR
DRAWN BY: AJ AUSTIN
CREW: SW AUSTIN

SHEET 2 OF 2