

# PLAT OF SURVEY

## LEGEND

- No. 6 x 24" rebar set with cap
- ⊕ No. 8 rebar found with Grant County Aluminum Cap
- ⊗ No. 7 rebar found with Lafayette County Aluminum Cap
- No. 6 rebar found
- △ 1" diameter iron pipe found
- ▲ 1 1/4" diameter iron pipe found
- + No monument set
- ( ) Recorded as



THE SOUTH LINE OF THE NE 1/4 OF SECTION 25 IS ASSUMED TO BEAR N 89°31'59" W.

C1  
 L=188.11'  
 R=1680.00'  
 C LEN=188.01'  
 BRG=S 22°40'29" E

STATE HIGHWAY #80

TRACT 3  
 PREVIOUS SURVEY  
 BY LARRY AUSTIN  
 DATED 10-12-2007  
 JOB NO. 07s298

TRACT 1  
 0.61± ACRES  
 26,753± SQ.FT.

TRACT 2  
 PREVIOUS SURVEY  
 BY LARRY AUSTIN  
 DATED 10-12-2007  
 JOB NO. 07s298

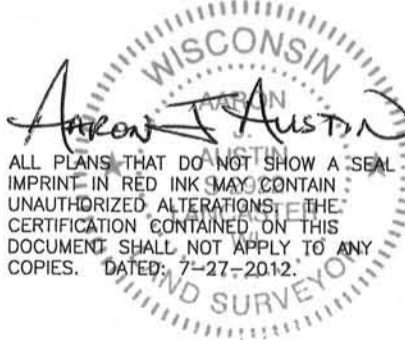

ALL PLANS THAT DO NOT SHOW A SEAL IMPRINT IN RED INK MAY CONTAIN UNAUTHORIZED ALTERATIONS. THE CERTIFICATION CONTAINED ON THIS DOCUMENT SHALL NOT APPLY TO ANY COPIES. DATED: 7-27-2012.

0 60 120  
 SCALE 1" = 60'

**Austin Engineering LLC**  
 austinengineeringllc.com  
 4211 HWY 81 E, LANCASTER, WI 53813  
 PHONE: 608-723-6363 FAX: 608-723-6702

Prepared for: PAUL PLACE

JOB NO: 12s132  
 G:\T2NR1W\17  
 H:\PLAT\T2NR1W\25\12s132-CLAYTON

FIELDBOOK: TDSR  
 DRAWN BY: AJ AUSTIN  
 CREW: BS-SB

SHEET 1 OF 2

# PLAT OF SURVEY

## TRACT 1 DESCRIPTION:

Located in the Southwest Quarter (SW 1/4) of the Northeast Quarter (NE 1/4) of Section Twenty-five (25), Township Two (2) North, Range One (1) West of the 4th P.M., Town of Smelser, Grant County, Wisconsin, containing 0.61 acre, more or less, and being described as follows:

Commencing at the East Quarter (E 1/4) corner of said Section 25;  
thence North  $89^{\circ} 31' 59''$  West 2438.40 feet along the South line of the Northeast Quarter (NE 1/4) of said Section to the Westerly right of way of Highway # 80 and the point of beginning;  
thence North  $89^{\circ} 31' 59''$  West 162.65 feet along said South line to the Southwest corner of that property as described in Parcel 2 of Volume 1016, Page 952 recorded as Document No. 665811, Grant County Registry;  
thence North  $00^{\circ} 35' 36''$  East 294.72 feet along the West line of said Parcel 2 of that property described in Volume 1016, Page 952;  
thence South  $35^{\circ} 24' 24''$  East 150.36 feet along the Northerly line of Parcel 1 of that property described in Volume 1016, Page 952 to the Westerly right of way of Highway #80;  
thence 188.11 feet on the arc of a curve to the left having a radius of 1680.00 feet and a long chord bearing South  $22^{\circ} 40' 29''$  East 188.01 feet along said right of way to the point of beginning.

Tract being subject to any and all easements of record and/or usage.

## EASEMENT NOTES:

Other documentation will need to be recorded to clarify the intent, use, maintenance, assignments or other pertinent information of this easement.

## SURVEYOR'S CERTIFICATE:

I, Aaron J. Austin, Registered Wisconsin Land Surveyor, hereby certify:

That the above description was surveyed, mapped and monumented as shown on this plat by me or under my direct supervision.

That conformance with local ordinances are not guaranteed with this survey.

That this survey was prepared under the instructions of .

That to the best of my knowledge and belief, this plat is an accurate representation thereof.

That all plans that do not show a seal imprint in red ink may contain unauthorized alterations.

The certification contained on this document shall not apply to any copies.

Dated this 27th day of July, 2012

  
Aaron J. Austin, S-2922

S-2922  
LANCASTER  
WI

## SURVEYOR'S NOTES:

Surveyor has made no investigation for easements of record, encumbrances, restrictive covenants, ownership title evidence except as specifically shown on this plat. No distance should be assumed by scaling. No improvements have been located unless shown and noted. No representation as to ownership, use or possession should be hereon implied. Refer to abstract, title or local ordinances for any additional restriction, easements or building setback lines. No abstract, nor title commitment, nor results of title searches were furnished the surveyor.



Austin  
Engineering LLC  
austinengineeringllc.com

4211 HWY 81 E, LANCASTER, WI 53813  
PHONE: 608-723-6363 FAX: 608-723-6702

Prepared for: PAUL PLACE

JOB NO: 12s132  
G:\T2NR1W\17  
H:\PLAT\T2NR1W\25\12s132-CLAYTON

FIELDBOOK: TDSR  
DRAWN BY: AJ AUSTIN  
CREW: BS-SB

SHEET 2 OF 2