

PLAT OF SURVEY

Aaron J. Austin
 LAND SURVEYOR
 ALL PLANS THAT DO NOT SHOW A SEAL IMPRINT IN RED INK MAY CONTAIN UNAUTHORIZED ALTERATIONS. THE CERTIFICATION CONTAINED ON THIS DOCUMENT SHALL NOT APPLY TO ANY COPIES. DATED: 4-27-2012.

TRACT 1
 PREVIOUS SURVEY
 BY AARON AUSTIN
 DATED 4-21-2011
 JOB NO. 11s076

[1279-769]
 SOUTH 1/4 CORNER SECTION 33, T6N R3W
 NORTH 1/4 CORNER SECTION 4, T5N R3W

TRACT 4
 PREVIOUS SURVEY
 BY AARON J. AUSTIN
 REVISED 5-26-2011
 JOB NO. 11s096

TRACT 3
 1.03± ACRES
 45,025± SQ.FT.

TRACT 5
 PREVIOUS SURVEY
 BY AARON J. AUSTIN
 REVISED 5-26-2011
 JOB NO. 11s096

TRACT 5
 [1285-311]

TRACT 2
 0.18± ACRES
 7,691± SQ.FT.

TRACT 6
 [1285-311]

TRACT 1
 9.35± ACRES
 407,194± SQ.FT.

PART OF TRACT 6
 PREVIOUS SURVEY
 BY AARON J. AUSTIN
 REVISED 5-26-2011
 JOB NO. 11s096

TRACT 8
 PREVIOUS SURVEY
 BY AARON J. AUSTIN
 REVISED 5-26-2011
 JOB NO. 11s096

TRACT 7B
 PREVIOUS SURVEY
 BY AARON J. AUSTIN
 REVISED 5-26-2011
 JOB NO. 11s096

TRACT 7A
 PREVIOUS SURVEY
 BY AARON J. AUSTIN
 REVISED 5-26-2011
 JOB NO. 11s096

LEGEND

- ⊕ No. 8 rebar found with Grant County Aluminum Cap
- No. 6 rebar found
- No. 6 x 18" rebar set with cap
- + No monument set
- [-] Property described in Volume and Page, Grant County Registry

P.O.B. EASE. #1

66' WIDE
 INGRESS-EGRESS
 EASEMENT

C.T.H.

Right of way for County Highway "K" established from R/W Project No. 5805-0-00 and Document No. 486098, Grant County Registry.

The South line of the SW 1/4 of Section 33 is assumed to bear S 89°27'58" E.

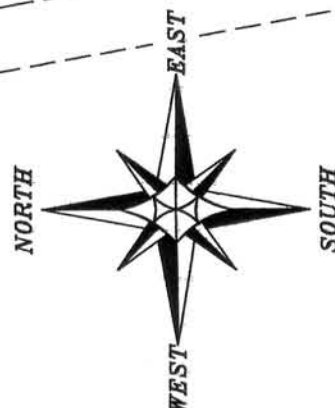
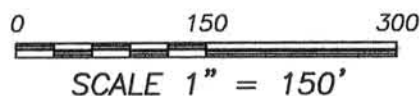

Prepared for: TOM WALL



4211 HWY 81 E, LANCASTER, WI 53813
 PHONE: 608-723-6363 FAX: 608-723-6702

JOB NO: 12s075
 G:\T6NR3W\33A
 H:\PLAT\T5NR3W\04\12s075-WALL

FIELDBOOK: TDSR
 DRAWN BY: AJ AUSTIN
 CREW: BS-SB

PLAT OF SURVEY

TRACT 1 DESCRIPTION:

Located in the Northwest Quarter (NW 1/4) of the Northwest Quarter (NW 1/4) of Section Four (4), Township Five (5) North, Range Three (3) West of the 4th P.M., Town of North Lancaster and in the Southwest Quarter (SW 1/4) of the Southwest Quarter (SW 1/4) of Section Thirty-three (33), Township Six (6) North, Range Three (3) West of the 4th P.M., Town of Mount Ida, Grant County, Wisconsin, containing 9.35 acres, more or less, and being described as follows:

Commencing at the Southwest corner of said Section 33;
thence South 89° 27' 58" East 26.40 feet along the South line of said Section 33;
thence continuing South 89° 27' 58" East 1300.14 feet along the South line of said Section 33 to the Southeast corner of the Southwest Quarter (SW 1/4) of the Southwest Quarter (SW 1/4) thereof and the point of beginning;
thence North 00° 02' 12" West 341.33 feet along the East line of the Southwest Quarter (SW 1/4) of the Southwest Quarter (SW 1/4) of said Section 33;
thence South 84° 51' 59" West 665.12 feet along a line of that property as described in Tract 6 of Volume 1285, Page 311 recorded as Document No. 737272, Grant County Registry;
thence South 08° 41' 47" West 240.02 feet along a line of said Tract 6;
thence South 51° 49' 04" East 536.12 feet along a line of said Tract 6;
thence South 01° 47' 00" West 52.79 feet along a line of said Tract 6;
thence continuing South 01° 47' 00" West 190.82 feet along a line of said Tract 6;
thence North 83° 47' 17" East 287.13 feet along a line of said Tract 6;
thence North 00° 02' 12" West 499.28 feet to the point of beginning.
Tract being subject to any and all easements of record and/or usage, including, but not limited to the following described access easement:

ACCESS EASEMENT:

A Sixty-six foot wide access easement for ingress-egress being located in the Northwest Quarter (NW 1/4) of the Northwest Quarter (NW 1/4) of Section Four (4), Township Five (5) North, Range Three (3) West of the 4th P.M., Town of North Lancaster and in the Southwest Quarter (SW 1/4) of the Southwest Quarter (SW 1/4) of Section Thirty-three (33), Township Six (6) North, Range Three (3) West of the 4th P.M., Town of Mount Ida, Grant County, Wisconsin, said easement being bound and described as follows:

Commencing at the Southwest corner of said Section 33;
thence South 89° 27' 58" East 26.40 feet along the South line of said Section 33;
thence continuing South 89° 27' 58" East 1300.14 feet along the South line of said Section 33 to a No. 6 rebar marking the Southeast corner of the Southwest Quarter (SW 1/4) of the Southwest Quarter (SW 1/4) thereof;
thence North 00° 02' 12" West 341.33 feet along the East line of the Southwest Quarter (SW 1/4) of said Southwest Quarter (SW 1/4) to a No. 6 rebar;
thence South 84° 51' 59" West 665.12 feet along a line of that property as described in Volume 1279, Page 769 recorded as Document No. 735620, Grant County Registry to a No. 6 rebar;
thence South 08° 41' 47" West 240.02 feet along a line of said property described in Volume 1279, Page 769 to a No. 6 rebar marking the point of beginning;
thence South 82° 15' 14" West 313.35 feet along a line of that property as described in Volume 1279, Page 769 recorded as Document No. 735620, Grant County Registry to a No. 6 rebar on the Easterly right of way of County Highway "K";
thence South 10° 11' 27" East 66.06' along said right of way;
thence North 82° 15' 14" East 374.42 feet;
thence North 51° 49' 04" West 91.86 feet to the point of beginning.

EASEMENT NOTES:

Other documentation will need to be recorded to clarify the intent, use, maintenance, assignments or other pertinent information of this easement.

WISCONSIN
AARON
J.
AUSTIN
3-23-22
AARON J. AUSTIN
ALL PLANS THAT DO NOT SHOW A SEAL
IMPRINT IN RED INK MAY CONTAIN
UNAUTHORIZED ALTERATIONS. THE
CERTIFICATION CONTAINED ON THIS
DOCUMENT SHALL NOT APPLY TO ANY
COPIES. DATED 4-27-2012.



4211 HWY 81 E, LANCASTER, WI 53813
PHONE: 608-723-6363 FAX: 608-723-6702

Prepared for: TOM WALL

JOB NO: 12s075
G:\T6NR3W\33A
H:\PLAT\T5NR3W\04\12s075-WALL

DRAWN BY: SW AUSTIN
APPROVED: AJ AUSTIN
CREW: BS-SA-SB

SHEET 2 OF 3

PLAT OF SURVEY

TRACT 2 DESCRIPTION:

Located in the Northwest Quarter (NW 1/4) of the Northwest Quarter (NW 1/4) of Section Four (4), Township Five (5) North, Range Three (3) West of the 4th P.M., Town of North Lancaster, Grant County, Wisconsin, containing 0.18 acre, more or less, and being described as follows:

Commencing at the Northwest corner of said Section 4;
thence South 89° 27' 58" East 1300.14 feet along the North line of said Section 4 to the Southeast corner of the Southwest Quarter (SW 1/4) of the Southwest Quarter (SW 1/4) of Section 33, Township Six (6) North, Range Three (3) West of the 4th P.M., Town of Mount Ida, said corner being the point of beginning;
thence South 00° 02' 12" East 499.28 feet to the South line of that property as described in Tract 6 of Volume 1285, Page 311 recorded as Document No. 737272, Grant County Registry;
thence North 83° 47' 17" East 15.11 feet along the South line of said Tract 6 to the East line of the Northwest Quarter (NW 1/4) of the Northwest Quarter (NW 1/4) of said Section 4;
thence North 00° 03' 26" East 497.50 feet along the East line of the Northwest Quarter (NW 1/4) of said Northwest Quarter (NW 1/4) to the Northeast corner thereof;
thence North 89° 27' 58" West 15.84 feet along the North line of said Section 4 to the point of beginning. Tract being subject to any and all easements of record and/or usage.

TRACT 3 DESCRIPTION:

Located in the Northeast Quarter (NE 1/4) of the Northwest Quarter (NW 1/4) of Section Four (4), Township Five (5) North, Range Three (3) West of the 4th P.M., Town of North Lancaster and in the Southeast Quarter (SE 1/4) of the Southwest Quarter (SW 1/4) of Section Thirty-three (33), Township Six (6) North, Range Three (3) West of the 4th P.M., Town of Mount Ida, Grant County, Wisconsin, containing 1.03 acres, more or less, and being described as follows:

Commencing at the Southwest corner of said Section 33;
thence South 89° 27' 58" East 26.40 feet along the South line of said Section 33;
thence continuing South 89° 27' 58" East 1300.14 feet along the South line of said Section 33 to the Southeast corner of the Southwest Quarter (SW 1/4) of the Southwest Quarter (SW 1/4) thereof and the point of beginning;
thence North 00° 02' 12" West 341.33 feet along the East line of the Southwest Quarter (SW 1/4) of the Southwest Quarter (SW 1/4) of said Section 33;
thence North 84° 51' 59" East 5.22 feet along a line of that property as described in Tract 5 of Volume 1285, Page 311 recorded as Document No. 737272, Grant County Registry;
thence South 05° 16' 24" East 521.37 feet along a line of said Tract 5;
thence South 23° 00' 19" East 335.48 feet along a line of said Tract 5;
thence South 86° 06' 24" West 169.06 feet along a line of said Tract 5 to the East line of the Northwest Quarter (NW 1/4) of the Northwest Quarter (NW 1/4) of said Section 4;
thence North 00° 03' 26" East 497.50 feet along said East line to the Northeast corner thereof;
thence North 89° 27' 58" West 15.84 feet along the North line of said Section 4 to the point of beginning. Tract being subject to any and all easements of record and/or usage.

SURVEYOR'S CERTIFICATE:

I, Aaron J. Austin, Registered Wisconsin Land Surveyor, hereby certify:

That the descriptions hereon were surveyed, mapped and monumented as shown on this plat by me or under my direct supervision.

That conformance with local ordinances are not guaranteed with this survey.

That this survey was prepared under the instructions of Tom Wall.

That to the best of my knowledge and belief, this plat is an accurate representation thereof.

That all plans that do not show a seal imprint in red ink may contain unauthorized alterations.

The certification contained on this document shall not apply to any copies.

Dated this 27th day of April, 2012

Aaron J. Austin, S-2922

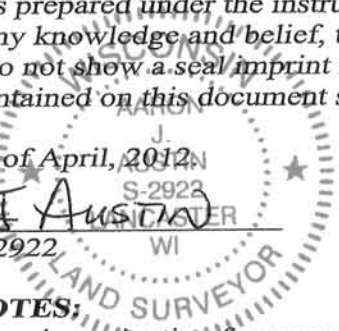

SURVEYOR'S NOTES:

Surveyor has made no investigation for easements of record, encumbrances, restrictive covenants, ownership title evidence except as specifically shown on this plat. No distance should be assumed by scaling. No improvements have been located unless shown and noted. No representation as to ownership, use or possession should be hereon implied. Refer to abstract, title or local ordinances for any additional restriction, easements or building setback lines. No abstract, nor title commitment, nor results of title searches were furnished to the surveyor.

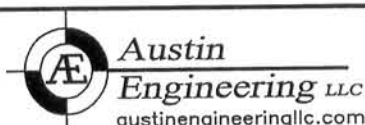

Austin

Engineering LLC

austinengineeringllc.com

4211 HWY 81 E, LANCASTER, WI 53813
PHONE: 608-723-6363 FAX: 608-723-6702

Prepared for: TOM WALL

JOB NO: 12s075
G: T6NR3W\33A
H: \PLAT\T5NR3W\04\12s075-WALL

DRAWN BY: SW AUSTIN
APPROVED: AJ AUSTIN
CREW: BS-SA-SB

SHEET 3 OF 3