

28/69

PLAT OF SURVEY

TRACT 2 DESCRIPTION:

Located in the Northeast Quarter (NE 1/4) of the Northeast Quarter (NE 1/4) and the Southeast Quarter (SE 1/4) of the Northeast Quarter (NE 1/4) of Section Thirty-three (33), Township Six (6) North, Range Six (6) West of the 4th P.M., Town of Wyalusing, Grant County, Wisconsin, containing 15.36 acres, more or less, and being described as follows:

Commencing at the East Quarter (E 1/4) corner of said Section 33;
thence South 89° 44' 21" West 1314.97 feet to the Southwest corner of the Southeast Quarter (SE 1/4) of the Northeast Quarter (NE 1/4) of said Section 33;
thence North 00° 40' 08" West 327.15 feet along the West line of the Southeast Quarter (SE 1/4) of the Northeast Quarter (NE 1/4) of said Section 33 to the point of beginning;
thence South 82° 15' 12" East 381.69 feet to a No. 6 rebar;
thence North 01° 20' 09" East 213.22 feet to a No. 6 rebar;
thence North 26° 15' 39" East 294.76 feet to a No. 6 rebar;
thence North 05° 32' 41" West 539.70 feet to a No. 6 rebar;
thence North 70° 27' 56" East 180.03 feet to a No. 6 rebar;
thence North 59° 11' 03" East 143.64 feet to a No. 6 rebar marking the Southwest corner of Lot 4 of Certified Survey Map No. 1334, recorded in Volume 12 of Certified Survey Maps on Pages 27-29, recorded as Document No. 697345, Grant County Registry;
thence North 06° 44' 24" West 208.08 feet along the West line of said Lot 4 to a No. 6 rebar;
thence South 61° 01' 59" West 185.01 feet along a line of that property as described in Volume 856, Page 09 recorded as Document No. 621756, Grant County Registry to a No. 6 rebar;
thence North 88° 20' 34" West 73.52 feet along the a line of said property described in Volume 856, Page 09 to a No. 6 rebar;
thence North 73° 43' 01" West 195.63 feet along the a line of said property described in Volume 856, Page 09 to a No. 6 rebar;
thence North 76° 29' 07" West 151.24 feet along the a line of said property described in Volume 856, Page 09 to a No. 6 rebar;
thence South 87° 25' 18" West 57.35 feet along the a line of said property described in Volume 856, Page 09 to a No. 6 rebar;
thence South 65° 25' 43" West 60.54 feet along the a line of said property described in Volume 856, Page 09 to a No. 6 rebar;
thence South 73° 11' 01" West 65.00 feet along the a line of said property described in Volume 856, Page 09 to a No. 6 rebar on the West line of the East Half (E 1/2) of said Northeast Quarter (NE 1/4);
thence South 00° 40' 08" East 1259.90 feet along said West line to the point of beginning. Tract being subject to any and all easements of record and/or usage.

SURVEYOR'S CERTIFICATE:

I, Aaron J. Austin, Registered Wisconsin Land Surveyor, hereby certify:

That the descriptions hereon were surveyed, mapped and monumented as shown on this plat by me or under my direct supervision.

That conformance with local ordinances are not guaranteed with this survey.

That this survey was prepared under the instructions of Gary Schier.

That to the best of my knowledge and belief, this plat is an accurate representation thereof.

That all plans that do not show a seal imprint in red ink may contain unauthorized alterations.

The certification contained on this document shall not apply to any copies.

Dated this 1st day of November, 2010.

Revised this 21st day of December, 2010. (MAP ONLY)

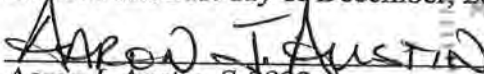
Aaron J. Austin, S-2922

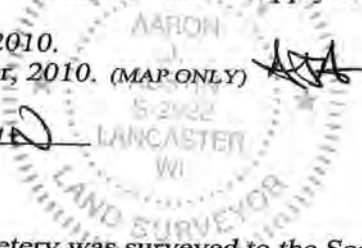

SURVEYOR'S NOTES:

The occupied location of the Cemetery was surveyed to the Section line as the best available evidence of the intended location of the lines as described in Part of Parcel III of [1215-550]. Other documentation may need to be recorded to clarify the location of the lines as surveyed hereon. See Surveyor's Note #1 and #2 on sheet 1. Surveyor has made no investigation for easements of record, encumbrances, restrictive covenants, ownership title evidence except as specifically shown on this plat. No distance should be assumed by scaling. No improvements have been located unless shown and noted. No representation as to ownership, use or possession should be hereon implied. Refer to abstract, title or local ordinances for any additional restriction, easements or building setback lines. No abstract, nor title commitment, nor results of title searches were furnished the surveyor.

DEC 27 2010



Prepared for: GARY SCHIER

4211 HWY 81 E, LANCASTER, WI 53813
PHONE: 608-723-6363 FAX: 608-723-6702

JOB NO: 10s196-B
G:\T6NR6W\33A
H:\PLAT\T6NR6W\33\10s196-B-SCHIER

FIELDBOOK: TDSR
DRAWN BY: AJ AUSTIN
CREW: BS-SB-BD

SHEET 3 OF 3

28/69

PLAT OF SURVEY

TRACT 1 DESCRIPTION:

Located in the Northeast Quarter (NE 1/4) of the Northeast Quarter (NE 1/4) and the Southeast Quarter (SE 1/4) of the Northeast Quarter (NE 1/4) of Section Thirty-three (33) and the Northwest Quarter (NW 1/4) of the Northwest Quarter (NW 1/4) and the Southwest Quarter (SW 1/4) of the Northwest Quarter (NW 1/4) of Section Thirty-four (34), Lot 1 of Certified Survey Map No. 641, recorded in Volume 5 of Certified Survey Maps on Page 82, recorded as Document No. 618986, and Part of Lot 2 of Certified Survey Map No. 642, recorded in Volume 5 of Certified Survey Maps on Pages 83-84, recorded as Document No. 618987, Grant County Registry, all being in Township Six (6) North, Range Six (6) West of the 4th P.M., Town of Wyalusing, Grant County, Wisconsin, containing 66.42 acres, more or less, and being described as follows:

Commencing at the East Quarter (E 1/4) corner of said Section 33, said corner being the point of beginning;
thence South 89° 44' 21" West 1314.97 feet to the Southwest corner of the Southeast Quarter (SE 1/4) of the Northeast Quarter (NE 1/4) of said Section 33;
thence North 00° 40' 08" West 327.15 feet along the West line of the Southeast Quarter (SE 1/4) of the Northeast Quarter (NE 1/4) of said Section 33;
thence South 82° 15' 12" East 381.69 feet to a No. 6 rebar;
thence North 01° 20' 09" East 213.22 feet to a No. 6 rebar;
thence North 26° 15' 39" East 294.76 feet to a No. 6 rebar;
thence North 05° 32' 41" West 539.70 feet to a No. 6 rebar;
thence North 70° 27' 56" East 180.03 feet to a No. 6 rebar;
thence North 59° 11' 03" East 143.64 feet to a No. 6 rebar marking the Southwest corner of Lot 4 of Certified Survey Map No. 1334, recorded in Volume 12 of Certified Survey Maps on Pages 27-29, recorded as Document No. 697345, Grant County Registry;
thence North 77° 16' 53" East 402.94 feet along the South line of Lot 4 of said Certified Survey Map No. 1334 to a No. 6 rebar;
thence South 83° 23' 38" East 339.68 feet along the South line of Lot 1 of Certified Survey Map No. 1552, recorded in the Volume 14 of Certified Survey Maps on Pages 163-164, recorded as Document No. 730440, Grant County Registry to a No. 6 rebar;
thence North 52° 08' 49" East 271.10 feet along the South line of Lot 1 of said Certified Survey Map No. 1552;
thence South 40° 02' 35" East 569.19 feet along the centerline of County Highway "X";
thence 599.79 feet on the arc of a curve to the right having a radius of 5732.29 feet and a long chord bearing South 37° 02' 44" East 599.51 feet along said centerline;
thence South 34° 02' 53" East 383.03 feet along said centerline to a point on the East line of the Southwest Quarter (SW 1/4) of the Northwest Quarter (NW 1/4) of said Section 34;
thence South 00° 14' 19" East 395.50 feet along said East line to the Southeast corner thereof;
thence South 89° 41' 45" West 417.64 feet along the South line of the Northwest Quarter (NW 1/4) of said Section 34;
thence North 02° 09' 05" West 159.78 feet to a No. 6 rebar;
thence South 88° 13' 22" West 236.30 feet to a No. 6 rebar;
thence South 00° 28' 03" East 153.62 feet to the South line of the Northwest Quarter (NW 1/4) of said Section 34;
thence South 89° 41' 45" West 665.16 feet along said South line to the point of beginning. Tract being subject to any and all easements of record and/or usage.

AREA TABLE	
TRACT 1:	
SECTION 33:	
NE-NE =	2.16± ACRES
SE-NE =	29.13± ACRES
SECTION 34:	
NW-NW =	2.69± ACRES
SW-NW =	32.44± ACRES
TRACT 2:	
SECTION 33:	
NE-NE =	4.47± ACRES
SE-NE =	10.89± ACRES

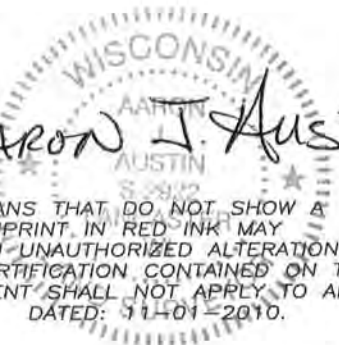
 Aaron J. Austin
 ALL PLANS THAT DO NOT SHOW A SEAL IMPRINT IN RED INK MAY CONTAIN UNAUTHORIZED ALTERATIONS. THE CERTIFICATION CONTAINED ON THIS DOCUMENT SHALL NOT APPLY TO ANY COPIES. DATED: 11-01-2010.



Prepared for: GARY SCHIER

4211 HWY 81 E, LANCASTER, WI 53813
PHONE: 608-723-6363 FAX: 608-723-6702

JOB NO: 10s196-B
G:\T6NR6W\33A
H:\PLAT\T6NR6W\33\10s196-B-SCHIER

FIELDBOOK: TDSR
DRAWN BY: AJ AUSTIN
CREW: BS-SB-BD

28/69

PLAT OF SURVEY

TRACT 2 DESCRIPTION:

Located in the Northeast Quarter (NE 1/4) of the Northeast Quarter (NE 1/4) and the Southeast Quarter (SE 1/4) of the Northeast Quarter (NE 1/4) of Section Thirty-three (33), Township Six (6) North, Range Six (6) West of the 4th P.M., Town of Wyalusing, Grant County, Wisconsin, containing 15.36 acres, more or less, and being described as follows:

Commencing at the East Quarter (E 1/4) corner of said Section 33;
thence South 89° 44' 21" West 1314.97 feet to the Southwest corner of the Southeast Quarter (SE 1/4) of the Northeast Quarter (NE 1/4) of said Section 33;
thence North 00° 40' 08" West 327.15 feet along the West line of the Southeast Quarter (SE 1/4) of the Northeast Quarter (NE 1/4) of said Section 33 to the point of beginning;
thence South 82° 15' 12" East 381.69 feet to a No. 6 rebar;
thence North 01° 20' 09" East 213.22 feet to a No. 6 rebar;
thence North 26° 15' 39" East 294.76 feet to a No. 6 rebar;
thence North 05° 32' 41" West 539.70 feet to a No. 6 rebar;
thence North 70° 27' 56" East 180.03 feet to a No. 6 rebar;
thence North 59° 11' 03" East 143.64 feet to a No. 6 rebar marking the Southwest corner of Lot 4 of Certified Survey Map No. 1334, recorded in Volume 12 of Certified Survey Maps on Pages 27-29, recorded as Document No. 697345, Grant County Registry;
thence North 06° 44' 24" West 208.08 feet along the West line of said Lot 4 to a No. 6 rebar;
thence South 61° 01' 59" West 185.01 feet along a line of that property as described in Volume 856, Page 09 recorded as Document No. 621756, Grant County Registry to a No. 6 rebar;
thence North 88° 20' 34" West 73.52 feet along the a line of said property described in Volume 856, Page 09 to a No. 6 rebar;
thence North 73° 43' 01" West 195.63 feet along the a line of said property described in Volume 856, Page 09 to a No. 6 rebar;
thence North 76° 29' 07" West 151.24 feet along the a line of said property described in Volume 856, Page 09 to a No. 6 rebar;
thence South 87° 25' 18" West 57.35 feet along the a line of said property described in Volume 856, Page 09 to a No. 6 rebar;
thence South 65° 25' 43" West 60.54 feet along the a line of said property described in Volume 856, Page 09 to a No. 6 rebar;
thence South 73° 11' 01" West 65.00 feet along the a line of said property described in Volume 856, Page 09 to a No. 6 rebar on the West line of the East Half (E 1/2) of said Northeast Quarter (NE 1/4);
thence South 00° 40' 08" East 1259.90 feet along said West line to the point of beginning. Tract being subject to any and all easements of record and/or usage.

SURVEYOR'S CERTIFICATE:

I, Aaron J. Austin, Registered Wisconsin Land Surveyor, hereby certify:

That the descriptions hereon were surveyed, mapped and monumented as shown on this plat by me or under my direct supervision.

That conformance with local ordinances are not guaranteed with this survey.

That this survey was prepared under the instructions of Gary Schier.

That to the best of my knowledge and belief, this plat is an accurate representation thereof.

That all plans that do not show a seal imprint in red ink may contain unauthorized alterations.

The certification contained on this document shall not apply to any copies.

Dated this 1st day of November, 2010.

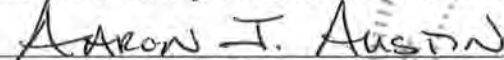
Aaron J. Austin, S-2922

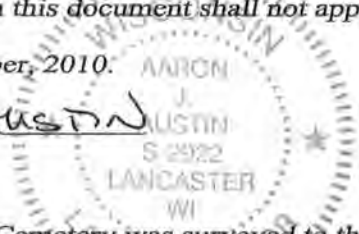

SURVEYOR'S NOTES:

The occupied location of the Cemetery was surveyed to the Section line as the best available evidence of the intended location of the lines as described in Part of Parcel III of [1215-550]. Other documentation may need to be recorded to clarify the location of the lines as surveyed hereon. See Surveyor's Note #1 and #2 on sheet 1. Surveyor has made no investigation for easements of record, encumbrances, restrictive covenants, ownership title evidence except as specifically shown on this plat. No distance should be assumed by scaling. No improvements have been located unless shown and noted. No representation as to ownership, use or possession should be hereon implied. Refer to abstract, title or local ordinances for any additional restriction, easements or building setback lines. No abstract, nor title commitment, nor results of title searches were furnished the surveyor.



Austin
Engineering LLC
austinengineeringllc.com

4211 HWY 81 E, LANCASTER, WI 53813
PHONE: 608-723-6363 FAX: 608-723-6702

Prepared for: GARY SCHIER

JOB NO: 10s196-B
G:\T6NR6W\33A
H:\PLAT\T6NR6W\33\10s196-B-SCHIER

FIELDBOOK: TDSR
DRAWN BY: AJ AUSTIN
CREW: BS-SB-BD