

PLAT OF SURVEY

TRACT 1 DESCRIPTION:

Located in the Southwest Quarter (SW 1/4) of the Northwest Quarter (NW 1/4) of Section Two (2) and the Southeast Quarter (SE 1/4) of the Northeast Quarter (NE 1/4) of Section Three (3), Township Seven (7) North, Range Three (3) West of the 4th P.M., Town of Marion, Grant County, Wisconsin, containing 2.66 acres, more or less, and being described as follows:

Commencing at the East Quarter (E 1/4) corner of said Section 3;
thence North $00^{\circ} 12' 03''$ East 1319.73 feet along the East line of Section 3 to the Northeast corner of the Southeast Quarter (SE 1/4) of the Northeast Quarter (NE 1/4) thereof, said corner being the point of beginning;
thence North $89^{\circ} 53' 07''$ West 220.48 feet along the South line of that property as described in Volume 728, Page 754, recorded as Document No. 566816, Grant County Registry;
thence South $13^{\circ} 29' 48''$ West 457.01 feet;
thence South $76^{\circ} 23' 53''$ East 148.75 feet;
thence South $75^{\circ} 30' 35''$ East 101.33 feet to a point in the centerline of Highway #61;
thence North $10^{\circ} 51' 39''$ East 513.35 feet along said centerline to the North line of the Southwest Quarter (SW 1/4) of the Northwest Quarter (NW 1/4) of said Section 2;
thence North $89^{\circ} 23' 39''$ West 12.27 feet along the North line of the Southwest Quarter (SW 1/4) of the Northwest Quarter (NW 1/4) of said Section 2 to the point of beginning.

SURVEYOR'S CERTIFICATE:

I, Aaron J. Austin, Registered Wisconsin Land Surveyor, hereby certify:

That the above description was surveyed, mapped and monumented as shown on this plat by me or under my direct supervision.

That conformance with local ordinances are not guaranteed with this survey.

That this survey was prepared under the instructions of Donna Glasbrenner.

That to the best of my knowledge and belief, this plat is an accurate representation thereof.

That all plans that do not show a seal imprint in red ink may contain unauthorized alterations.

The certification contained on this document shall not apply to any copies.

Dated this 9th day of September, 2010.

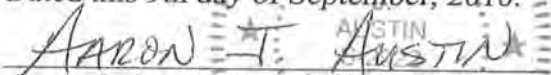
Aaron J. Austin, S-2922

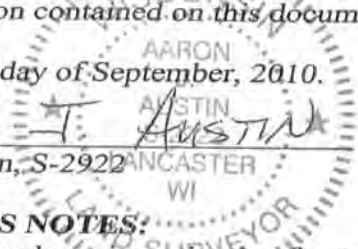

SURVEYOR'S NOTES:

Surveyor has made no investigation for easements of record, encumbrances, restrictive covenants, ownership title evidence except as specifically shown on this plat. No distance should be assumed by scaling. No improvements have been located unless shown and noted. No representation as to ownership, use or possession should be hereon implied. Refer to abstract, title or local ordinances for any additional restriction, easements or building setback lines. No abstract, nor title commitment, nor results of title searches were furnished the surveyor.



Austin
Engineering LLC
austinengineeringllc.com

4211 HWY 81 E, LANCASTER, WI 53813
PHONE: 608-723-6363 FAX: 608-723-6702

Prepared for: DONNA GLASBRENNER

JOB NO: 10s182
G:\T8NR2W\HWY133
H:\PLAT\T7NR3W\03\10s182-GLASBRENNER

FIELDBOOK: TDSR
DRAWN BY: AJ AUSTIN
CREW: BS-SB-BD

SHEET 2 OF 2