

**OWNERS:**  
Jeffry A. Jensen and Karen M. Jensen, husband and wife,  
as survivorship marital property

Midwest Title Corporation Case No.: 13815T

**SCHEDULE B EXCEPTIONS:**  
10. Easement granted to Grant County Cooperative Rural Electric Association by instrument dated May 9, 1938, and recorded in Volume 2 of Rural Electric Easements, page 578 on October 23, 1940. (Blanket Easement)

11. Right of Way Authorization granted to Dickeyville Telephone Corp., by instrument dated June 19, 1974, and recorded in Volume 498 of Records, page 304 on July 22, 1974. (Telephone Easement along pre-2000 CTH "HH" Right-of-way in the NW 1/4 of the NE 1/4)

12. Right-of-Way Easement granted to Dickeyville Telephone Co. and Scenic Rivers Cooperative by instrument dated October 30, 2000, and recorded in Volume 860 of Records, page 328 on November 15, 2000. (Telephone Easement along CTH "HH" Right-of-Way, SEE MAP)

13. Mortgage from Jeffry A. Jensen and Karen M. Jensen, husband and wife, as survivorship marital property, to Mound City Bank, dated May 6, 2004, and recorded in Volume 1023 of Records, page 226, Document #667354, on May 11, 2004, in the original amount of \$302,000.00.

14. Mortgage from Jeffry A. Jensen and Karen M. Jensen, husband and wife, as survivorship marital property, to Mound City Bank, dated March 13, 2007, and recorded in Volume 1130 of Records, page 20, Document #696582, on March 14, 2007, in the original amount of \$155,000.00 maximum.

15. Terms, conditions and provisions of Lease to be executed.

TAX ID No.:  
46-1022-000  
46-1024-000  
46-1025-000  
46-1026-000

**DESCRIPTION:**  
DOCUMENT NO. 529783  
The Northeast Quarter (N.E.1/4) of Section Thirty-six (36), Township Two (2) North, Range Two (2) West of the 4th P.M., Grant County, Wisconsin.  
EXCEPT a parcel of land conveyed to Grant County by Warranty Deed recorded in Volume 859 of Records, page 59.

Subject to Hill Road Rights-of-Way.  
Subject to potential rights of others created by fence encroachments onto the subject property, as shown hereon.  
Including potential rights to lands lying between the described property and existing fence lines, as shown hereon.

Subject to potential overhead beam path restrictions.

- SURVEYOR'S NOTES:**
- FENCE ENCROACHMENTS ONTO SUBJECT PROPERTY: (SEE MAP)  
East line of the NE 1/4; approximately 0 to 2 feet.  
West line of the NE 1/4; approximately 5 to 10 feet.
  - FENCE ENCROACHMENTS ONTO ADJOINING PROPERTIES: (SEE MAP)  
East line of the NE 1/4; approximately 0 to 2 feet.
  - No observable evidence of site use as a solid dump, sump or sanitary landfill.
  - No observable evidence of earth moving work, building construction or building additions within recent months.
  - This survey conducted during the winter of 2008-2009. Observable evidence may have been obscured due to snow cover.
  - Access to adjoining properties has been restricted by the Grant County Sheriffs Department, requiring written permission to be granted by the property owner.
  - The Client has waived the requirements of Chapter A-E 7.07 of the Wisconsin Administrative Code requiring the placement of monuments at property corners.

**FLOOD ZONE NOTE:**  
Flood Insurance Rate Map (FIRM) Number: 555557 0400 B and 555557 0425 B  
Flood Zone: "C"

**UTILITY NOTES:**  
Underground utilities have not been field located. Utilities, as shown on this map, are approximate.  
Contact Diggers Hotline at 1-800-242-8511 prior to excavation for exact location of underground utilities.  
Local Utility Companies Include:  
WE ENERGIES  
DICKEVILLE TELEPHONE CORPORATION  
CUBA CITY MUNICIPAL UTILITIES  
CUBA CITY/BELMONT TELEPHONE  
SCENIC RIVERS ENERGY COOPERATION  
ALLIANT ENERGY CORPORATION  
CENTURYTEL  
DAIRYLAND POWER COOPERATIVE

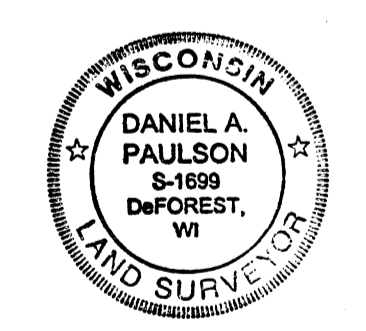

**Surveyor's Certificate**  
To White Oak Wind, LLC and Stewart National Title Services:  
This is to certify that this map or plat and the survey on which it is based were made in accordance with the "Minimum Standard Detail Requirements for ALTA/ACSM Land Title Surveys", jointly established and adopted by ALTA and NSPS in 2005, and includes Items 2, 3, 4, 8, 9, 10, 11a, 14, 15, 16 and 18 of Table A thereof. Pursuant to the Accuracy Standards as adopted by ALTA and NSPS and in effect on the date of this certification, undersigned further certifies that in my professional opinion, as a land surveyor in the state of Wisconsin, the Relative Positional Accuracy of this survey does not exceed that which is specified therein.

Daniel A. Paulson  
Daniel A. Paulson RLS-1699

7-1-09  
Date:

CLIENT  
WHITE OAK WIND, LLC  
c/o Wind Capital Group, LLC  
2923 Marketplace Drive  
Madison, WI 53719

SURVEYOR  
PAULSON & ASSOCIATES, LLC  
Daniel A. Paulson  
136 West Holm Street  
DeForest, WI 53532

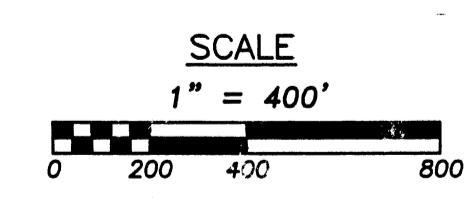
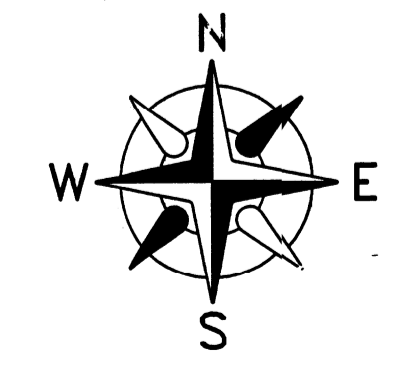
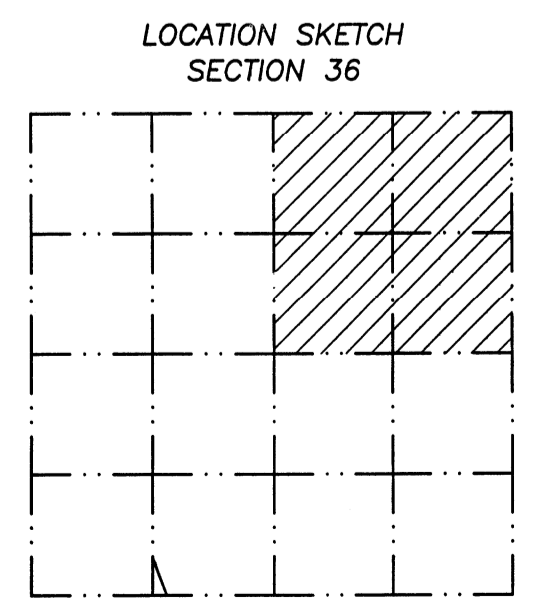

**BASIS OF BEARING**  
THE EAST LINE OF THE  
SE 1/4, SEC 36 IS ASSUMED  
TO BEAR S00°08'42"E

- LEGEND**
- GRANT COUNTY SECTION CORNER (AS NOTED)
  - 3/4" IRON RE-BAR (FOUND) (UNLESS NOTED)
  - FENCE POST
  - FENCE LINE
  - OVERHEAD UTILITIES
  - TELEPHONE PEDESTAL
  - BUILDING HEIGHT
  - FIELD ENTRANCE

NOTE: CASE NO. AS SHOWN HEREON REFERS TO THE  
MIDWEST TITLE CORPORATION TITLE SEARCH REPORT.

**PAULSON & ASSOCIATES, LLC**  
136 WEST HOLM STREET DeFOREST, WI 53532 (608)846-2523

**ALTA/ACSM LAND TITLE SURVEY**

**WHITE OAK WIND FARM**

**JEFFRY & KAREN JENSEN**  
LOCATED IN THE NE 1/4 OF THE NE 1/4, THE NW 1/4 OF THE NE 1/4,  
THE SW 1/4 OF THE NE 1/4, AND THE SE 1/4 OF THE NE 1/4,  
SECTION 36, T.2N., R.2W., TOWN OF PARIS, GRANT COUNTY, WISCONSIN

JOB NO. 08-118	DRAWING NO.	DRAWN BY: TWP
REF:	REVISIONS:	DATE: 07-01-09