

PLAT OF SURVEY

DESCRIPTION OF LINE SURVEYED:

Commencing at the East Quarter (E 1/4) corner of Section 21, Township Four (4) North, Range Two (2) West of the 4th P.M., Town of Ellenboro, Grant County, Wisconsin
 thence South 89° 54' 51" West 328.93 feet along the East-West Quarter (E-W 1/4) line of said Section to the Southwest corner of the East Half (E 1/2) of the East Half (E 1/2) of the Southeast Quarter (SE 1/4) of the Northeast Quarter (NE 1/4) thereof and the point of beginning;
 thence South 89° 54' 51" West 986.78 feet along said East-West Quarter (E-W 1/4) line to a No. 6 rebar marking the Northwest corner of the Northeast Quarter (NE 1/4) of the Southeast Quarter (SE 1/4) of said Section;
 thence South 00° 56' 49" East 1747.54 feet along the West line of the East Half (E 1/2) of the Southeast Quarter (SE 1/4) of said Section to a No. 6 rebar marking the terminus point.

SURVEYOR'S CERTIFICATE:

I, Larry L. Austin, Registered Wisconsin Land Surveyor, hereby certify:
 That the above description was surveyed, mapped and monumented as shown on this plat by me or under my direct supervision, all in accordance to the instructions of Steve Davis and to the best of my knowledge and belief, this plat is an accurate representation thereof.
 Dated this 6-10-2009. Revised 11-16-2009. Revised 11-18-2009.

Larry L. Austin
 Larry L. Austin, S-1903

NORTH 1/4 CORNER
SECTION 21, T4N R2W

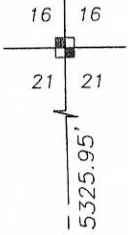

WEST 1/4 CORNER
SECTION 21, T4N R2W



S 89°54'51" W

NORTHWEST CORNER
NE 1/4, SE 1/4

E-W 1/4 LINE

35.00± ACRE SURVEY BY LARRY
AUSTIN DATED: 12-04-2008.

WEST LINE, E 1/2,
SOUTHEAST QUARTER



Bearings referenced to the
East-West Quarter line of
Section 21, which is assumed
to bear S 89°54'51" W.

LEGEND

- 1"X2"X48" Wooden lath set
- ⊙ No. 6 rebar found
- ▣ Aluminum Monument found with Grant County Aluminum Cap
- ▲ 2" diameter iron pipe found
- + No monument set
- x- Approximate location of fence

SOUTH 1/4 CORNER
SECTION 21, T4N R2W

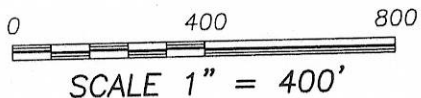

SOUTHEAST CORNER
SECTION 21, T4N R2W

Prepared For: STEVE DAVIS



Austin
Engineering LLC

4211 HWY 81 E, LANCASTER, WI 53813
 PHONE 608-723-6363 FAX 608-723-6702

JOB NO: 09S118
 FIELDBOOK: TDSR
 G:\T4NR2W\T4NR2W
 H:\PLAT\T4NR2W\21\09S118-DAVIS

DRAWN BY: SW AUSTIN
 APPROVED: LL AUSTIN
 CREW: BS-SA-BD-SB

SHEET 1 OF 1