

SURVEYOR'S NOTE:
 Tract 1 was prepared to correct the location of that property described in Volume 737, Page 882 recorded as Document No. 571044, Grant County Registry.



ALL PLANS THAT DO NOT SHOW A SEAL IMPRINT IN RED INK MAY CONTAIN UNAUTHORIZED ALTERATIONS. THIS DOCUMENT SHALL NOT APPLY TO ANY COPIES. DATED: 5-12-2009.

LEGEND

- No. 6 x 24" rebar set with cap
- ⊕ No. 8 rebar found with Grant County Aluminum Cap
- ⊕ 4" Cast Aluminum Monument found
- No. 6 rebar found
- + No monument set
- () Recorded as
- [-] Property described in Volume and Page, Grant County Registry
- *** Approximate location of fence

PLAT OF SURVEY

PREPARED FOR: KEN SMITH
 LOCATED IN SECTION 17, T1N R2W, JAMESTOWN TOWNSHIP, GRANT COUNTY, WISCONSIN



4211 HWY 91 E
 LANCASTER, WI 53593
 PHONE 608-723-6363
 FAX 608-723-6702

JOB NO: 09s085
 FIELDBOOK: TDSR
 G:\TINR2W\16
 H:\PLAN\TINR2W\17\09s085-SMITH
 SHEET 1 OF 2

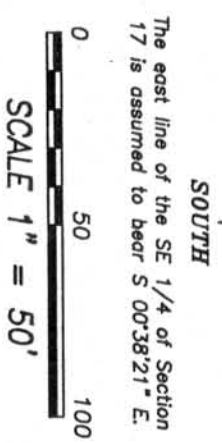

MAY 28 2009

Book 25 Page 14

PLAT OF SURVEY

TRACT 1 DESCRIPTION:

Located in the Southwest Quarter (SW 1/4) of the Southeast Quarter (SE 1/4) of Section Seventeen (17), Town One (1) North, Range Two (2) West of the 4th P.M., Jamestown Township, Grant County, Wisconsin, containing 1.02 acre, more or less, and being described as follows:

Commencing at the East Quarter (E 1/4) corner of said Section;
 thence South 00° 38' 21" East 1311.80' along the East line of said Section to the Northeast corner of the South Half (S 1/2) of the Southeast Quarter (SE 1/4) of said Section;
 thence North 89° 42' 50" West 1557.78' along the North line of the South Half (S 1/2) of said Southeast Quarter (SE 1/4) to the point of beginning;
 thence South 21° 59' 57" West 347.46';
 thence North 24° 32' 49" West 77.37';
 thence 181.42' on the arc of a curve to the left having a radius of 351.64' and a long chord bearing North 39° 19' 36" West 179.41' to Southeast corner of a previous survey by Larry Austin dated 7-10-2003;
 thence North 39° 45' 47" East 148.18' along the East line of said survey to the Northeast corner thereof;
 thence South 89° 42' 50" East 181.22' along the North line of the Southwest Quarter (SW 1/4) of said Southeast Quarter (SE 1/4) to the point of beginning.
 Tract being subject to any and all easements of record and/or usage.

TRACT 2 DESCRIPTION:

Located in the Southwest Quarter (SW 1/4) of the Southeast Quarter (SE 1/4) of Section Seventeen (17), Town One (1) North, Range Two (2) West of the 4th P.M., Jamestown Township, Grant County, Wisconsin, containing 0.72 acre, more or less, and being described as follows:

Commencing at the East Quarter (E 1/4) corner of said Section;
 thence South 00° 38' 21" East 1311.80' along the East line of said Section to the Northeast corner of the South Half (S 1/2) of the Southeast Quarter (SE 1/4) of said Section;
 thence North 89° 42' 50" West 1557.78' along the North line of the South Half (S 1/2) of said Southeast Quarter (SE 1/4);
 thence South 21° 59' 57" West 347.46' to the point of beginning;
 thence North 24° 32' 49" West 77.37';
 thence 181.42' on the arc of a curve to the left having a radius of 351.64' and a long chord bearing North 39° 19' 36" West 179.41' to Southeast corner of a previous survey by Larry Austin dated 7-10-2003;
 thence 83.44' on the arc of a curve to the left having a radius of 351.64' and a long chord bearing North 60° 54' 15" West 83.25' along the South line of said survey;
 thence North 67° 42' 07" West 92.89' along the South line of said survey;
 thence 82.92' on the arc of a curve to the right having a radius of 367.59' and a long chord bearing North 61° 14' 23" West 82.74' along the South line of said survey;
 thence North 89° 42' 50" West 8.22' along the North line of the Southwest Quarter (SW 1/4) of said Southeast Quarter (SE 1/4) to a point in the centerline of a township road known as Bluff Road;
 thence South 45° 10' 13" East 393.49' along said centerline;
 thence 129.29' on the arc of a curve to the right having a radius of 1220.00' and a long chord bearing South 42° 03' 20" East 129.23' along said centerline;
 thence North 21° 59' 57" East 52.45' to the point of beginning. Tract being subject to any and all easements of record and/or usage.

SURVEYOR'S CERTIFICATE:

I, Larry L. Austin, Registered Wisconsin Land Surveyor, hereby certify:

That the above descriptions were surveyed, mapped and monumented as shown on this plat by me or under my direct supervision.

That this survey was prepared under the instructions of Ken Smith.

That to the best of my knowledge and belief, this plat is an accurate representation thereof.

That all plans that do not show a seal imprint in red ink may contain unauthorized alterations.

The certification contained on this document shall not apply to any copies.

Dated this 12th day of May, 2009.

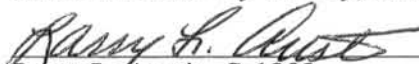
 Larry L. Austin, S-1903

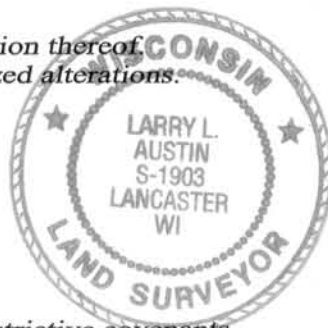

SURVEYOR'S NOTES:

Surveyor has made no investigation for easements of record, encumbrances, restrictive covenants, ownership title evidence except as specifically shown on this plat. No distance should be assumed by scaling. No improvements have been located unless shown and noted. No representation as to ownership, use or possession should be hereon implied. Refer to abstract, title or local ordinances for any additional restriction, easements or building setback lines. No abstract, nor title commitment, nor results of title searches were furnished the surveyor.



Austin Engineering LLC

Prepared For: **KEN SMITH**

4211 HWY 81 E, LANCASTER, WI 53813
 PHONE 608-723-6363 FAX 608-723-6702

JOB NO: 09s085
 FIELDBOOK: TDS RANGER
 G:\T1NR2W\16
 H:\PLAT\T1NR2W\17\09s085-SMITH

DRAWN BY: AJ AUSTIN
 APPROVED: LL AUSTIN
 CREW: SA - BD