

# PLAT OF SURVEY



ALL PLANS THAT DO NOT SHOW A SEAL IMPRINT IN RED INK MAY CONTAIN UNAUTHORIZED ALTERATIONS. THE CERTIFICATION CONTAINED ON THIS DOCUMENT SHALL NOT APPLY TO ANY COPIES. DATED: NOVEMBER 14, 2008. REVISED: FEBRUARY 2, 2009.

*Larry L. Austin*

NORTH 1/4 CORNER SECTION 27, T5N R6W

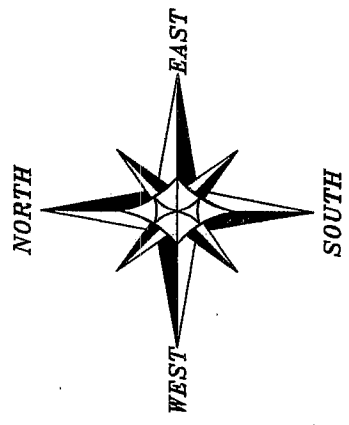

BEARINGS REFERENCED TO THE NORTH LINE OF THE NW 1/4 OF SECTION 27 WHICH IS ASSUMED TO BEAR N 89°28'24" E.

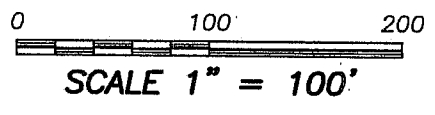

## LEGEND

- Aluminum Monument found with Grant County Aluminum Cap
- No. 8 rebar found with Grant County Aluminum Cap
- 1" diameter iron pipe found
- No. 6 rebar found
- No. 6 x 24" rebar set with cap



NORTH LINE, NW 1/4

N 89°28'24" E 915.25'

NORTHWEST CORNER SECTION 27, T5N R6W

TERMINUS POINT EASEMENT #1  
 COUNTY HIGHWAY "A"  
 CENTERLINE  
 50'  
 R.O.W.

TRACT 1  
 PREVIOUS SURVEY BY LARRY AUSTIN DATED 9-21-2004  
 JOB NO. 04s208

C3  
 L=172.88'  
 R=627.64'  
 C LEN=172.33'  
 BRG=N 82°00'29" E

N 74°07'01" E 58.56'

C2  
 L=149.81'  
 R=704.74'  
 C LEN=149.53'  
 BRG=N 80°12'25" E

N 86°17'49" E 13.84'

C1  
 L=104.01'  
 R=677.80'  
 C LEN=103.91'  
 BRG=N 81°54'03" E

PREVIOUS SURVEY BY LARRY AUSTIN DATED 5-28-2002

CENTERLINE 24' WIDE INGRESS-EGRESS EASEMENT

N 77°30'17" E 292.78'

C4  
 L=44.87'  
 R=146.80'  
 C LEN=44.69'  
 BRG=N 03°35'52" E

CENTERLINE 24' WIDE INGRESS-EGRESS EASEMENT AS SHOWN ON PREVIOUS SURVEY BY LARRY AUSTIN DATED 9-28-1997, REVISED 11-4-1997

TRACT 2  
 PREVIOUS SURVEY BY LARRY AUSTIN DATED 1-18-2006  
 JOB NO. 05s315

TRACT 3  
 0.26± ACRES  
 11,162± SQ. FT.

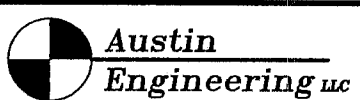

Prepared For: ROBERT TUBBS

4211 HWY 81 E, LANCASTER, WI 53813  
 PHONE 608-723-6363 FAX 608-723-6702

JOB NO: 08s242  
 FIELDBOOK: 2207  
 G:\T5NR6W\21  
 H:\PLAT\T5NR6W\27\08s242-TUBBS

DRAWN BY: AJ AUSTIN  
 APPROVED: LL AUSTIN  
 CREW: BS-SB-BD

# PLAT OF SURVEY

## TRACT 3 DESCRIPTION:

Part of the Southwest Quarter (SW 1/4) of the Northwest Quarter (NW 1/4) of Section Twenty-seven (27), Town Five (5) North, Range Six (6) West of the 4th P.M., Bloomington Township, Grant County, Wisconsin, containing 0.26 acres, more or less, and being described as follows:

Commencing at the Northwest corner of said Section;  
thence North 89° 28' 24" East 915.25' along the North line of said Section;  
thence South 08° 50' 42" East 1738.65' to the Northeast corner of a previous survey by Larry Austin dated May 28, 2002;  
thence South 78° 27' 44" West 779.24' along the North line of said survey to a 1" iron pipe;  
thence South 78° 27' 44" West 24.65' along said North line to a No. 6 rebar marking the point of beginning;  
thence South 78° 27' 44" West 172.84' to a No. 6 rebar;  
thence South 05° 09' 12" East 68.73' to a No. 6 rebar;  
thence North 78° 33' 52" East 157.55' to a No. 6 rebar;  
thence 44.87' on the arc of a curve to the right having a radius of 146.80' and a long chord bearing North 03° 35' 52" East 44.69';  
thence North 12° 21' 12" East 27.82' to the point of beginning.  
Tract being subject to any and all easements of record and/or usage.

## INGRESS-EGRESS EASEMENT #1:

A Twenty-four foot (24') wide ingress-egress easement being located in the Southwest Quarter (SW 1/4) of the Northwest Quarter (NW 1/4) of Section Twenty-seven (27), Town Five (5) North, Range Six (6) West of the 4th P.M., Bloomington Township, Grant County, Wisconsin, the centerline being described as follows:

Commencing at the Northwest corner of said Section;  
thence North 89° 28' 24" East 915.25' along the North line of said Section;  
thence South 08° 50' 42" East 1738.65' to the Northeast corner of a previous survey by Larry Austin dated May 28, 2002;  
thence South 78° 27' 44" West 779.24' along the North line of said survey to a 1" iron pipe;  
thence South 78° 27' 44" West 197.49' along said North line to a No. 6 rebar;  
thence South 05° 09' 12" East 12.07' to the point of beginning;  
thence North 78° 27' 44" East 163.87';  
thence North 77° 30' 17" East 292.78';  
thence 104.01' on the arc of a curve to the right having a radius of 677.80' and a long chord bearing North 81° 54' 03" East 103.91';  
thence North 86° 17' 49" East 13.84';  
thence 149.81' on the arc of a curve to the left having a radius of 704.74' and a long chord bearing North 80° 12' 25" East 149.53';  
thence North 74° 07' 01" East 58.56';  
thence 172.88' on the arc of a curve to the right having a radius of 627.64' and a long chord bearing North 82° 00' 29" East 172.33';  
thence North 89° 53' 56" East 73.67' to a point in the centerline of County Highway "A", said point being the terminus point.

## INGRESS-EGRESS EASEMENT #2:

A Twenty-four foot (24') wide ingress-egress easement being located in the Southwest Quarter (SW 1/4) of the Northwest Quarter (NW 1/4) of Section Twenty-seven (27), Town Five (5) North, Range Six (6) West of the 4th P.M., Bloomington Township, Grant County, Wisconsin, said easement being located Southerly of and adjacent to the following described line:

Commencing at the Northwest corner of said Section;  
thence North 89° 28' 24" East 915.25' along the North line of said Section;  
thence South 08° 50' 42" East 1738.65' to the Northeast corner of a previous survey by Larry Austin dated May 28, 2002;  
thence South 78° 27' 44" West 779.24' along the North line of said survey to a 1" iron pipe;  
thence South 78° 27' 44" West 24.65' along said North line to a No. 6 rebar marking the point of beginning;  
thence South 78° 27' 44" West 172.84' to a No. 6 rebar marking the terminus point.

## EASEMENT NOTES:

Other documentation will need to be recorded to clarify the intent, use, maintenance, assignments or other pertinent information of this easement.

## SURVEYOR'S CERTIFICATE:

I, Larry L. Austin, Registered Wisconsin Land Surveyor, hereby certify:

That the above descriptions were surveyed, mapped and monumented as shown on this plat by me or under my direct supervision.

That conformance with local ordinances are not guaranteed with this survey.

That this survey was prepared under the instructions of Robert Tubbs.

That to the best of my knowledge and belief, this plat is an accurate representation thereof.

That all plans that do not show a seal imprint in red ink may contain unauthorized alterations.

The certification contained on this document shall not apply to any copies.

Dated this 14th day of November, 2008.

Revised this 2nd day of February, 2009. (ADDED EASEMENT #2)

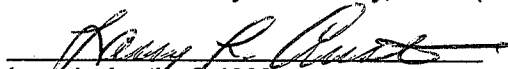
  
Larry L. Austin, S-1903



## SURVEYOR'S NOTES:

Surveyor has made no investigation for easements of record, encumbrances, restrictive covenants, ownership title evidence except as specifically shown on this plat. No distance should be assumed by scaling. No improvements have been located unless shown and noted. No representation as to ownership, use or possession should be hereon implied. Refer to abstract, title or local ordinances for any additional restriction, easements or building setback lines. No abstract, nor title commitment, nor results of title searches were furnished the surveyor. There may exist documents of record which would affect this parcel.



**Austin  
Engineering LLC**

4211 HWY 81 E, LANCASTER, WI 53813  
PHONE 608-723-6363 FAX 608-723-6702

Prepared For: **ROBERT TUBBS**

JOB NO: 08s242  
FIELDBOOK: 2207  
G:\T5NR6W\21  
H:\PLAT\T5NR6W\27\08s242-TUBBS

DRAWN BY: AJ AUSTIN  
APPROVED: LL AUSTIN  
CREW: BS-SB-BD



# PLAT OF SURVEY

## TRACT 3 DESCRIPTION:

Part of the Southwest Quarter (SW 1/4) of the Northwest Quarter (NW 1/4) of Section Twenty-seven (27), Town Five (5) North, Range Six (6) West of the 4th P.M., Bloomington Township, Grant County, Wisconsin, containing 0.26 acres, more or less, and being described as follows:

Commencing at the Northwest corner of said Section;  
thence North 89° 28' 24" East 915.25' along the North line of said Section;  
thence South 08° 50' 42" East 1738.65' to the Northeast corner of a previous survey by Larry Austin dated May 28, 2002;  
thence South 78° 27' 44" West 779.24' along the North line of said survey to a 1" iron pipe;  
thence South 78° 27' 44" West 24.65' along said North line to a No. 6 rebar marking the point of beginning;  
thence South 78° 27' 44" West 172.84' to a No. 6 rebar;  
thence South 05° 09' 12" East 68.73' to a No. 6 rebar;  
thence North 78° 33' 52" East 157.55' to a No. 6 rebar;  
thence 44.87' on the arc of a curve to the right having a radius of 146.80' and a long chord bearing North 03° 35' 52" East 44.69';  
thence North 12° 21' 12" East 27.82' to the point of beginning.  
Tract being subject to any and all easements of record and/or usage.

## INGRESS-EGRESS EASEMENT:

A Twenty-four foot (24') wide ingress-egress easement being located in the Southwest Quarter (SW 1/4) of the Northwest Quarter (NW 1/4) of Section Twenty-seven (27), Town Five (5) North, Range Six (6) West of the 4th P.M., Bloomington Township, Grant County, Wisconsin, the centerline being described as follows:

Commencing at the Northwest corner of said Section;  
thence North 89° 28' 24" East 915.25' along the North line of said Section;  
thence South 08° 50' 42" East 1738.65' to the Northeast corner of a previous survey by Larry Austin dated May 28, 2002;  
thence South 78° 27' 44" West 779.24' along the North line of said survey to a 1" iron pipe;  
thence South 78° 27' 44" West 197.49' along said North line to a No. 6 rebar;  
thence South 05° 09' 12" East 12.07' to the point of beginning;  
thence North 78° 27' 44" East 163.87';  
thence North 77° 30' 17" East 292.78';  
thence 104.01' on the arc of a curve to the right having a radius of 677.80' and a long chord bearing North 81° 54' 03" East 103.91';  
thence North 86° 17' 49" East 13.84';  
thence 149.81' on the arc of a curve to the left having a radius of 704.74' and a long chord bearing North 80° 12' 25" East 149.53';  
thence North 74° 07' 01" East 58.56';  
thence 172.88' on the arc of a curve to the right having a radius of 627.64' and a long chord bearing North 82° 00' 29" East 172.33';  
thence North 89° 53' 56" East 73.67' to a point in the centerline of County Highway "A", said point being the terminus point.

## EASEMENT NOTES:

Other documentation will need to be recorded to clarify the intent, use, maintenance, assignments or other pertinent information of this easement.

## SURVEYOR'S CERTIFICATE:

I, Larry L. Austin, Registered Wisconsin Land Surveyor, hereby certify:  
That the above descriptions were surveyed, mapped and monumented as shown on this plat by me or under my direct supervision.

That conformance with local ordinances are not guaranteed with this survey.

That this survey was prepared under the instructions of Robert Tubbs.

That to the best of my knowledge and belief, this plat is an accurate representation thereof.

That all plans that do not show a seal imprint in red ink may contain unauthorized alterations.

The certification contained on this document shall not apply to any copies.

Dated this 14th day of November, 2008.

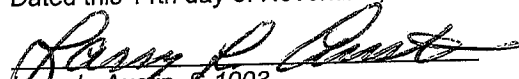
  
Larry L. Austin, S-1903

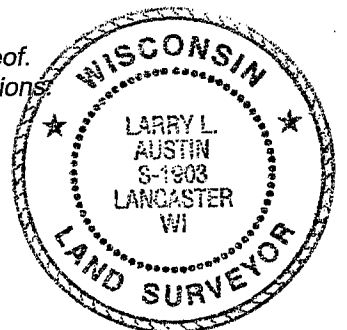

## SURVEYOR'S NOTES:

Surveyor has made no investigation for easements of record, encumbrances, restrictive covenants, ownership title evidence except as specifically shown on this plat. No distance should be assumed by scaling. No improvements have been located unless shown and noted. No representation as to ownership, use or possession should be hereon implied. Refer to abstract, title or local ordinances for any additional restriction, easements or building setback lines. No abstract, nor title commitment, nor results of title searches were furnished the surveyor. There may exist documents of record which would affect this parcel.



Austin Prepared For: **ROBERT TUBBS**  
Engineering LLC

4211 HWY 81 E, LANCASTER, WI 53813  
PHONE 608-723-6363 FAX 608-723-6702

JOB NO: 08s242  
FIELDBOOK: 2207  
G:\T5NR6W\21  
H:\PLAT\T5NR6W\27\08s242-TUBBS

DRAWN BY: AJ AUSTIN  
APPROVED: LL AUSTIN  
CREW: SA-BH-BD

SHEET 2 OF 2