

MAP OF EASEMENTS

ALL PLANS THAT DO NOT SHOW A SEAL IMPRINT IN RED INK MAY CONTAIN UNAUTHORIZED ALTERATIONS. THE CERTIFICATION CONTAINED ON THIS DOCUMENT SHALL NOT APPLY TO ANY COPIES. DATED: JULY 31, 2008.

Rory Austin



PREVIOUS SURVEY
BY DAVID DAVIS
DATED 4-14-1981

TRACT 1
[1022-413]

WESTERLY RIGHT OF WAY
HIGHWAY #61 & #35

HIGHWAY #61 & #35
TRAVELED ROADWAY OF SOUTHBOUND LANE

C1
L=34.73'
R=1859.86'
C LEN=34.73'
BRG=S 26°49'50" E

EASE.#1
N 77°26'21" E
N 85°03'00" W
68.00'
N 87°36'21" W
N 89°19'12" W
57.60' (57.69')
EASE.#2
S 66°44'06" E
93.69'
N 77°26'21" E
50.00'

C2
L=21.78'
R=1859.86'
C LEN=21.78'
BRG=N 25°57'37" W

C3
L=782.08'
R=1859.86'
C LEN=776.33'
BRG=S 13°34'42" E

EAST 1/4 CORNER
SECTION 14, T4N R3W

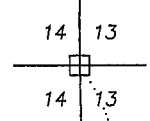

2655.46'

1069.74'

N 01°06'40" W



SOUTHEAST CORNER
SECTION 14, T4N R3W



LEGEND

- ⊞ Bernsten A-1 monument found
- ⊗ Alumimum Cap in manhole found
- △ 1" diameter iron pipe found
- No. 6 rebar found
- No monument set
- () Recorded as
- [-] Property described in Volume and Page, Grant County Registry
- *- Approximate fence

The East line of the SE 1/4 of Section 14 is assumed to bear S 01°06'40" E.

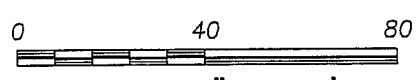

SCALE 1" = 40'

R.O.W. ESTABLISHED FROM R/W
PROJECT NO. 1650-01-21.

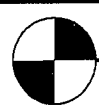

Austin
Engineering LLC

Prepared For: LARRY VESPERMAN

4211 HWY 81 E, LANCASTER, WI 53813
PHONE 608-723-6363 FAX 608-723-6702

JOB NO: 08s119
FIELDBOOK: 2701
G:\T4NR2W\T4NR2W
H:\PLAT\T4NR3W\14\08s119-VESPERMAN

DRAWN BY: AJ AUSTIN
APPROVED: LL AUSTIN
CREW: BS-SA-BD

SHEET 1 OF 2

MAP OF EASEMENTS

EASEMENT #1 DESCRIPTION: (E & V PROPERTIES TO PETERSON)

Located in the Southeast Quarter (SE 1/4) of the Southeast Quarter (SE 1/4) of Section Fourteen (14), Town Four (4) North, Range Three (3) West of the 4th P.M., South Lancaster Township, Grant County, Wisconsin, said easement being described as follows:

Commencing at the Southeast corner of said Section Fourteen (14);
thence North 01° 06' 40" West 1069.74' along the East line of said Section;
thence South 88° 53' 20" West 228.31' to a 1" iron pipe located on the Westerly right of way of Highway #61 & #35, said pipe marking the point of beginning;
thence North 89° 19' 12" West 57.60' along the South line of Tract 1 of that property described in Volume 1022, page 413 recorded as Document No. 667129, Grant County Registry;
thence North 85° 03' 00" West 68.00' along a line of said Tract 1;
thence North 77° 26' 21" East 112.36' to the Westerly right of way of said highway;
thence 34.73' on the arc of a curve to the right having a radius of 1859.86' and a long chord bearing South 26° 49' 50" East 34.73' along said right of way to the point of beginning.

EASEMENT #2 DESCRIPTION: (PETERSON TO E & V PROPERTIES)

Located in the Southeast Quarter (SE 1/4) of the Southeast Quarter (SE 1/4) of Section Fourteen (14), Town Four (4) North, Range Three (3) West of the 4th P.M., South Lancaster Township, Grant County, Wisconsin, said easement being described as follows:

Commencing at the Southeast corner of said Section Fourteen (14);
thence North 01° 06' 40" West 1069.74' along the East line of said Section;
thence South 88° 53' 20" West 228.31' to a 1" iron pipe located on the Westerly right of way of Highway #61 & #35, said pipe marking the point of beginning;
thence North 89° 19' 12" West 57.60' along the South line of Tract 1 of that property described in Volume 1022, page 413 recorded as Document No. 667129, Grant County Registry;
thence North 85° 03' 00" West 68.00' along a line of said Tract 1;
thence South 66° 44' 06" East 93.69';
thence North 77° 26' 21" East 50.00' to the Westerly right of way of said highway;
thence 21.78' on the arc of a curve to the left having a radius of 1859.86' and a long chord bearing North 25° 57' 37" West 21.78' along said right of way to the point of beginning.

SURVEYOR'S CERTIFICATE:

I, Larry L. Austin, Registered Wisconsin Land Surveyor, hereby certify:

That the above descriptions were surveyed and mapped as shown on this map by me or under my direct supervision.

That this survey was prepared under the instructions of Larry Vesperman.

That to the best of my knowledge and belief, this plat is an accurate representation thereof.

That all plans that do not show a seal imprint in red ink may contain unauthorized alterations.

The certification contained on this document shall not apply to any copies.

Dated this 31st day of July, 2008.

Larry L. Austin, S-1903

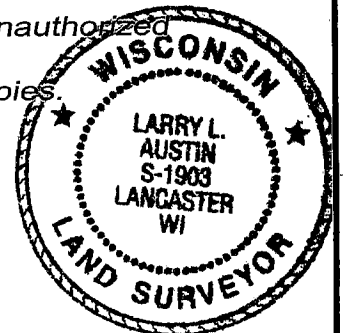

SURVEYOR'S NOTES:

Surveyor has made no investigation for easements of record, encumbrances, restrictive covenants, ownership title evidence except as specifically shown on this plat. No distance should be assumed by scaling. No improvements have been located unless shown and noted. No representation as to ownership, use or possession should be hereon implied. Refer to abstract, title or local ordinances for any additional restriction, easements or building setback lines. No abstract, nor title commitment, nor results of title searches were furnished the surveyor.



Austin

Engineering LLC

Prepared For: LARRY VESPERMAN

4211 HWY 81 E, LANCASTER, WI 53813
PHONE 608-723-6363 FAX 608-723-6702

JOB NO: 08s119
FIELDBOOK: 2701
G:\T4NR2W\T4NR2W
H:\PLAT\T4NR3W\14\08s119-VESPERMAN

DRAWN BY: AJ AUSTIN
APPROVED: LL AUSTIN
CREW: BS-SA-BD

SHEET 2 OF 2