

PLAT OF SURVEY

TRACT 1 DESCRIPTION:

Located in the Southwest Quarter (SW 1/4) of the Southeast Quarter (SE 1/4) of Section Twenty (20), Town Three (3) North, Range One (1) West of the 4th P.M., Platteville Township, Grant County, Wisconsin, containing 7.03 acres, more or less, and being described as follows:

Commencing at the South Quarter (S 1/4) corner of said Section;
thence North 01° 00' 05" West 41.01' along the North-South Quarter (N-S 1/4) line of said Section to the point of beginning;
thence North 01° 00' 05" West 583.53' along said North-South Quarter (N-S 1/4) line;
thence South 84° 18' 25" East 582.74';
thence South 00° 34' 19" East 403.16';
thence South 34° 01' 53" West 104.79' to the Northerly right of way of Short Lane;
thence North 53° 41' 29" West 72.16' along said right of way;
thence South 49° 19' 52" West 101.40' along said right of way;
thence South 88° 08' 44" West 380.19' along said right of way to the point of beginning. Tract being subject to any and all easements of record and/or usage.

TRACT 2 DESCRIPTION:

Located in the Southwest Quarter (SW 1/4) of the Southeast Quarter (SE 1/4) of Section Twenty (20), Town Three (3) North, Range One (1) West of the 4th P.M., Platteville Township, Grant County, Wisconsin, containing 4.15 acres, more or less, and being described as follows:

Commencing at the South Quarter (S 1/4) corner of said Section;
thence North 01° 00' 05" West 41.01' along the North-South Quarter (N-S 1/4) line of said Section;
thence North 01° 00' 05" West 583.53' along said North-South Quarter (N-S 1/4) line;
thence South 84° 18' 25" East 582.74' to the point of beginning;
thence South 00° 34' 19" East 403.16';
thence South 34° 01' 53" West 104.79' to the Northerly right of way of Short Lane;
thence South 53° 41' 29" East 33.03' along said right of way;
thence North 89° 23' 01" East 194.68' along the Northerly right of way of Highway #151;
thence North 76° 11' 13" East 277.44' along said right of way;
thence North 84° 21' 48" East 273.22' along said right of way;
thence North 05° 38' 12" West 83.57';
thence South 88° 33' 51" West 382.01';
thence North 16° 01' 33" West 333.04';
thence North 84° 46' 17" West 226.88' to the point of beginning. Tract being subject to any and all easements of record and/or usage.

TRACT 3 DESCRIPTION:

Located in the Southwest Quarter (SW 1/4) of the Southeast Quarter (SE 1/4) and the Southeast Quarter (SE 1/4) of the Southeast Quarter (SE 1/4) of Section Twenty (20), Town Three (3) North, Range One (1) West of the 4th P.M., Platteville Township, Grant County, Wisconsin, containing 46.00 acres, more or less, and being described as follows:

Commencing at the South Quarter (S 1/4) corner of said Section;
thence North 01° 00' 05" West 41.01' along the North-South Quarter (N-S 1/4) line of said Section;
thence North 01° 00' 05" West 583.53' along said North-South Quarter (N-S 1/4) line to the point of beginning;
thence South 84° 18' 25" East 582.74';
thence South 84° 46' 17" East 226.88';
thence South 16° 01' 33" East 333.04';
thence North 88° 33' 51" East 382.01';
thence South 05° 38' 12" East 83.57' to the Northerly right of way of Highway #151;
thence North 84° 21' 48" East 249.43' along said right of way;
thence South 85° 14' 59" East 469.02' along said right of way to the East line of the West Half (W 1/2) of the Southeast Quarter (SE 1/4) of said Southeast Quarter (SE 1/4);
thence North 00° 57' 21" West 1243.37' along said East line to the Northeast corner thereof;
thence South 88° 42' 17" West 1995.69' along the North line of the South Half (S 1/2) of the Southeast Quarter (SE 1/4) of said Section;
thence South 01° 00' 05" East 711.68' along the West line of said Section to the point of beginning. Tract being subject to any and all easements of record and/or usage, including, but not limited to a Sixty-six foot (66') wide ingress-egress easement being described as follows:

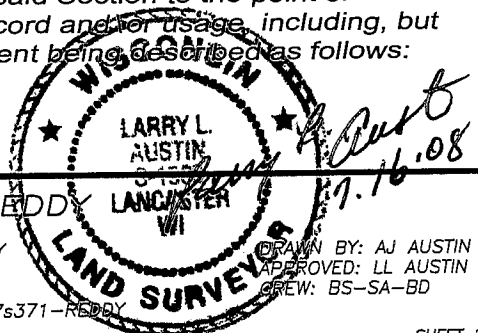

Austin Engineering LLC

Prepared For: PARAS REDDY

4211 HWY 81 E, LANCASTER, WI 53813
PHONE 608-723-6363 FAX 608-723-6702

JOB NO: 07s371-REDDY
FIELDBOOK: TDSR
G:\T3NR1W\29DOT
H:\PLAT\T3NR1W\20\07s371-REDDY

DRAWN BY: AJ AUSTIN
APPROVED: LL AUSTIN
CREW: BS-SA-BD

PLAT OF SURVEY

INGRESS-EGRESS EASEMENT DESCRIPTION:

A Sixty-six foot (66') wide ingress-egress easement being located in the Southwest Quarter (SW 1/4) of the Southeast Quarter (SE 1/4) of Section Twenty (20), Town Three (3) North, Range One (1) West of the 4th P.M., Platteville Township, Grant County, Wisconsin, and being described as follows:

Commencing at the South Quarter (S 1/4) corner of said Section;
thence North 01° 00' 05" West 41.01' along the North-South Quarter (N-S 1/4) line of said Section to the Northerly right of way of Short Lane;
thence North 88° 08' 44" East 380.19' along said Northerly right of way;
thence North 49° 19' 52" East 101.40' along said Northerly right of way;
thence South 53° 41' 29" East 39.14' along said Northerly right of way to the point of beginning;
thence South 53° 41' 29" East 66.05' along said Northerly right of way;
thence North 34° 01' 53" East 138.46';
thence 32.36' on the arc of a curve to the right having a radius of 34.00' and a long chord bearing North 61° 17' 52" East 31.15';
thence North 88° 33' 51" East 308.00';
thence North 01° 26' 09" West 66.00';
thence South 88° 33' 51" West 308.00';
thence 95.18' on the arc of a curve to the left having a radius of 100.00' and a long chord bearing South 61° 17' 52" West 91.63';
thence South 34° 01' 53" West 135.84' to the point of beginning.

EASEMENT NOTES:

Other documentation will need to be recorded to clarify the intent, use, maintenance, assignments or other pertinent information of the easement.

SURVEYOR'S CERTIFICATE:

I, Larry L. Austin, Registered Wisconsin Land Surveyor, hereby certify:

That the above descriptions were surveyed, mapped and monumented as shown on this plat by me or under my direct supervision.

That conformance with local ordinances are not guaranteed with this survey.

That this survey was prepared under the instructions of Paras Reddy.

That to the best of my knowledge and belief, this plat is an accurate representation thereof.

That all plans that do not show a seal imprint in red ink may contain unauthorized alterations.

The certification contained on this document shall not apply to any copies.

Dated this 16th day of July, 2008.

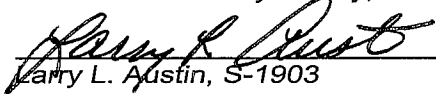
Larry L. Austin, S-1903

SURVEYOR'S NOTES:

Surveyor has made no investigation for easements of record, encumbrances, restrictive covenants, ownership title evidence except as specifically shown on this plat. No distance should be assumed by scaling. No improvements have been located unless shown and noted. No representation as to ownership, use or possession should be hereon implied. Refer to abstract, title or local ordinances for any additional restriction, easements or building setback lines. No abstract, nor title commitment, nor results of title searches were furnished the surveyor.

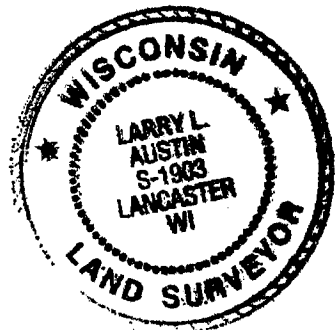

Austin Engineering LLC

Prepared For: **PARAS REDDY**

4211 HWY 81 E, LANCASTER, WI 53813
PHONE 608-723-6363 FAX 608-723-6702

JOB NO: 07s371-REDDY
FIELDBOOK: TDSR
G:\T3NR1W\29DOT
H:\PLAT\T3NR1W\20\07s371-REDDY

DRAWN BY: AJ AUSTIN
APPROVED: LL AUSTIN
CREW: BS-SA-BD