



# PLAT OF SURVEY

## DESCRIPTION:

Located in the Northwest Quarter (NW 1/4) of the Northwest Quarter (NW 1/4) of Section Five (5), Township Three (3) North, Range Four (4) West, Waterloo Township and the Southwest Quarter (SW 1/4) of the Southwest Quarter (SW 1/4) of Section Thirty-two (32), Township Four (4) North, Range Four (4) West, Beetown Township, of the 4th P.M., Grant County, Wisconsin, containing 14.79 acres, more or less, and being described as follows:

Commencing at the Southwest corner of said Section Thirty-two (32), said corner being the point of beginning;  
thence South 89° 21' 42" East 33.00' to the Northwest corner of said Section Five (5);  
thence South 00° 12' 20" West 1167.71' along the West line of said Section Five (5) to a point in the centerline of a township road known as Rattle Snake Road;  
thence 44.99' on the arc of a curve to the left having a radius of 1196.50' and a long chord bearing North 33° 55' 16" East 44.99' along said centerline;  
thence North 32° 50' 38" East 296.28' along said centerline;  
thence 253.09' on the arc of a curve to the left having a radius of 1760.00' and a long chord bearing North 28° 43' 27" East 252.88' along said centerline;  
thence North 24° 36' 16" East 147.72' along said centerline;  
thence 238.73' on the arc of a curve to the right having a radius of 695.00' and a long chord bearing North 34° 26' 41" East 237.56' along said centerline;  
thence North 44° 17' 07" East 99.27' along said centerline;  
thence 320.39' on the arc of a curve to the left having a radius of 5290.00' and a long chord bearing North 42° 33' 00" East 320.34' along said centerline;  
thence North 40° 48' 54" East 189.18' along said centerline;  
thence 74.18' on the arc of a curve to the right having a radius of 10450.00' and a long chord bearing North 41° 01' 06" East 74.18' along said centerline;  
thence North 45° 38' 27" West 75.89';  
thence North 89° 21' 42" West 941.49' to the West line of said Section Thirty-two (32);  
thence South 01° 17' 24" East 239.97' along the West line of said Section Thirty-two (32) to the point of beginning. Tract being subject to any and all easements of record and/or usage, including, but not limited to the following described ingress-egress easement:

A Thirty foot (30') wide ingress-egress easement being located in the Northwest Quarter (NW 1/4) of the Northwest Quarter (NW 1/4) of Section Five (5), Township Three (3) North, Range Four (4) West, Waterloo Township and the Southwest Quarter (SW 1/4) of the Southwest Quarter (SW 1/4) of Section Thirty-two (32), Township Four (4) North, Range Four (4) West, Beetown Township, of the 4th P.M., Grant County, Wisconsin, said easement being located Northerly and Easterly of the following described reference line:

Commencing at the Southwest corner of said Section Thirty-two (32), said corner being the point of beginning;  
thence South 89° 21' 42" East 33.00' to the Northwest corner of said Section Five (5);  
thence South 00° 12' 20" West 85.50' along the West line of said Section Five (5);  
thence South 83° 23' 16" East 142.11';  
thence South 76° 57' 24" East 72.87';  
thence South 70° 44' 18" East 136.69';  
thence South 48° 54' 53" East 97.86';  
thence South 32° 44' 57" East 135.08' to a point in the centerline of Rattle Snake Road, said point being the terminus point. The intent of the above described easement is to provide a thirty foot (30') wide access from the centerline of Rattle Snake Road to the lands adjoining the west side of the above described tract.

## EASEMENT NOTES:

Other documentation will need to be recorded to clarify the intent, use, maintenance, assignments or other pertinent information of the easement.

## SURVEYOR'S CERTIFICATE:

I, Larry L. Austin, Registered Wisconsin Land Surveyor, hereby certify:

That the above descriptions were surveyed, mapped and monumented as shown on this plat by me or under my direct supervision.

That conformance with local ordinances are not guaranteed with this survey.

That this survey was prepared under the instructions of Kathy Ragatz.

That to the best of my knowledge and belief, this plat is an accurate representation thereof.

That all plans that do not show a seal imprint in red ink may contain unauthorized alterations.

The certification contained on this document shall not apply to any copies.

Dated this 28th day of February, 2008.

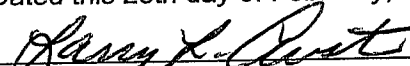
  
Larry L. Austin, S-1903

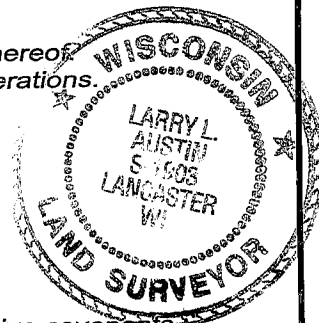

## SURVEYOR'S NOTES:

Surveyor has made no investigation for easements of record, encumbrances, restrictive covenants, ownership title evidence except as specifically shown on this plat. No distance should be assumed by scaling. No improvements have been located unless shown and noted. No representation as to ownership, use or possession should be hereon implied. Refer to abstract, title or local ordinances for any additional restriction, easements or building setback lines. No abstract, nor title commitment, nor results of title searches were furnished the surveyor.



Austin  
Engineering LLC

4211 HWY 81 E, LANCASTER, WI 53813  
PHONE 608-723-6363 FAX 608-723-6702

Prepared For: KATHY RAGATZ

JOB NO: 06s317  
FIELDBOOK: TDS RANGER  
G:\T4NR4W\33  
H:\PLAT\T4NR4W\32\06s317-RAGATZ

DRAWN BY: AJ AUSTIN  
APPROVED: LL AUSTIN  
CREW: BS-SA-BD

SHEET 2 OF 2