

PLAT OF SURVEY

TRACT 1 DESCRIPTION:

Part of the Southwest Quarter (SW 1/4) of the Northeast Quarter (NE 1/4) of Section Nineteen (19), Town Three (3) North, Range One (1) West of the 4th P.M., Platteville Township, Grant County, Wisconsin, containing 5.68 acres, more or less, and being described as follows:

Commencing at the North Quarter (N 1/4) corner of said Section;
 thence South 00° 59' 27" East 2627.94' along the West line of the Northeast Quarter (NE 1/4) to the center of said Section and the point of beginning;
 thence North 89° 52' 16" East 844.83' along the South line of the Northeast Quarter (NE 1/4) of said Section;
 thence North 00° 59' 27" West 273.25' to the South line of platted Maple Glen Lane;
 thence North 86° 38' 44" West 314.59' along said South line;
 thence 176.48' on the arc of a curve to the right having a radius of 60.00' and a long chord bearing North 86° 38' 44" West 119.40' along said South line;
 thence North 86° 38' 44" West 413.19' along the South line of Outlot 1 of the plat of Eagle Heights, according to the recorded map or plat thereof to the West line of the Northeast Quarter (NE 1/4) of said Section;
 thence South 00° 59' 27" East 324.72' along the West line of said Northeast Quarter (NE 1/4) to the point of beginning. Tract being subject to any and all easements of record and \or usage.

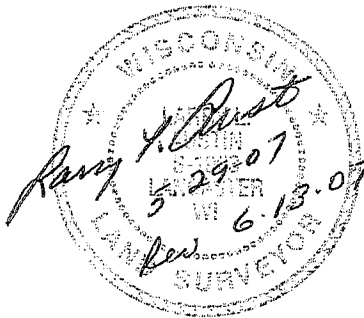

**Austin
Engineering LLC**

Prepared For: JACK KEY

4211 HWY 81 E, LANCASTER, WI 53813
 PHONE 608-723-6363 FAX 608-723-6702

JOB NO: 07s120
 FIELDBOOK: TDS RANGER
 G:\T3NR1W\19
 H:\PLAT\T3NR1W\19\07s120-KEY

DRAWN BY: AJ AUSTIN
 APPROVED: LL AUSTIN
 CREW: BS-SB-BD

SHEET 2 OF 5

JUN 21 2007

PLAT OF SURVEY

TRACT 2 DESCRIPTION:

Part of the Northwest Quarter (NW 1/4) of the Southwest Quarter (SW 1/4), the Northeast Quarter (NE 1/4) of the Southwest Quarter (SW 1/4), the Northwest Quarter (NW 1/4) of the Southeast Quarter (SE 1/4), and the Northeast Quarter (NE 1/4) of the Southeast Quarter (SE 1/4) of Section Nineteen (19), Town Three (3) North, Range One (1) West of the 4th P.M., Platteville Township, Grant County, Wisconsin, containing 34.41 acres, more or less, and being described as follows:

Commencing at the North Quarter (N 1/4) corner of said Section;
 thence South $00^{\circ} 59' 27''$ East 2627.94' along the West line of the Northeast Quarter (NE 1/4) to the center of said Section and the point of beginning;
 thence North $89^{\circ} 52' 16''$ East 1308.99' along the North line of the Southeast Quarter (SE 1/4) of said Section;
 thence South $03^{\circ} 16' 47''$ West 37.44';
 thence South $84^{\circ} 05' 40''$ East 990.97' to the West line of platted Maple Glen Lane;
 thence South $37^{\circ} 59' 34''$ East 58.88' along said West line;
 thence 168.36' on the arc of a curve to the right having a radius of 842.00' and a long chord bearing South $32^{\circ} 15' 52''$ East 168.08' along said West line;
 thence South $26^{\circ} 32' 10''$ East 171.20' along said West line;
 thence 12.44' on the arc of a curve to the left having a radius of 178.55' and a long chord bearing South $28^{\circ} 31' 55''$ East 12.44' along said West line;
 thence North $65^{\circ} 55' 22''$ West 180.69' along a line of a previous survey by Larry Austin with a dated of 6-3-1999 and a revised date of 6-7-1999;
 thence North $23^{\circ} 19' 05''$ East 106.09' along a line of said survey;
 thence North $88^{\circ} 43' 04''$ West 688.01' along a line of said survey;
 thence North $00^{\circ} 51' 25''$ East 70.20' along a line of said survey;
 thence North $83^{\circ} 27' 37''$ West 143.22' along a line of said survey;
 thence North $78^{\circ} 37' 22''$ West 255.16' along a line of said survey;
 thence North $78^{\circ} 37' 22''$ West 242.81' along a line of said survey;
 thence South $00^{\circ} 35' 10''$ East 621.09' along a line of said survey;
 thence North $69^{\circ} 48' 49''$ West 1089.08';
 thence North $72^{\circ} 21' 11''$ West 429.45';
 thence South $32^{\circ} 30' 33''$ West 1316.38' to the South line of the North Half (N 1/2) of said Southwest Quarter (SW 1/4);
 thence North $89^{\circ} 59' 17''$ West 295.45' along said South line;
 thence North $14^{\circ} 56' 40''$ East 517.59';
 thence North $39^{\circ} 04' 21''$ East 586.34';
 thence North $04^{\circ} 02' 47''$ East 386.64' to the North line of the Southwest Quarter (SW 1/4);
 thence North $89^{\circ} 52' 16''$ East 836.94' along the North line of said Southwest Quarter (SW 1/4) to the point of beginning. Tract being subject to any and all easements of record and/or usage.

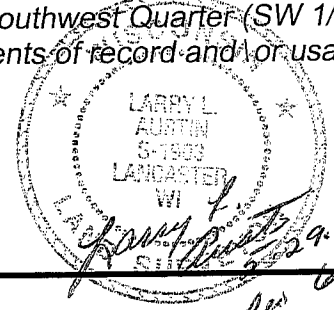

Austin
Engineering LLC

4211 HWY 81 E, LANCASTER, WI 53813
 PHONE 608-723-6363 FAX 608-723-6702

Prepared For: JACK KEY

JOB NO: 07s120
 FIELDBOOK: TDS RANGER
 G:\T3NR1W\19
 H:\PLAT\T3NR1W\19\07s120-KEY

DRAWN BY: AJ AUSTIN
 APPROVED: LL AUSTIN
 CREW: BS-SB-BD

SHEET 3 OF 5

PLAT OF SURVEY

EASEMENT NO. 2 DESCRIPTION:

A Sixty-six foot (66') wide ingress-egress easement being located in the Northeast Quarter (NE 1/4) of the Southwest Quarter (SE 1/4) of Section Nineteen (19), Town Three (3) North, Range One (1) West of the 4th P.M., Platteville Township, Grant County, Wisconsin, said easement being located Thirty-three feet (33') on each side of the following described centerline:

Commencing at the North Quarter (N 1/4) corner of said Section;
thence South 00° 59' 27" East 2627.94' to the center of said Section;
thence South 89° 52' 16" West 836.94' along the North line of the Southwest Quarter (SW 1/4) of said Section;
thence South 04° 02' 47" West 386.64';
thence South 39° 04' 21" West 586.34';
thence South 14° 56' 40" West 34.62' to the point of beginning;
thence South 57° 22' 30" East 128.90';
thence North 73° 27' 52" East 156.36';
thence North 55° 54' 35" East 202.62';
thence North 39° 15' 23" East 35.27';
thence 37.79' on the arc of a curve to the right having a radius of 20.00' and a long chord bearing South 86° 36' 45" East 32.41';
thence South 32° 28' 52" East 55.86' to the terminus point.

It is intended that this easement provide Sixty-six foot (66') wide ingress-egress access from the above described Tract 3 across the above described Tract 2 to the adjoining lands being located West of Tract 2.

EASEMENT NOTES:

Other documentation will need to be recorded to clarify the use, maintenance, assignments or other pertinent information of the easement.

SURVEYOR'S CERTIFICATE:

I, Larry L. Austin, Registered Wisconsin Land Surveyor, hereby certify:

That the descriptions hereon were surveyed, mapped and monumented as shown on this plat by me or under my direct supervision.

That conformance with local ordinances are not guaranteed with this survey.

That this survey was prepared under the instructions of Jack Key.

That to the best of my knowledge and belief, this plat is an accurate representation thereof.

That all plans that do not show a seal imprint in red ink may contain unauthorized alterations.

The certification contained on this document shall not apply to any copies.

Dated this 29th day of May, 2007.

Revised this 13th day of June, 2007. (TRACT 3 DESCRIPTION AND MAP)

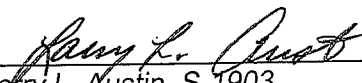
Larry L. Austin, S-1903

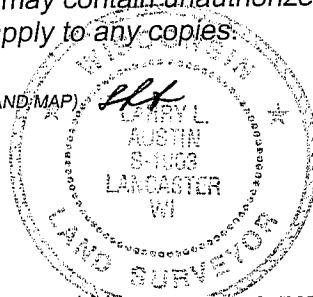

SURVEYOR'S NOTES:

Surveyor has made no investigation for easements of record, encumbrances, restrictive covenants, ownership title evidence except as specifically shown on this plat. No distance should be assumed by scaling. No improvements have been located unless shown and noted. No representation as to ownership, use or possession should be hereon implied. Refer to abstract, title or local ordinances for any additional restriction, easements or building setback lines. No abstract, nor title commitment, nor results of title searches were furnished the surveyor. There may exist documents of record which would affect this parcel.



**Austin
Engineering LLC**

4211 HWY 81 E, LANCASTER, WI 53813
PHONE 608-723-6363 FAX 608-723-6702

Prepared For: JACK KEY

JOB NO: 07s120
FIELD BOOK: TDS RANGER
G:\T3NR1W\19
H:\PLAT\T3NR1W\19\07s120-KEY

DRAWN BY: AJ AUSTIN
APPROVED: LL AUSTIN
CREW: BS-SB-BD