

# PLAT OF SURVEY

THE PURPOSE OF THIS SURVEY IS FOR THE EXCHANGE LAND BETWEEN ADJOINERS

**PROJECT LOCATION**  
NE 1/4, NE 1/4, SECTION 36, T2N R1W  
PART OF LOT 4, KING'S SUNSET  
ADDITION TO CUBA CITY

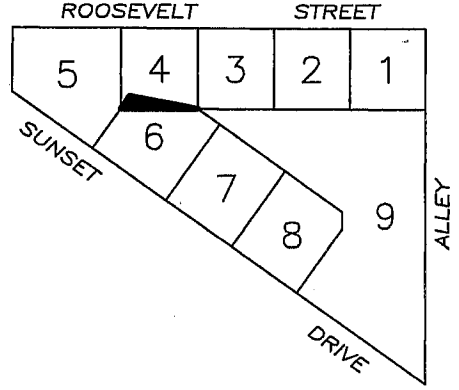

## LEGEND

- No. 6 x 24" rebar set with cap - wt=1.50 #/l.f.
- △ 1" diameter iron pipe found

ROOSEVELT

STREET

KING'S SUNSET

5

4

3

6

9

7

ADDITION

SW COR LOT 4  
POINT OF BEGINNING

SE COR LOT 4

S 35°31'00" W 19.00'  
N 79°08'41" W 85.49'  
**0.02 ACRES±**  
**738 S.F.±**  
S 89°37'00" E 95.00'  
SOUTH LINE LOT 4

S 54°29'00" E  
33.54'

115.57'

N 35°31'00" E

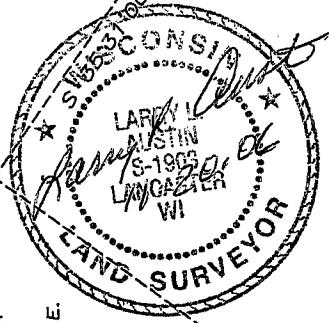

Bearings referenced to the South line of Lot 4, King's Sunset Addition to Cuba City, which is assumed to bear S 89° 37' 00" E.

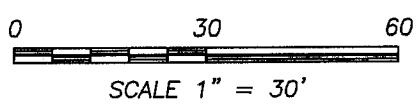

ALL PLANS THAT DO NOT SHOW A SEAL IMPRINT IN RED INK MAY CONTAIN UNAUTHORIZED ALTERATIONS. THE CERTIFICATION CONTAINED ON THIS DOCUMENT SHALL NOT APPLY TO ANY COPIES. DATED: 11-20-06

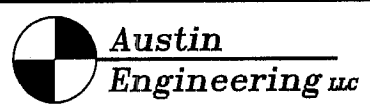

4211 HWY 81 E, LANCASTER, WI 53813  
PHONE 608-723-6363 FAX 608-723-6702

Prepared For: FRANK & JOAN LEE

JOB NO: 06S233  
FIELDBOOK: TDSR  
G:\CUBACITY\SUNSET  
H:\PLAT\CUBACITY\KINGS SUNSET\06S233-LEE

DRAWN BY: SW AUSTIN  
APPROVED: LL AUSTIN  
CREW: BS-SA-BD-SB

SHEET 1 OF 2

# PLAT OF SURVEY

## DESCRIPTION

Being located in Lot Four (4), King's Sunset Addition to Cuba City, City of Cuba City, Grant County, Wisconsin, containing 0.02 acres, more or less, and being described as follows:

Commencing at the Southwest corner of Lot Four (4) of said King's Sunset Addition, said corner being the Point of Beginning;  
thence South 89° 37' 00" East 95.00' along the South line of said Lot Four (4) to the Southeast Corner thereof; thence North 79° 08' 41" West 85.49';  
thence South 35° 31' 00" West 19.00' to the point of beginning, being subject to any and all easements of record and/or usage.

## SURVEYOR'S CERTIFICATE:

I, Larry L. Austin, Registered Wisconsin Land Surveyor, hereby certify:  
That the above description was surveyed, mapped and monumented as shown on this plat by me or under my direct supervision.  
That conformance with local ordinances are not guaranteed with this survey.  
That this survey was prepared under the instructions of .  
That to the best of my knowledge and belief, this plat is an accurate representation thereof.  
That all plans that do not show a seal imprint in red ink may contain unauthorized alterations.  
The certification contained on this document shall not apply to any copies.

Dated this 20th day of November, 2006.

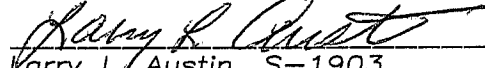
  
Larry L. Austin, S-1903

## SURVEYOR'S NOTES:

Surveyor has made no investigation for easements of record, encumbrances, restrictive covenants, ownership title evidence except as specifically shown on this plat. No distance should be assumed by scaling. No improvements have been located unless shown and noted. No representation as to ownership, use or possession should be hereon implied. Refer to abstract, title or local ordinances for any additional restriction, easements or building setback lines. No abstract, nor title commitment, nor results of title searches were furnished the surveyor. There may exist documents of record which would affect this parcel.



**Austin  
Engineering LLC**

4211 HWY 81 E, LANCASTER, WI 53813  
PHONE 608-723-6363 FAX 608-723-6702

Prepared For: **FRANK & JOAN LEE**

JOB NO: 06S233  
FIELDBOOK: TDSR  
G:\CUBACITY\SUNSET  
H:\PLAT\CUBACITY\KINGS SUNSET\06S233-LEE

DRAWN BY: SW AUSTIN  
APPROVED: LL AUSTIN  
CREW: BS-SA-BD-SB

SHEET 2 OF 2