

# PLAT OF SURVEY

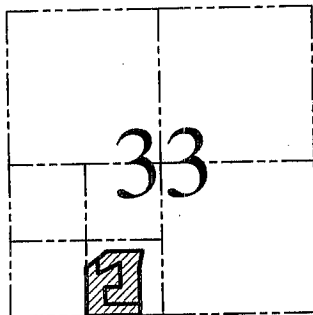
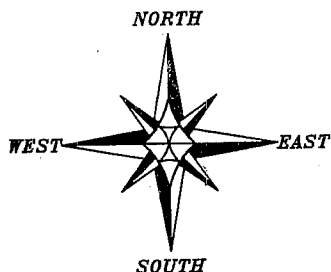

## LEGEND

- ⊕ No. 8 rebar found with Grant County Aluminum Cap
- ⊙ No. 6 rebar found
- No. 6 x 24" rebar set with cap - wt=1.50 #/l.f.
- ⊠ Aluminum Monument found with Grant County Aluminum Cap
- + No monument set
- ⊙ Existing utility pole
- x— Approximate location of fence
- E— Existing overhead utilities

Bearings referenced to the South line of the SW 1/4 of Section 33, which is assumed to bear South 89° 46' 07" East.

## LINE TABLE

LINE	BEARING	DISTANCE
L1	N 58°15'06" E	149.98'
L2	N 43°48'46" E	53.88'

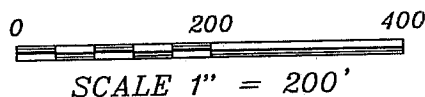

C1  
L=108.81'  
R=1153.77'  
C LEN=108.77'  
BRG=S 55°33'00" W

C2  
L=181.94'  
R=1153.77'  
C LEN=181.76'  
BRG=N 48°19'50" E

C3  
L=87.15'  
R=1186.77'  
C LEN=87.13'  
BRG=S 56°08'52" W

C4  
L=211.92'  
R=1186.77'  
C LEN=211.64'  
BRG=S 48°55'42" W

1.02 ACRE± SURVEY BY LARRY AUSTIN DATED 5-1-02

LOT 1, CSM #727, PAGE 17, DOC 625064

**TRACT 2**  
11.39 ACRES±  
496,148 S.F.±  
(11.21 AC± EXCL ROW)

**TRACT 3**  
11.57 ACRES±  
503,989 S.F.±  
(11.39 AC± EXCL ROW)

EXISTING 66' WIDE PUBLIC ROADWAY EASEMENT  
40.00 ACRE± SURVEY BY LARRY AUSTIN DATED 5-13-02

S 00°02'39" E 864.42'

N 00°09'16" W 300.00'

N 00°09'16" W 428.62'

S 00°09'16" E 657.82'

S 11°14'32" W 280.71'

N 89°46'07" W 600.00'

S 89°46'07" E 923.10'

POB TRACT 3

2646.22'

SOUTHWEST CORNER SECTION 33, T5N R2W

ALL PLANS THAT DO NOT SHOW A SEAL IMPRINT IN RED INK MAY CONTAIN UNAUTHORIZED ALTERATIONS. THE CERTIFICATION CONTAINED ON THIS DOCUMENT SHALL NOT APPLY TO ANY COPIES. DATED: 4-26-06

SOUTH 1/4 CORNER SECTION 33, T5N R2W

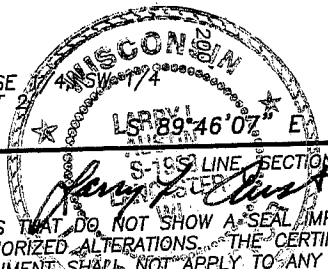

**Austin Engineering LLC**

4211 HWY 81 E, LANCASTER, WI 53813  
PHONE 608-723-6363 FAX 608-723-6702

Prepared For: **STEVE LENZ**

JOB NO: 06S066  
FIELDBOOK: TDS RANGER  
G:\T5NR2W\32  
H:\PLAT\T5NR2W\33\06S066-LENZ

DRAWN BY: SW AUSTIN  
APPROVED: LL AUSTIN  
CREW: BS - SA - BD

SHEET 1 OF 2

# PLAT OF SURVEY

## TRACT 2 DESCRIPTION:

Part of the Southeast Quarter (SE 1/4) of the Southwest Quarter (SW 1/4) of Section Thirty-three (33), Town Five (5) North, Range Two (2) West of the 4th p.m., Liberty Township, Grant County, Wisconsin, containing 11.39 acres, more or less and being described as follows:  
Commencing at the Southwest corner of said Section Thirty-three (33), thence South 89° 46' 07" East 1323.11' along the South line of said Section to the Southwest corner of the Southeast Quarter (SE 1/4) of the Southwest Quarter (SW 1/4) of said Section Thirty-three (33) being the point of beginning; thence South 89° 46' 07" East 923.10' along the South line of said Section Thirty-three (33); thence North 00° 09' 16" West 200.00'; thence North 89° 46' 07" West 600.00'; thence North 00° 09' 16" West 300.00'; thence South 89° 46' 07" East 261.79'; thence North 00° 09' 16" West 428.62'; thence South 64° 34' 00" West 424.05'; thence North 00° 02' 39" West 250.00' to a point in the centerline of a township road known as Coon Hollow Road; thence 108.81' on the arc of a curve to the right having a radius of 1153.77' and a long chord bearing South 55° 33' 00" West 108.77' along said centerline; thence South 58° 15' 06" West 129.60' along said centerline to a point on the West line of the Southeast Quarter (SE 1/4) of the Southwest Quarter (SW 1/4) of said Section Thirty-three (33); thence South 00° 02' 39" East 864.42' along said West line to the point of beginning, being subject to any and all easements of record and/or usage.

## TRACT 3 DESCRIPTION:

Part of the Southeast Quarter (SE 1/4) of the Southwest Quarter (SW 1/4) of Section Thirty-three (33), Town Five (5) North, Range Two (2) West of the 4th p.m., Liberty Township, Grant County, Wisconsin, containing 11.57 acres, more or less and being described as follows:  
Commencing at the Southwest corner of said Section Thirty-three (33), thence South 89° 46' 07" East 1323.11' along the South line of said Section to the Southwest corner of the Southeast Quarter (SE 1/4) of the Southwest Quarter (SW 1/4) of said Section Thirty-three (33); thence South 89° 46' 07" East 923.10' along the South line of said Section Thirty-three (33); thence North 00° 09' 16" West 200.00' to the point of beginning; thence North 89° 46' 07" West 600.00'; thence North 00° 09' 16" West 300.00'; thence South 89° 46' 07" East 261.79'; thence North 00° 09' 16" West 428.62'; thence South 64° 34' 00" West 424.05'; thence North 00° 02' 39" West 250.00' to a point in the centerline of a township road known as Coon Hollow Road; thence 181.94' on the arc of a curve to the left having a radius of 1153.77' and a long chord bearing North 48° 19' 50" East 181.76' along said centerline; thence North 43° 48' 46" East 22.40' along said centerline; thence South 89° 50' 28" East 625.00'; thence South 11° 14' 32" West 280.71'; thence South 00° 09' 16" East 657.82' to the point of beginning, being subject to any and all easements of record and/or usage.

## SURVEYOR'S CERTIFICATE:

I, Larry L. Austin, Registered Wisconsin Land Surveyor, hereby certify:  
That the above description was surveyed, mapped and monumented as shown on this plat by me or under my direct supervision.  
That conformance with local ordinances are not guaranteed with this survey.  
That this survey was prepared under the instructions of STEVE LENZ.  
That to the best of my knowledge and belief, this plat is an accurate representation thereof.  
That all plans that do not show a seal imprint in red ink may contain unauthorized alterations.  
The certification contained on this document shall not apply to any copies.

Dated this 26th day of April 2006.

Larry L. Austin, S-1903

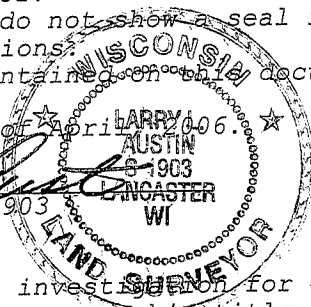

## SURVEYOR'S NOTES:

Surveyor has made no investigation for easements of record, encumbrances, restrictive covenants, ownership title evidence except as specifically shown on this plat. No distance should be assumed by scaling. No improvements have been located unless shown and noted. No representation as to ownership, use or possession should be hereon implied. Refer to abstract, title or local ordinances for any additional restriction, easements or building setback lines. No abstract, nor title commitment, nor results of title searches were furnished the surveyor. There may exist documents of record which would affect this parcel.



Austin  
Engineering LLC

4211 HWY 81 E, LANCASTER, WI 53813  
PHONE 608-723-6363 FAX 608-723-6702

Prepared For: STEVE LENZ

JOB NO: 06S066  
FIELDBOOK: TDS RANGER  
G:\T5NR2W\32  
H:\PLAT\T5NR2W\33\06S066-LENZ

DRAWN BY: SW AUSTIN  
APPROVED: LL AUSTIN  
CREW: BS - SA - BD

SHEET 2 OF 2

# PLAT OF SURVEY

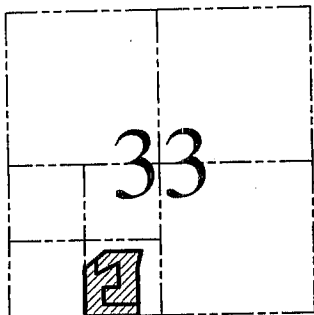
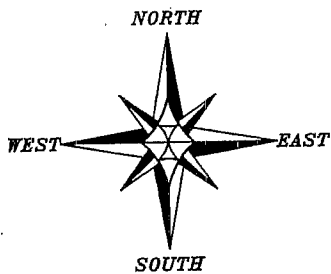

## LEGEND

- ⊕ No. 8 rebar found with Grant County Aluminum Cap
- No. 6 rebar found
- No. 6 x 24" rebar set with cap - wt=1.50 #/l.f.
- Aluminum Monument found with Grant County Aluminum Cap
- + No monument set
- ⊗ Existing utility pole
- x- Approximate location of fence
- E- Existing overhead utilities

Bearings referenced to the South line of the SW 1/4 of Section 33, which is assumed to bear South 89° 46' 07" East.

## LINE TABLE

LINE	BEARING	DISTANCE
L1	N 58°15'06" E	149.98'
L2	N 43°48'46" E	53.88'

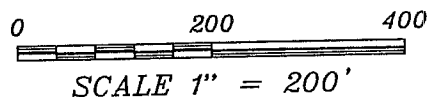

C1  
L=108.81'  
R=1153.77'  
C LEN=108.77'  
BRG=S 55°33'00" W

C2  
L=181.94'  
R=1153.77'  
C LEN=181.76'  
BRG=N 48°19'50" E

C3  
L=87.15'  
R=1186.77'  
C LEN=87.13'  
BRG=S 56°08'52" W

C4  
L=211.92'  
R=1186.77'  
C LEN=211.64'  
BRG=S 48°55'42" W

S 58°15'06" W  
129.60'

1.02 ACRE± SURVEY BY LARRY AUSTIN DATED 5-1-02

LOT 1, CSM #727, PAGE 17, DOC 625064

N 43°48'46" E  
22.40'

S 89°50'28" E 625.00'

579.39'

N 00°02'39" W 250.00'

S 64°34'00" W 424.05'

N 00°09'16" W

428.62'

**TRACT 2**  
11.39 ACRES±  
496,148 S.F.±  
(11.21 AC± EXCL ROW)

**TRACT 3**  
11.57 ACRES±  
503,989 S.F.±  
(11.39 AC± EXCL ROW)

S 89°46'07" E  
261.79'

N 00°09'16" W  
300.00'

PROPOSED HOUSE

PROPOSED SEPTIC

POB TRACT 3

N 89°46'07" W 600.00'

N 00°09'16" W  
200.00'

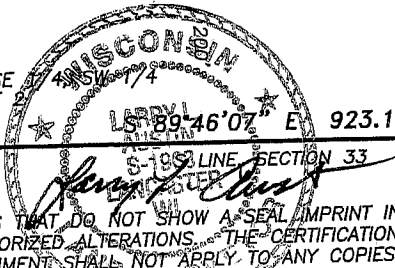

ALL PLANS THAT DO NOT SHOW A SEAL IMPRINT IN RED INK MAY CONTAIN UNAUTHORIZED ALTERATIONS. THE CERTIFICATION CONTAINED ON THIS DOCUMENT SHALL NOT APPLY TO ANY COPIES. DATED: 4-26-06

SOUTH 1/4 CORNER SECTION 33, T5N R2W

SOUTHWEST CORNER SECTION 33, T5N R2W



**Austin Engineering LLC**

4211 HWY 81 E, LANCASTER, WI 53813  
PHONE 608-723-6363 FAX 608-723-6702

Prepared For: **STEVE LENZ**

JOB NO: 06S066  
FIELDBOOK: TDS RANGER  
G:\T5NR2W\32  
H:\PLAT\T5NR2W\33\06S066-LENZ

DRAWN BY: SW AUSTIN  
APPROVED: LL AUSTIN  
CREW: BS - SA - BD

SHEET 1 OF 2

# PLAT OF SURVEY

## TRACT 2 DESCRIPTION:

Part of the Southeast Quarter (SE 1/4) of the Southwest Quarter (SW 1/4) of Section Thirty-three (33), Town Five (5) North, Range Two (2) West of the 4th p.m., Liberty Township, Grant County, Wisconsin, containing 11.39 acres, more or less and being described as follows:  
Commencing at the Southwest corner of said Section Thirty-three (33), thence South 89° 46' 07" East 1323.11' along the South line of said Section to the Southwest corner of the Southeast Quarter (SE 1/4) of the Southwest Quarter (SW 1/4) of said Section Thirty-three (33) being the point of beginning; thence South 89° 46' 07" East 923.10' along the South line of said Section Thirty-three (33); thence North 00° 09' 16" West 200.00'; thence North 89° 46' 07" West 600.00'; thence North 00° 09' 16" West 300.00'; thence South 89° 46' 07" East 261.79'; thence North 00° 09' 16" West 428.62'; thence South 64° 34' 00" West 424.05'; thence North 00° 02' 39" West 250.00' to a point in the centerline of a township road known as Coon Hollow Road; thence 108.81' on the arc of a curve to the right having a radius of 1153.77' and a long chord bearing South 55° 33' 00" West 108.77' along said centerline; thence South 58° 15' 06" West 129.60' along said centerline to a point on the West line of the Southeast Quarter (SE 1/4) of the Southwest Quarter (SW 1/4) of said Section Thirty-three (33); thence South 00° 02' 39" East 864.42' along said West line to the point of beginning, being subject to any and all easements of record and/or usage.

## TRACT 3 DESCRIPTION:

Part of the Southeast Quarter (SE 1/4) of the Southwest Quarter (SW 1/4) of Section Thirty-three (33), Town Five (5) North, Range Two (2) West of the 4th p.m., Liberty Township, Grant County, Wisconsin, containing 11.57 acres, more or less and being described as follows:  
Commencing at the Southwest corner of said Section Thirty-three (33), thence South 89° 46' 07" East 1323.11' along the South line of said Section to the Southwest corner of the Southeast Quarter (SE 1/4) of the Southwest Quarter (SW 1/4) of said Section Thirty-three (33); thence South 89° 46' 07" East 923.10' along the South line of said Section Thirty-three (33); thence North 00° 09' 16" West 200.00' to the point of beginning; thence North 89° 46' 07" West 600.00'; thence North 00° 09' 16" West 300.00'; thence South 89° 46' 07" East 261.79'; thence North 00° 09' 16" West 428.62'; thence South 64° 34' 00" West 424.05'; thence North 00° 02' 39" West 250.00' to a point in the centerline of a township road known as Coon Hollow Road; thence 181.94' on the arc of a curve to the left having a radius of 1153.77' and a long chord bearing North 48° 19' 50" East 181.76' along said centerline; thence North 43° 48' 46" East 22.40' along said centerline; thence South 89° 50' 28" East 625.00'; thence South 11° 14' 32" West 280.71'; thence South 00° 09' 16" East 657.82' to the point of beginning, being subject to any and all easements of record and/or usage.

## SURVEYOR'S CERTIFICATE:

I, Larry L. Austin, Registered Wisconsin Land Surveyor, hereby certify:  
That the above description was surveyed, mapped and monumented as shown on this plat by me or under my direct supervision.  
That conformance with local ordinances are not guaranteed with this survey.  
That this survey was prepared under the instructions of STEVE LENZ.  
That to the best of my knowledge and belief, this plat is an accurate representation thereof.  
That all plans that do not show a seal imprint in red ink may contain unauthorized alterations.  
The certification contained on this document shall not apply to any copies.

Dated this 26th day of April, 2006.

Larry L. Austin, S-1903

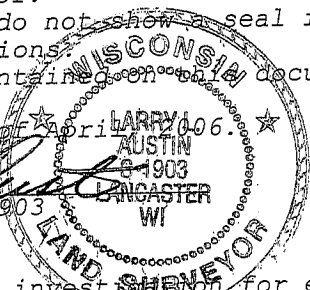

## SURVEYOR'S NOTES:

Surveyor has made no investigation for easements of record, encumbrances, restrictive covenants, ownership title evidence except as specifically shown on this plat. No distance should be assumed by scaling. No improvements have been located unless shown and noted. No representation as to ownership, use or possession should be hereon implied. Refer to abstract, title or local ordinances for any additional restriction, easements or building setback lines. No abstract, nor title commitment, nor results of title searches were furnished the surveyor. There may exist documents of record which would affect this parcel.



Austin  
Engineering LLC

4211 HWY 81 E, LANCASTER, WI 53813  
PHONE 608-723-6363 FAX 608-723-6702

Prepared For: STEVE LENZ

JOB NO: 06S066  
FIELDBOOK: TDS RANGER  
G:\T5NR2W\32  
H:\PLAT\T5NR2W\33\06S066-LENZ

DRAWN BY: SW AUSTIN  
APPROVED: LL AUSTIN  
CREW: BS - SA - BD

SHEET 2 OF 2