

PLAT OF SURVEY

JOB #2005-19
FORMERLY 2004-27
CREW ML SS

FOR: GREG (BUCK) HOLMES

3/6 BILL HOLMAN N 1/4 CORNER 19, T7N, R1W
RESET FOUND 1-1/4 IRON
ROD USING FOUND TIES.
A SURVEY OF THE LINES SHOWN HEREON
OF SECTION 19, T7N, R1W, CASTLE ROCK
TOWNSHIP, GRANT COUNTY, WISCONSIN.

S 89°25'25" E

2626.22'

1313.11'

5267.83'

2630.67'

2632.02'

NE CORNER 19, T7N, R1W
SET 1" X 30" IRON ROD WITH
COUNTY ALUMINUM CAP.

2629.45'

SE 1/4 - NW 1/4

FENNIMORE CREEK
SW 1/4 - NE 1/4

W 1/4 CORNER 19, T7N, R1W
FOUND POINTED STONE MON.

1177.21' 121.44' 200.00' 300.00' 151.87' 199.68' 1328.29' 355.30'

N 89°21'25" W

SW CORNER OF THE SE 1/4
OF THE NW 1/4 8' SOUTH OF FENCE

174.88' 188.03' 240.86' 113.74' 185.24' 51.01' 202.35'

1294.20

100.00' 157.37' 98.38' 100.00'

N 00°04'51" W

S 00°19'52" W

E 1/4 CORNER 19, T7N, R1W
FOUND 1-1/4" IRON ROD

N

BEARINGS ARE REFERENCED TO THE NORTH LINE
OF THE NE 1/4 OF SECTION 19, T7N, R1W WHICH
COMPUTES TO BEAR. AS SHOWN IN THE GRANT
COUNTY COORDINATE SYSTEM.

ORIGINAL DRAWING
SCALE

1" = 500'



LEGEND:

- 1" IRON PIPE SET
- POLE BARN SPIKE AND FLAG SET
- X- FENCE
- () RECORDED AS

SURVEYOR'S CERTIFICATE

I HEREBY CERTIFY THAT I HAVE MADE A SURVEY
ACCORDING TO THE DESCRIPTION AND/OR INSTRUCTIONS
FURNISHED ME AND THAT THE PLAT DRAWN HEREON IS A
CORRECT REPRESENTATION OF THAT SURVEY TO THE
BEST OF MY KNOWLEDGE AND BELIEF.

Michael R. LaRosa 1/19/2006
MICHAEL R. LaROSA S-2259 DATE

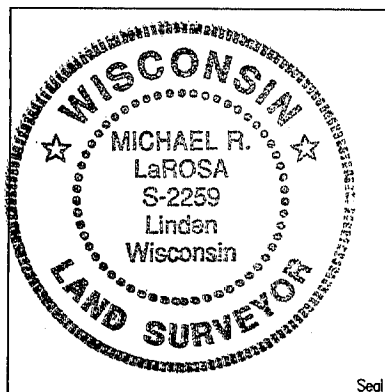

N 00°29'35" W

2638.38'

S 1/4 CORNER 19, T7N, R1W
FOUND DRIVABLE ALUMINUM MON.

M. R. LaROSA TECHNICAL SERVICES

P.O. BOX 383 (263 E. MAIN ST.)

LINDEN, WISCONSIN 53553

TEL 608-623-3000